

Amphenol
ANYTEK

MOS Relay
APR Series

DIP Type

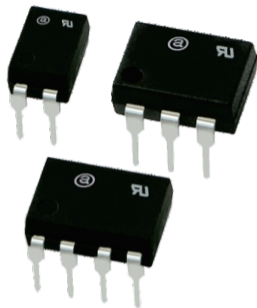
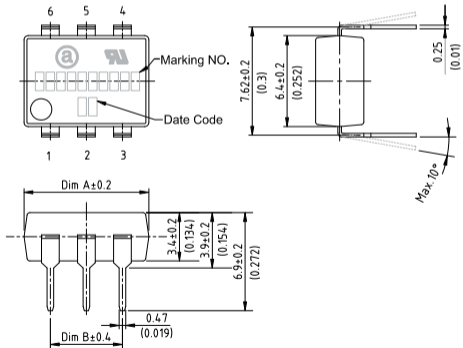

Mount Type: DIP Type

Load Type: AC&DC

Contact Type: 1 form A, 1 form B, 2 form A

Load Voltage: 60V, 600V, 1500V

PIN OUT: 4 PIN, 6 PIN, 8 PIN

Color: Black

Package: IC tube

Safety Approval: 

SMD Type

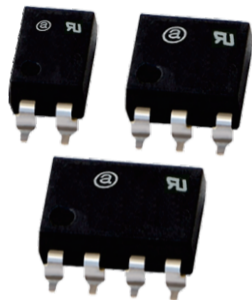
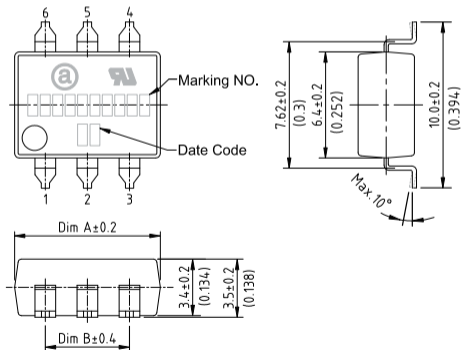

Mount Type: SMD Type
Load Type: AC&DC
Contact Type: 1 form A, 1 form B
Load Voltage: 60V, 350V, 400V
PIN OUT: 4 PIN, 6 PIN, 8 PIN
Color: Black
Package: IC tube
Safety Approval: 

SOP Type

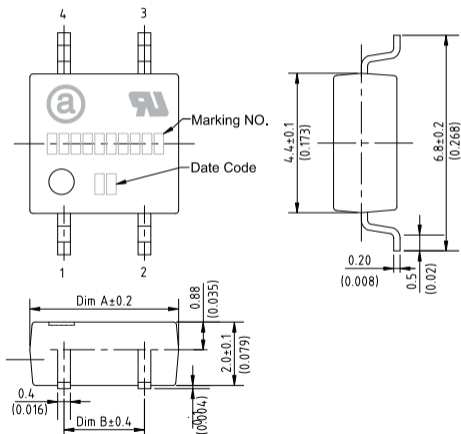

Mount Type: SOP Type
Load Type: AC&DC
Contact Type: 1 form A
Load Voltage: 60V, 350V, 400V
PIN OUT: 4 PIN
Color: Black
Package: IC tube
Safety Approval: 

MOS Relay

FEATURES

- No EMI/RFI generation
- High reliability
- No moving parts
- Low drive power requirement (TTL/CMOS compatible)
- Low On-state resistance
- High isolation voltage
- Arc-free with no snubbing circuits
- Machine insertable or wave solderable

APPLICATIONS

- Telecommunications
- Instrumentation
- Medical equipment
- Security
- Industrial control

APR

X X XX XX X X XX E X
Mount Type Load Type Contact Type Load Voltage PIN OUT Package Special Number

XXX
Special Code

2:DIP
3:SMD
4:SOP

0:DC
1:AC&DC

1A:1 form A
1B:1 form B
1C:1 form A
1 form B
2A:2 form A
2B:2 form B

02:20V
03:30V
06:60V
08:80V
20:200V
25:250V
35:350V
40:400V
60:600V

4:4PIN
6:6PIN
8:8PIN

0:IC tube
1:Tape reel

E: Standard

NIL:Standard
L:Current limit

00G:Standard
XXG:Special

2:DIP
3:SMD

0:DC
1:AC&DC

1A:1 form A

F0:1500V

6:6PIN

ANYTEK®

Anytek Electronic Technology (SZ) Co., Ltd.
恩尼特克电子科技(深圳)有限公司

Web Site:<https://www.anytek.com.cn>
<http://www.anytek.com.tw>