

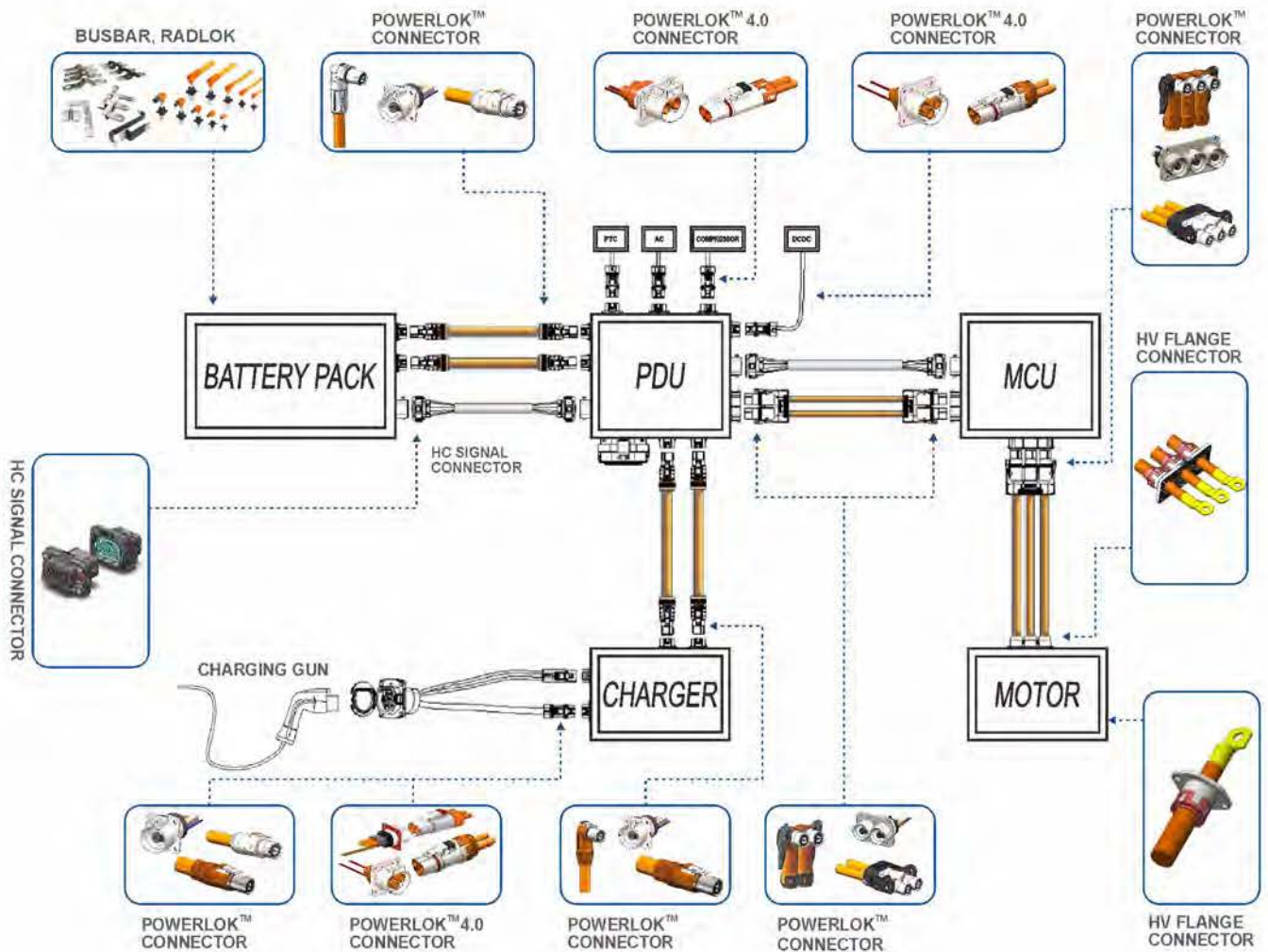

PowerLok™ Connector

SYSTEM CONNECTION SKETCH



■ PowerLok™ Connector

PowerLok™ series is a low cost, compact, metal-shell interconnect solution utilizing RADSOK® contact technology for EV and Hybrid transportation applications. Up to 1000V ranging from 70A-500A with HVIL, 360° shielding, environmental sealing, keying, straight and right angle configurations, and up to 3 power circuits. Accommodates cable sizes from 16mm² to 150mm² with and without shielding. Available in assembled and overmolded versions.

Application

PowerLok™ series connectors are engineered for diverse applications as its wide power range coverage, including electric powertrains of automotive, trucks, bus, agricultural and construction machines, and off-road vehicles. Furthermore, PowerLok™ series are also widely employed in stationary energy storage systems.

Key Features

- High Voltage Inter Lock
- 360° shielding
- 1POS, 2POS, 3POS Positions Available
- 90D and 180D plug available
- Multiple keys available
 - 1POS (X, Y, U, V, W, T keys)
 - 2POS & 3POS (X, Y keys)
- RADSOK® contact technology
- RoHS/REACH Compliant
- Mating Cycle: 100Minimum
- Mating Force: 75N MAX.
- Voltage Rating: 1000VDC
- DC Current Rating: 120A, 200A, 300A, 400A, 500A
- Insulation Resistance: 500 MΩ
- IP rating: IP 67 (mated)
- Salt Spray: 48h
- Temperature range: -40°C - +125°C

PowerLok™ Recommended Cable Size & Current Rating

Series	Accepted Cable Size	Current Rating
120 Series	16mm ²	90A
	25mm ²	120A
200 Series	25mm ²	120A
	35mm ²	150A
300 Series	50mm ²	200A
	35mm ²	150A
	50mm ²	200A
400 Series	70mm ²	250A
	95mm ²	300A
	70mm ²	250A
	95mm ²	300A
500 Series	120mm ²	400A
	135mm ²	450A
	95mm ²	300A
	120mm ²	400A
	135mm ²	450A
	150mm ²	500A

*If the above does not meet the size you need, you can contact us, we will customize the product according to your needs.

PowerLok™ Receptacle



180 Degree Busbar Lug



Thread Pin



Tubular Lug



90 Degree Busbar Lug

Series	180 Degree BusBar Lug						Thread Pin						Tubular Lug						90 Degree Busbar Lug	
	1POS		2POS		3POS		1POS		2POS		3POS		1POS		2POS		3POS		1POS	
	With HVIL	W/O HVIL	With HVIL	W/O HVIL	With HVIL	W/O HVIL	With HVIL	W/O HVIL	With HVIL	W/O HVIL	With HVIL	W/O HVIL	With HVIL	W/O HVIL	With HVIL	W/O HVIL	With HVIL	W/O HVIL	With HVIL	W/O HVIL
120A	*	*	*	*	*	*	*	*	*	*	*	*	*	*	*	*	*	*	*	*
200A	*	*	*	*	*	*	*	*	*	*	*	*	*	*	*	*	*	*	*	*
300A	*	*	*	*	*	*	*	*	*	*	*	*	*	*	*	*	*	*	*	*
400A	*	*	*	*	*	*	*	*	*	*	*	*	*	*	*	*	*	*	*	*
500A	*	*	*	*	*	*	*	*	*	*	*	*	*	*	*	*	*	*	*	*

180 Degree Busbar Lug Receptacle

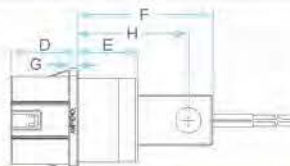
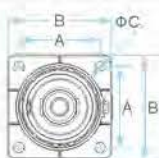
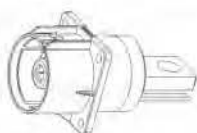

Product	180 Degree Busbar Lug 1POS Dimensions(mm)								
	Series	A	B	C	D	E	F	G	H
PowerLok™ 1POS 180 Degree Busbar Lug Receptacle	120A	20.0	28.0	Φ3.6	18.0	13.0	31.5	3.0	24.5
	200A	25.0	33.0	Φ4.2	20.7	19.3	39.5	3.0	32.3
	300A	27.0	35.0	Φ4.2	20.7	21.3	49.3	3.0	39.3
	400A	33.5	43.0	Φ4.3	27.2	25.0	55.2	3.5	45.2
	500A	33.5	43.0	Φ4.3	27.2	25.0	56.0	3.5	46.0

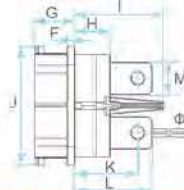
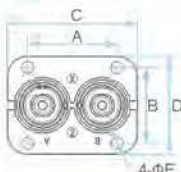
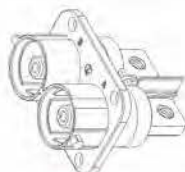

Product	180 Degree Busbar Lug 2POS Dimensions(mm)													
	Series	A	B	C	D	E	F	G	H	I	J	K	L	M
PowerLok™ 2POS 180 Degree Busbar Lug Receptacle	120A	35.0	25.5	48.0	34.0	Φ3.6	3.0	18.5	14.5	29.5	49.0	23.5	33.0	9.8
	300A	45.0	38.0	65.6	49.6	Φ6.2	4.0	22.0	20.0	49.0	65.4	35.0	43.0	18.2

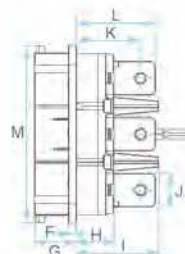
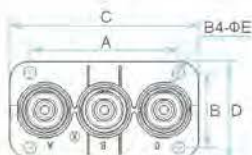
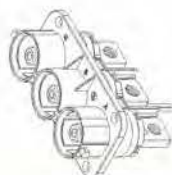

Product	180 Degree Busbar Lug 3POS Dimensions(mm)													
	Series	A	B	C	D	E	F	G	H	I	J	K	L	M
PowerLok™ 3POS 180 Degree Busbar Lug Receptacle	300A	75.0	38.0	95.6	49.6	Φ10.0	4.0	22.0	20.7+1.0	44.7+0.1	18.2	35.0+0.1	43.0+0.1	95.6

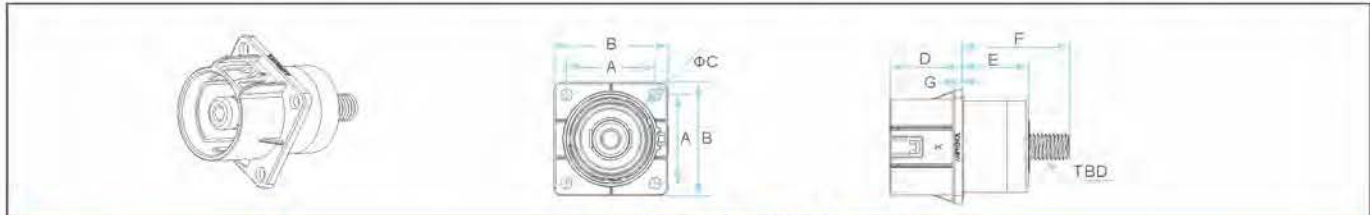

Product	Thread Pin 1POS Dimensions(mm)							
	Series	A	B	C	D	E	F	G
PowerLok™ 1POS Thread Pin Receptacle	120A	20.0	28.0	φ3.6	18.0	13.0	32.0	3.0
	300A	27.0	35.0	φ4.2	20.7	21.3	38.1	3.0
	500A	33.5	43.0	φ4.3	27.2	25.0	40.5	3.5

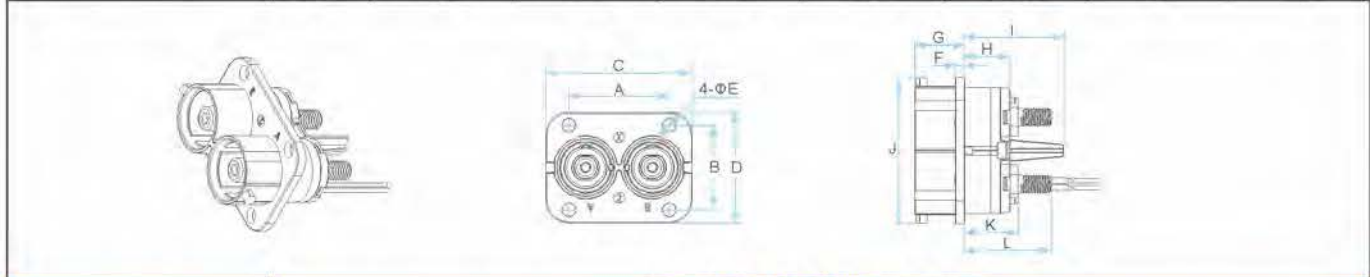

Product	Thread Pin 2POS Dimensions(mm)												
	Series	A	B	C	D	E	F	G	H	I	J	K	L
PowerLok™ 2POS Thread Pin Receptacle	300A	45.0	38.0	65.6	49.6	φ6.2	4.0	22.0	20.7±0.1	44.7±0.1	65.4	24.2±0.1	39.2±0.1

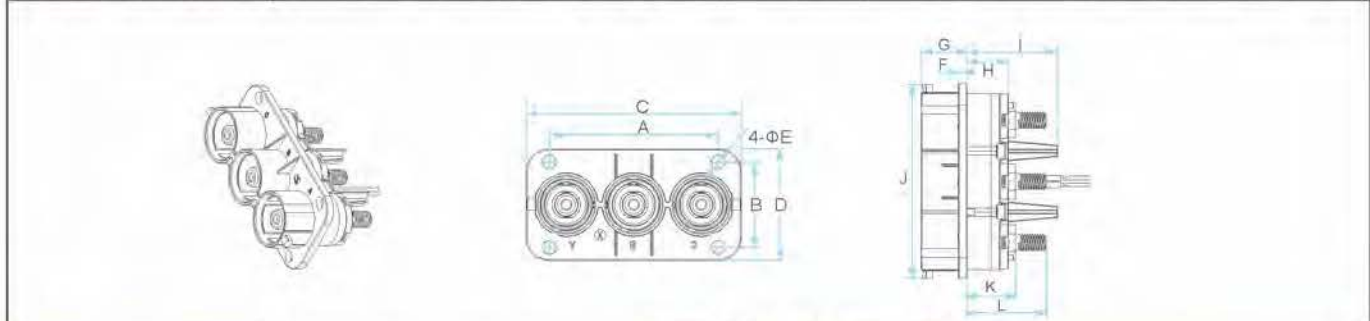

Product	Thread Pin 3POS Dimensions(mm)												
	Series	A	B	C	D	E	F	G	H	I	J	K	L
PowerLok™ 3POS Thread Pin Receptacle	300A	75.0	38.0	95.6	49.6	φ6.2	4.0	22.0	20.7±0.1	44.7±0.1	95.1	24.2±0.1	39.2±0.1

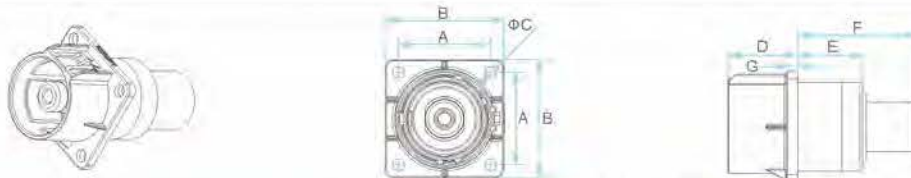

Product	Tubular Lug 1POS Dimensions(mm)							
	Series	A	B	C	D	E	F	G
PowerLok™ 1POS Tubular Lug Receptacle	120A	20.0	28.0	φ3.6	18.0	13.0	27.5	3.0
	300A	27.0	35.0	φ4.2	20.7	21.3	TBD	3.0
	500A	33.5	43.0	φ4.3	27.2	25.0	46.5	4.5

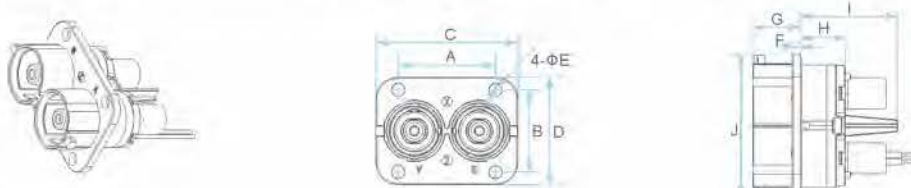

Product	Tubular Lug 2POS Dimensions(mm)										
	Series	A	B	C	D	E	F	G	H	I	J
PowerLok™ 2POS Tubular Lug Receptacle	300A	45.0	38.0	65.6	49.6	φ6.2	4.0	22.0	20.7	44.7	65.4

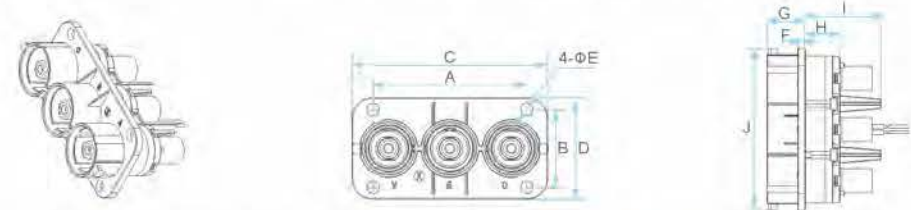

Product	Tubular Lug 3POS Dimensions(mm)										
	Series	A	B	C	D	E	F	G	H	I	J
PowerLok™ 3POS Tubular Lug Receptacle	300A	75.0	38.0	95.6	49.6	φ6.2	4.0	22.0	20.7	44.7	95.1

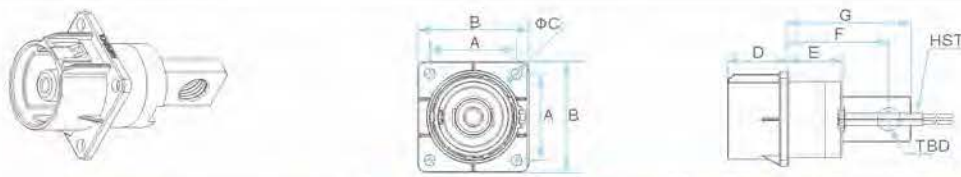

Product	90 Degree Busbar 1POS Dimensions(mm)								
	Series	A	B	C	D	E	F	G	H
PowerLok™ 1POS 90 Degree Busbar Receptacle	300A	27.0	35.0	φ4.2	20.7	24.1	49.3	3.0	39.3
	400A	33.5	43.0	φ4.3	27.2	25.0	55.2	3.5	45.2
	500A	33.5	43.0	φ4.3	20.7	25.0	56.0	3.5	46.0

PowerLok™ Plug

Series	1POS				2POS				3POS			
	Assembly		Overmolded		Assembly		Overmolded		Assembly		Overmolded	
	Straight	Right Angle	Straight	Right Angle	Straight	Right Angle	Straight	Right Angle	Straight	Right Angle	Straight	Right Angle
120A			*	*			*	*				
200A	*	*	*	*								
300A	*	*	*	*	*	*			*	*		
400A			*	*								
500A			*	*								

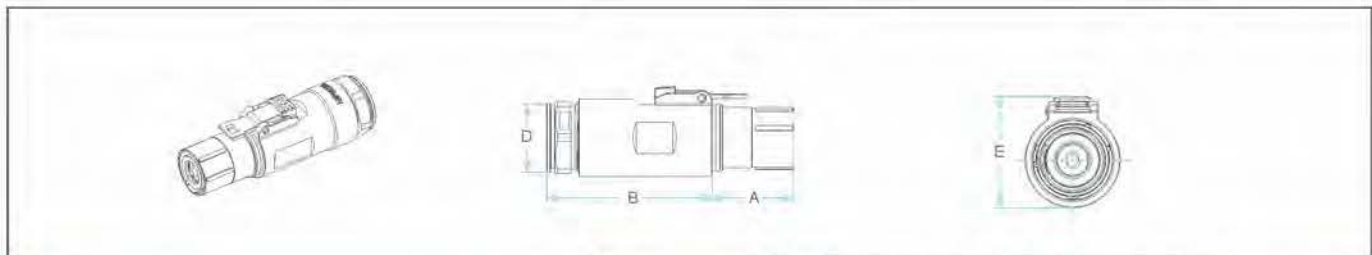
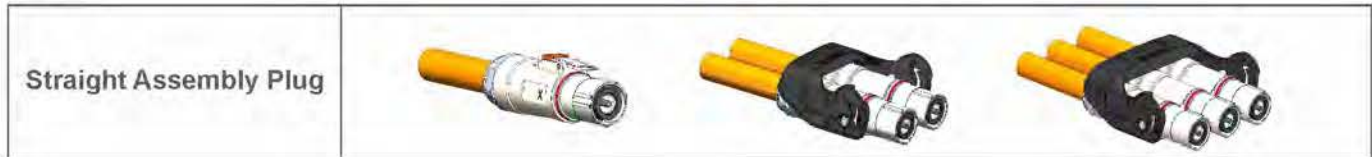

Product	1POS Straight Assembly Plug Dimensions(mm)				
	Series	A	B	D	E(REF)
PowerLok™ 1POS Straight Assembly Plug	200A	29.8	54.3	Φ25.9	30.9
	300A	31.0	63.1	Φ29.5	34.4



Product	2POS Straight Assembly Plug Dimensions(mm)				
	Series	A	B	C	D
PowerLok™ 2POS Straight Assembly Plug	300A	70.5	38.8	31.0	59.6

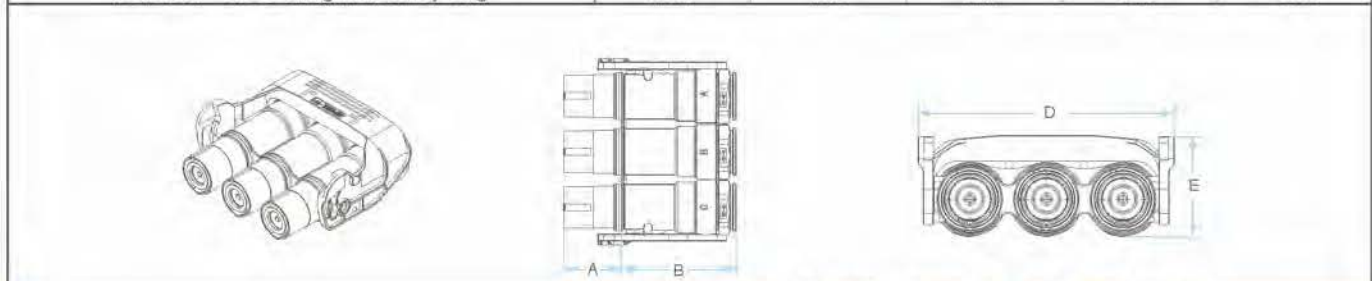

Product	3POS Straight Assembly Plug Dimensions(mm)				
	Series	A	B	D	E
PowerLok™ 3POS Straight Assembly Plug	300A	31.0	59.6	100.5	38.0

Right Angle Assembly Plug

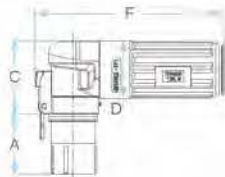
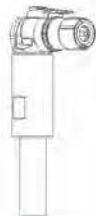

Product

1POS Right Angle Assembly Plug Dimensions(mm)

Product	Series	A	C	D	F(REF)	W
PowerLok™ 1POS Right Angle Assembly Plug	200A	29.8	34.7	Φ25.9	30.9	68.8
	300A	31.0	37.6	Φ29.5	34.4	78.1

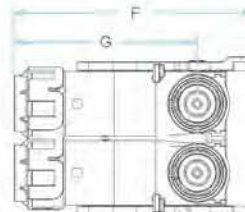
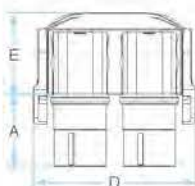
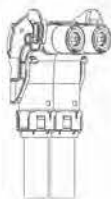

Product

2POS Right Angle Assembly Plug Dimensions(mm)

Product	Series	A	D	E	F	G
PowerLok™ 2POS Right Angle Assembly Plug	300A	31.0	70.5	34.8	103.3	79.4

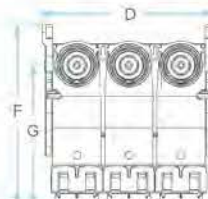
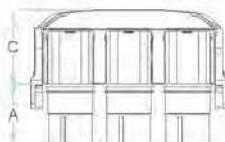
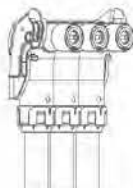

Product

3POS Right Angle Assembly Plug Dimensions(mm)

Product	Series	A	C	D	F	G
PowerLok™ 3POS Right Angle Assembly Plug	300A	31.0	38.0	100.5	103.3	79.4

Note

Amphenol TPI can provide customized solutions based on customer's installation space. If you need to order or ask questions, please contact your sales representative for additional information!

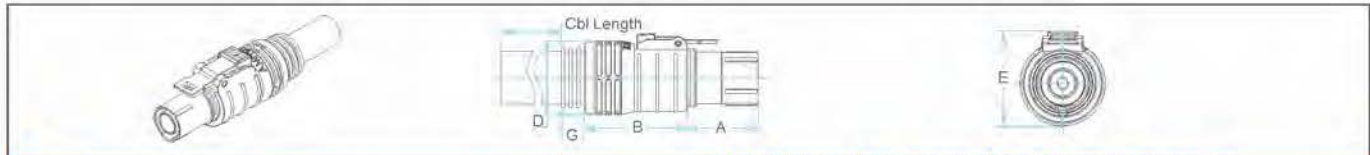

Product	1POS Straight Overmolded Plug Dimensions(mm)					
	Series	A	B	D	E	G
PowerLok™ 1POS Straight Overmolded Plug	120A	22.5	39.0	Φ24.6	28.5	9.9
	300A	31.0	45.0	Φ32.0	35.6	9.9
	400A	41.1	52.0	Φ42.0	43.6	9.9
	500A	41.1	52.0	Φ42.0	43.6	9.9

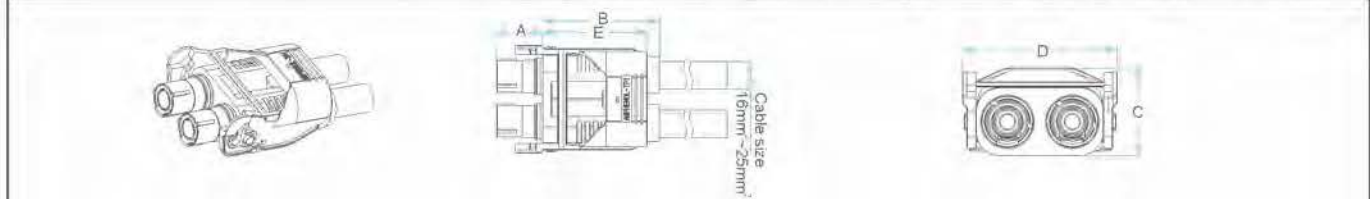

Product	2POS Straight Overmolded Plug Dimensions(mm)					
	Series	A	B	C	D	E
PowerLok™ 2POS Straight Overmolded Plug	120A	22.5	57.0	29.7	52.5	51.0

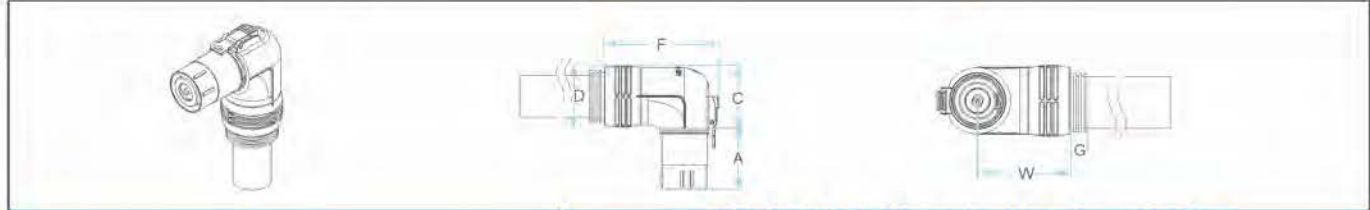

Product	1POS Right Angle Overmolded Plug Dimensions(mm)						
	Series	A	C	D	F(PEF)	W	G
PowerLok™ 1POS Right Angle Overmolded Plug	120A	22.5	25.3	Φ24.6	55.8	40.0	9.9
	300A	31.0	32.5	Φ32.0	69.6	50.0	9.9
	400A	41.1	43.0	Φ42.0	78.6	55.0	9.9
	500A	41.1	43.0	Φ42.0	78.6	55.0	9.9



Product	2POS Right Angle Overmolded Plug Dimensions(mm)					
	Series	A	B	C	D	E
PowerLok™ 2POS Right Angle Overmolded Plug	120A	22.5	31.2	70.0	52.5	53.0

PowerLok™ Connector Key Map

1POS-120A

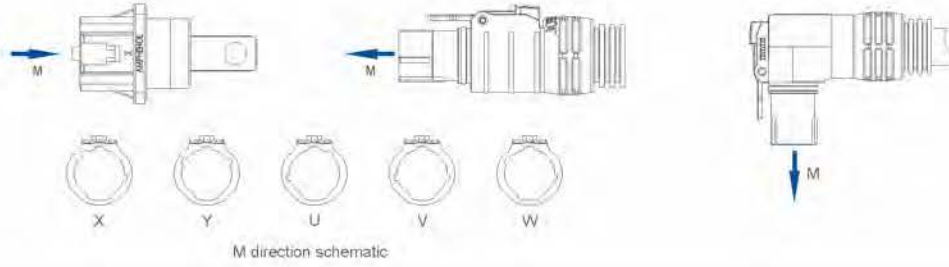

1POS-200A

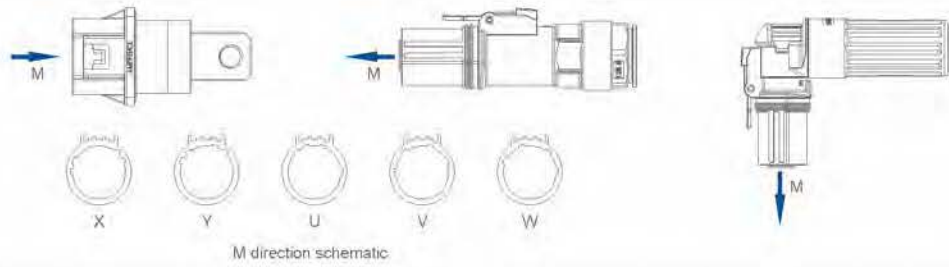

1POS-300A

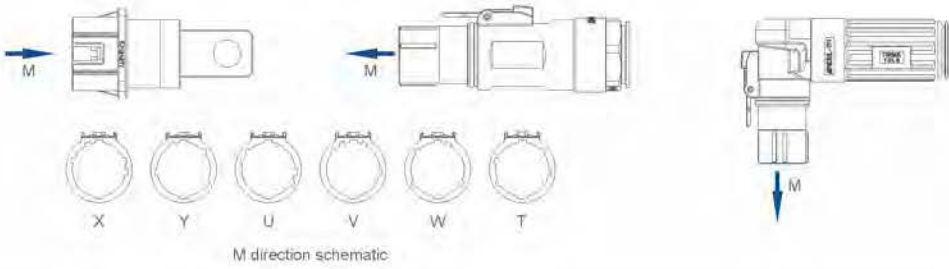

1POS-400A

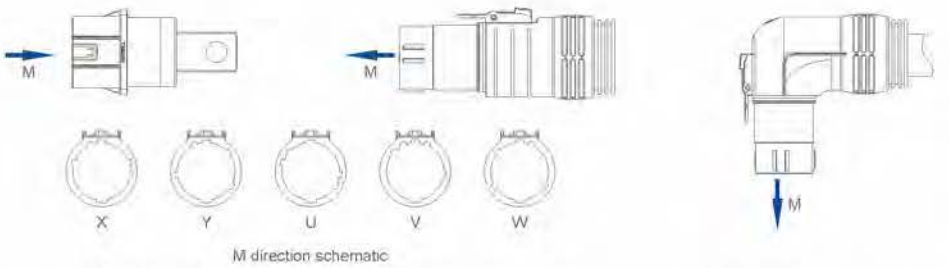

1POS-500A

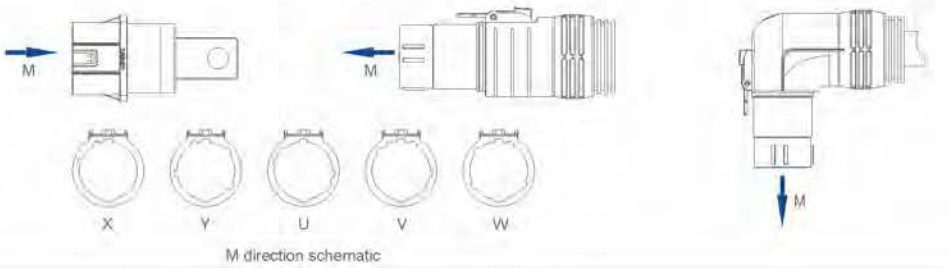

2POS-120A

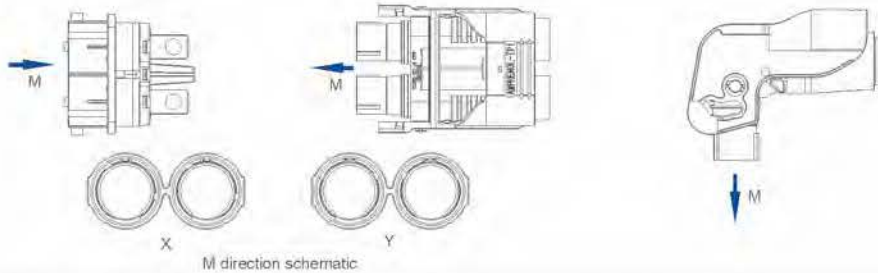

2POS-300A

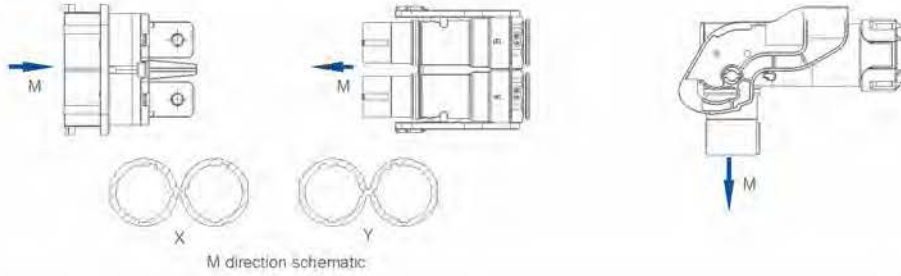

3POS-300A

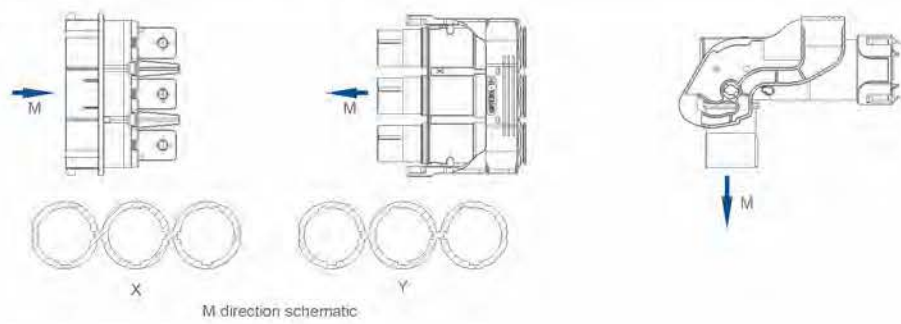

Ordering Information-PowerLok™ 1POS Receptacle W/O HVIL (90 Degree Busbar Lug)

Product Type	Connector Type	Key (Touch Proof Cover Color)	Current & HVIL	Termination Type	Termination Size		
PowerLok™	00	1POS Receptacle	X - 300 - 90	90	90 Degree		
			Orange			300	300A W/O HVIL
			Black			400	400A W/O HVIL
			Yellow			500	500A W/O HVIL
			Green				
Red							
					M+Stud Size		

Continued W/O HVIL

Series Key	90D Busbar Lug+(D+Stud Size)			90D Busbar Lug+(M+Stud Size)		
	Termination	Description	Part Number	Termination	Description	Part Number
300A	D6	PL00X-300-90D6	AC-HA004032	M6	PL00X-300-90M6	AC-HA004050
		PL00Y-300-90D6	AC-HA004033		PL00Y-300-90M6	AC-HA004051
		PL00U-300-90D6	AC-HA004034		PL00U-300-90M6	AC-HA004052
		PL00V-300-90D6	AC-HA004035		PL00V-300-90M6	AC-HA004053
		PL00W-300-90D6	AC-HA004036		PL00W-300-90M6	AC-HA004054
		PL00T-300-90D6	AC-HA004037		PL00T-300-90M6	AC-HA004055
	D8	PL00X-300-90D8	AC-HA004026	M8	PL00X-300-90M8	AC-HA004044
		PL00Y-300-90D8	AC-HA004027		PL00Y-300-90M8	AC-HA004045
		PL00U-300-90D8	AC-HA004028		PL00U-300-90M8	AC-HA004046
		PL00V-300-90D8	AC-HA004029		PL00V-300-90M8	AC-HA004047
		PL00W-300-90D8	AC-HA004030		PL00W-300-90M8	AC-HA004048
		PL00T-300-90D8	AC-HA004031		PL00T-300-90M8	AC-HA004049
D10	PL00X-300-90D10	AC-HA004020	M10	PL00X-300-90M10	AC-HA004038	
	PL00Y-300-90D10	AC-HA004021		PL00Y-300-90M10	AC-HA004039	
	PL00U-300-90D10	AC-HA004022		PL00U-300-90M10	AC-HA004040	
	PL00V-300-90D10	AC-HA004023		PL00V-300-90M10	AC-HA004041	
	PL00W-300-90D10	AC-HA004024		PL00W-300-90M10	AC-HA004042	
	PL00T-300-90D10	AC-HA004025		PL00T-300-90M10	AC-HA004043	
400A	D8	PL00X-400-90D8	AC-HA002784	M8	PL00X-400-90M8	AC-HA002789
		PL00Y-400-90D8	AC-HA002785		PL00Y-400-90M8	AC-HA002790
		PL00U-400-90D8	AC-HA002786		PL00U-400-90M8	AC-HA002791
		PL00V-400-90D8	AC-HA002787		PL00V-400-90M8	AC-HA002792
		PL00W-400-90D8	AC-HA002788		PL00W-400-90M8	AC-HA002793
		PL00X-400-90D10	AC-HA002774		M10	PL00X-400-90M10
	PL00Y-400-90D10	AC-HA002775	PL00Y-400-90M10	AC-HA002780		
	PL00U-400-90D10	AC-HA002776	PL00U-400-90M10	AC-HA002781		
	PL00V-400-90D10	AC-HA002777	PL00V-400-90M10	AC-HA002782		
	PL00W-400-90D10	AC-HA002778	PL00W-400-90M10	AC-HA002783		
	PL00X-500-90D8	AC-HA007831	M8	PL00X-500-90M8		AC-HA007836
	PL00Y-500-90D8	AC-HA007832		PL00Y-500-90M8	AC-HA007837	
PL00U-500-90D8	AC-HA007833	PL00U-500-90M8		AC-HA007838		
PL00V-500-90D8	AC-HA007834	PL00V-500-90M8		AC-HA007839		
PL00W-500-90D8	AC-HA007835	PL00W-500-90M8		AC-HA007840		
PL00X-500-90D10	AC-HA007841	M10		PL00X-500-90M10	AC-HA007846	
PL00Y-500-90D10	AC-HA007842		PL00Y-500-90M10	AC-HA007847		
PL00U-500-90D10	AC-HA007843		PL00U-500-90M10	AC-HA007848		
PL00V-500-90D10	AC-HA007844		PL00V-500-90M10	AC-HA007849		
PL00W-500-90D10	AC-HA007845		PL00W-500-90M10	AC-HA007850		

Ordering Information-PowerLok™ 1POS Receptacle With HVIL

			PL	00	X	-	301	-	10	M10		
Product Type	Connector Type	Key (Touch Proof Cover Color)			Current & HVIL			Termination Type		Termination Size		
PowerLok™	00 1POS Receptacle	X	Orange	121	120A With HVIL	10	180 Degree Busbar Lug	D+Stud Size				
		Y	Black	201	200A With HVIL							
		U	Yellow	301	300A With HVIL							
		V	Green	401	400A With HVIL	90	90 Degree Busbar Lug	D+Stud Size				
		W	Red	501	500A With HVIL							
		T	Blue									

With HVIL

Series Key	Busbar Lug(D+Stud Size)			Busbar Lug(M+Stud Size)			90D Busbar Lug+(D+Stud Size)			90D Busbar Lug+(M+Stud Size)			
	Termination	Description	Part Number	Termination	Description	Part Number	Termination	Description	Part Number	Termination	Description	Part Number	
120A	X	PL00X-121-10D6	AC-HA000305	M6	PL00X-121-10M6	AC-HA000458	-	-	-	-	-	-	
	Y	PL00Y-121-10D6	AC-HA000306	M6	PL00Y-121-10M6	AC-HA000460	-	-	-	-	-	-	
	U	PL00U-121-10D6	AC-HA000307	M6	PL00U-121-10M6	AC-HA000461	-	-	-	-	-	-	
	V	PL00V-121-10D6	AC-HA000308	M6	PL00V-121-10M6	AC-HA000462	-	-	-	-	-	-	
200A	W	PL00W-121-10D6	AC-HA000309	M6	PL00W-121-10M6	AC-HA000463	-	-	-	-	-	-	
	X	-	-	M8	PL00X-201-10M8	AC-HA004320	-	-	-	-	-	-	
	Y	-	-	M8	PL00Y-201-10M8	AC-HA004321	-	-	-	-	-	-	
	U	-	-	M8	PL00U-201-10M8	AC-HA004322	-	-	-	-	-	-	
300A	V	-	-	M8	PL00V-201-10M8	AC-HA004323	-	-	-	-	-	-	
	W	-	-	M8	PL00W-201-10M8	AC-HA004324	-	-	-	-	-	-	
	X	PL00X-301-10D6	AC-HA003940	M6	PL00X-301-10M6	AC-HA003934	D6	PL00X-301-90D6	EX-HA000645	M6	PL00X-301-90M6	EX-HA000659	
	Y	PL00Y-301-10D6	AC-HA003941	M6	PL00Y-301-10M6	AC-HA003935	D6	PL00Y-301-90D6	EX-HA000646	M6	PL00Y-301-90M6	EX-HA000660	
	U	PL00U-301-10D6	AC-HA003942	M6	PL00U-301-10M6	AC-HA003936	D6	PL00U-301-90D6	EX-HA000647	M6	PL00U-301-90M6	EX-HA000661	
	V	PL00V-301-10D6	AC-HA003943	M6	PL00V-301-10M6	AC-HA003937	D6	PL00V-301-90D6	EX-HA000648	M6	PL00V-301-90M6	EX-HA000662	
	W	PL00W-301-10D6	AC-HA003944	M6	PL00W-301-10M6	AC-HA003938	D6	PL00W-301-90D6	EX-HA000649	M6	PL00W-301-90M6	EX-HA000663	
	T	PL00T-301-10D6	AC-HA003945	M6	PL00T-301-10M6	AC-HA003939	D6	PL00T-301-90D6	EX-HA000650	M6	PL00T-301-90M6	EX-HA000664	
	X	PL00X-301-10D8	AC-HA001088	M8	PL00X-301-10M8	AC-HA001976	D8	PL00X-301-90D8	EX-HA000639	M8	PL00X-301-90M8	EX-HA000162	
	Y	PL00Y-301-10D8	AC-HA001089	M8	PL00Y-301-10M8	AC-HA001977	D8	PL00Y-301-90D8	EX-HA000640	M8	PL00Y-301-90M8	EX-HA000161	
	U	PL00U-301-10D8	AC-HA001090	M8	PL00U-301-10M8	AC-HA001978	D8	PL00U-301-90D8	EX-HA000641	M8	PL00U-301-90M8	EX-HA000651	
	400A	V	PL00V-301-10D8	AC-HA001091	M8	PL00V-301-10M8	AC-HA001979	D8	PL00V-301-90D8	EX-HA000642	M8	PL00V-301-90M8	EX-HA000163
W		PL00W-301-10D8	AC-HA001092	M8	PL00W-301-10M8	AC-HA001980	D8	PL00W-301-90D8	EX-HA000643	M8	PL00W-301-90M8	EX-HA000160	
T		PL00T-301-10D8	AC-HA001388	M8	PL00T-301-10M8	AC-HA001981	D8	PL00T-301-90D8	EX-HA000644	M8	PL00T-301-90M8	EX-HA000652	
X		PL00X-301-10D10	AC-HA000454	M10	PL00X-301-10M10	AC-HA000900	D10	PL00X-301-90D10	EX-HA000834	M10	PL00X-301-90M10	EX-HA000653	
Y		PL00Y-301-10D10	AC-HA000455	M10	PL00Y-301-10M10	AC-HA000901	D10	PL00Y-301-90D10	EX-HA000833	M10	PL00Y-301-90M10	EX-HA000654	
U		PL00U-301-10D10	AC-HA000456	M10	PL00U-301-10M10	AC-HA000902	D10	PL00U-301-90D10	EX-HA000835	M10	PL00U-301-90M10	EX-HA000655	
V		PL00V-301-10D10	AC-HA000457	M10	PL00V-301-10M10	AC-HA000903	D10	PL00V-301-90D10	EX-HA000836	M10	PL00V-301-90M10	EX-HA000656	
W		PL00W-301-10D10	AC-HA000458	M10	PL00W-301-10M10	AC-HA000904	D10	PL00W-301-90D10	EX-HA000837	M10	PL00W-301-90M10	EX-HA000657	
T		PL00T-301-10D10	AC-HA001382	M10	PL00T-301-10M10	AC-HA001383	D10	PL00T-301-90D10	EX-HA000838	M10	PL00T-301-90M10	EX-HA000658	
X		PL00X-401-10D8	AC-HA002741	M8	PL00X-401-10M8	AC-HA002751	-	-	-	-	-	-	
500A		Y	PL00Y-401-10D8	AC-HA002742	M8	PL00Y-401-10M8	AC-HA002752	-	-	-	-	-	-
		U	PL00U-401-10D8	AC-HA002743	M8	PL00U-401-10M8	AC-HA002753	-	-	-	-	-	-
	V	PL00V-401-10D8	AC-HA002744	M8	PL00V-401-10M8	AC-HA002754	-	-	-	-	-	-	
	W	PL00W-401-10D8	AC-HA002745	M8	PL00W-401-10M8	AC-HA002755	-	-	-	-	-	-	
	X	PL00X-401-10D10	AC-HA002731	M10	PL00X-401-10M10	AC-HA002721	-	-	-	-	-	-	
	Y	PL00Y-401-10D10	AC-HA002732	M10	PL00Y-401-10M10	AC-HA002722	-	-	-	-	-	-	
	U	PL00U-401-10D10	AC-HA002733	M10	PL00U-401-10M10	AC-HA002723	-	-	-	-	-	-	
	V	PL00V-401-10D10	AC-HA002734	M10	PL00V-401-10M10	AC-HA002724	-	-	-	-	-	-	
	W	PL00W-401-10D10	AC-HA002735	M10	PL00W-401-10M10	AC-HA002725	-	-	-	-	-	-	
	X	PL00X-501-10D8	AC-HA000568	M8	PL00X-501-10M8	AC-HA002460	D8	PL00X-501-90D8	EX-HA000793	M8	PL00X-501-90M8	EX-HA000796	
	500A	Y	PL00Y-501-10D8	AC-HA000569	M8	PL00Y-501-10M8	AC-HA002461	D8	PL00Y-501-90D8	EX-HA000794	M8	PL00Y-501-90M8	EX-HA000799
		U	PL00U-501-10D8	AC-HA000570	M8	PL00U-501-10M8	AC-HA002462	D8	PL00U-501-90D8	EX-HA000795	M8	PL00U-501-90M8	EX-HA000800
V		PL00V-501-10D8	AC-HA000571	M8	PL00V-501-10M8	AC-HA002463	D8	PL00V-501-90D8	EX-HA000796	M8	PL00V-501-90M8	EX-HA000801	
W		PL00W-501-10D8	AC-HA000572	M8	PL00W-501-10M8	AC-HA002464	D8	PL00W-501-90D8	EX-HA000797	M8	PL00W-501-90M8	EX-HA000802	
X		PL00X-501-10D10	AC-HA000489	M10	PL00X-501-10M10	AC-HA000494	D10	PL00X-501-90D10	EX-HA000748	M10	PL00X-501-90M10	EX-HA000807	
Y		PL00Y-501-10D10	AC-HA000490	M10	PL00Y-501-10M10	AC-HA000495	D10	PL00Y-501-90D10	EX-HA000803	M10	PL00Y-501-90M10	EX-HA000808	
U		PL00U-501-10D10	AC-HA000491	M10	PL00U-501-10M10	AC-HA000496	D10	PL00U-501-90D10	EX-HA000804	M10	PL00U-501-90M10	EX-HA000809	
V		PL00V-501-10D10	AC-HA000492	M10	PL00V-501-10M10	AC-HA000497	D10	PL00V-501-90D10	EX-HA000805	M10	PL00V-501-90M10	EX-HA000810	
W		PL00W-501-10D10	AC-HA000493	M10	PL00W-501-10M10	AC-HA000498	D10	PL00W-501-90D10	EX-HA000806	M10	PL00W-501-90M10	EX-HA000811	

Ordering Information-PowerLok™ 2POS Receptacle

Product Type	Connector Type	Key (Touch Proof Cover Color)		Current & HVIL		Termination Type		Termination Size
		Key	Color	Current	HVIL	Termination Type	Termination Size	
PowerLok™	08 2POS Receptacle	2X	Orange	120	120A W/O HVIL	10	Busbar Lug	D+Stud Size
				121	120A With HVIL			M+Stud Size
		2Y	Black	300	120A W/O HVIL	20	Thread Pin	M+Thread Size
				301	120A With HVIL			D+Cable Size

W/O HVIL													
Series Key	Busbar Lug+(D+Stud Size)				Busbar Lug+(M+Stud Size)			Thread Pin+(M+Thread Size)			Tubular Lug+(D+Cable Size)		
	Termination	Description	Part Number	Termination	Description	Part Number	Termination	Description	Part Number	Termination	Description	Part Number	
120A	X	D6	PL082X-120-10D6	AC-HA000771	M6	PL082X-120-10M6	AC-HA000773	-	-	-	-	-	
	Y	D6	PL082Y-120-10D6	AC-HA000772		PL082Y-120-10M6	AC-HA000774	-	-	-	-	-	-
300A	X	D6	PL082X-300-10D6	AC-HA001210	M6	PL082X-300-10M6	AC-HA001212	M6	PL082X-300-20M6	AC-HA002527	35	PL082X-300-30D35	AC-HA001566
	Y	D6	PL082Y-300-10D6	AC-HA001211		PL082Y-300-10M6	AC-HA001213		PL082Y-300-20M6	AC-HA002528		PL082Y-300-30D35	AC-HA001567
	X	D8	PL082X-300-10D8	AC-HA000811	M8	PL082X-300-10M8	AC-HA000813	M8	PL082X-300-20M8	AC-HA000947	50	PL082X-300-30D50	AC-HA001568
	Y	D8	PL082Y-300-10D8	AC-HA000812		PL082Y-300-10M8	AC-HA000814		PL082Y-300-20M8	AC-HA000948		PL082Y-300-30D50	AC-HA001569
	X	D10	PL082X-300-10D10	AC-HA000807	M10	PL082X-300-10M10	AC-HA000809	M10	PL082X-300-20M10	AC-HA002529	70	PL082X-300-30D70	AC-HA001570
	Y	D10	PL082Y-300-10D10	AC-HA000808		PL082Y-300-10M10	AC-HA000810		PL082Y-300-20M10	AC-HA002530		PL082Y-300-30D70	AC-HA001571

With HVIL													
Series Key	Busbar Lug+(D+Stud Size)				Busbar Lug+(M+Stud Size)			Thread Pin+(M+Thread Size)			Tubular Lug+(D+Cable Size)		
	Termination	Description	Part Number	Termination	Description	Part Number	Termination	Description	Part Number	Termination	Description	Part Number	
120A	X	D6	PL082X-121-10D6	AC-HA000767	M6	PL082X-121-10M6	AC-HA000769	-	-	-	-	-	
	Y	D6	PL082Y-121-10D6	AC-HA000768		PL082Y-121-10M6	AC-HA000770	-	-	-	-	-	-
300A	X	D6	PL082X-301-10D6	AC-HA001206	M6	PL082X-301-10M6	AC-HA001208	M6	PL082X-301-20M6	AC-HA002523	35	PL082X-301-30D35	AC-HA001560
	Y	D6	PL082Y-301-10D6	AC-HA001207		PL082Y-301-10M6	AC-HA001209		PL082Y-301-20M6	AC-HA002524		PL082Y-301-30D35	AC-HA001561
	X	D8	PL082X-301-10D8	AC-HA000803	M8	PL082X-301-10M8	AC-HA000805	M8	PL082X-301-20M8	AC-HA001507	50	PL082X-301-30D50	AC-HA001562
	Y	D8	PL082Y-301-10D8	AC-HA000804		PL082Y-301-10M8	AC-HA000806		PL082Y-301-20M8	AC-HA001508		PL082Y-301-30D50	AC-HA001563
	X	D10	PL082X-301-10D10	AC-HA000799	M10	PL082X-301-10M10	AC-HA000801	M10	PL082X-301-20M10	AC-HA002525	70	PL082X-301-30D70	AC-HA001564
	Y	D10	PL082Y-301-10D10	AC-HA000800		PL082Y-301-10M10	AC-HA000802		PL082Y-301-20M10	AC-HA002526		PL082Y-301-30D70	AC-HA001565

Ordering Information-PowerLok™ 3POS Receptacle

Product Type	Connector Type	Key (Touch Proof Cover Color)		Current & HVIL		Termination Type		Termination Size
		Key	Color	Current	HVIL	Termination Type	Termination Size	
PowerLok™	08 3POS Receptacle	3X	Orange	300	300A W/O HVIL	10	Busbar Lug	D+Stud Size
				301	300A With HVIL			M+Stud Size
		3Y	Black	300	300A W/O HVIL	20	Thread Pin	M+Thread Size
						30	Tubular Lug	D+Cable Size

W/O HVIL													
Series Key	Busbar Lug+(D+Stud Size)				Busbar Lug+(M+Stud Size)			Thread Pin+(M+Thread Size)			Tubular Lug+(D+Cable Size)		
	Termination	Description	Part Number	Termination	Description	Part Number	Termination	Description	Part Number	Termination	Description	Part Number	
300A	X	D6	PL083X-300-10D6	AC-HA001152	M6	PL083X-300-10M6	AC-HA001154	M6	PL083X-300-20M6	AC-HA002451	35	PL083X-300-30D35	AC-HA001578
	Y	D6	PL083Y-300-10D6	AC-HA001153		PL083Y-300-10M6	AC-HA001155		PL083Y-300-20M6	AC-HA002452		PL083Y-300-30D35	AC-HA001579
	X	D8	PL083X-300-10D8	AC-HA001148	M8	PL083X-300-10M8	AC-HA001150	M8	PL083X-300-20M8	AC-HA001513	50	PL083X-300-30D50	AC-HA001580
	Y	D8	PL083Y-300-10D8	AC-HA001149		PL083Y-300-10M8	AC-HA001151		PL083Y-300-20M8	AC-HA001514		PL083Y-300-30D50	AC-HA001581
X	D10	PL083X-300-10D10	AC-HA001144	M10	PL083X-300-10M10	AC-HA001146	M10	PL083X-300-20M10	AC-HA002533	70	PL083X-300-30D70	AC-HA001581	
Y	D10	PL083Y-300-10D10	AC-HA001145		PL083Y-300-10M10	AC-HA001147		PL083Y-300-20M10	AC-HA002534		PL083Y-300-30D70	AC-HA001583	

With HVIL													
Series Key	Busbar Lug+(D+Stud Size)				Busbar Lug+(M+Stud Size)			Thread Pin+(M+Thread Size)			Tubular Lug+(D+Cable Size)		
	Termination	Description	Part Number	Termination	Description	Part Number	Termination	Description	Part Number	Termination	Description	Part Number	
300A	X	D6	PL083X-301-10D6	AC-HA001140	M6	PL083X-301-10M6	AC-HA001142	M6	PL083X-300-20M6	AC-HA002449	35	PL083X-300-30D35	AC-HA001572
	Y	D6	PL083Y-301-10D6	AC-HA001141		PL083Y-301-10M6	AC-HA001143		PL083Y-300-20M6	AC-HA002450		PL083Y-300-30D35	AC-HA001573
	X	D8	PL083X-301-10D8	AC-HA001136	M8	PL083X-301-10M8	AC-HA001138	M8	PL083X-300-20M8	AC-HA001511	50	PL083X-300-30D50	AC-HA001574
	Y	D8	PL083Y-301-10D8	AC-HA001137		PL083Y-301-10M8	AC-HA001139		PL083Y-300-20M8	AC-HA001512		PL083Y-300-30D50	AC-HA001575
X	D10	PL083X-301-10D10	AC-HA001132	M10	PL083X-301-10M10	AC-HA001134	M10	PL083X-300-20M10	AC-HA002531	70	PL083X-300-30D70	AC-HA001576	
Y	D10	PL083Y-301-10D10	AC-HA001133		PL083Y-301-10M10	AC-HA001135		PL083Y-300-20M10	AC-HA002532		PL083Y-300-30D70	AC-HA001577	

Ordering Information-PowerLok™ 1POS Assembled Plug W/O HVIL

Product Type	Connector Type	Key (Touch Proof Cover Color)	Current & HVIL	Accepted Cable Size(mm ²)	Current Rating (A)
PowerLok™	18 Plug Connector, Straight, Shield	X Orange	200 200A W/O HVIL	25	120
	28 Plug Connector, Right Angle, Shield	Y Black		35	150
		U Yellow		50	200
		V Green		35	150
	48 Plug Connector, Straight, Un-shield	W Red	300 300A W/O HVIL	50	200
	58 Plug Connector, Right Angle, Un-shield	T Blue		70	250

W/O HVIL											
Series	Key	18: Plug Connector, Straight, Shield		28: Plug Connector, Right Angle, Shield		48: Plug Connector, Straight, Un-Shield		58: Plug Connector, Right Angle, Un-Shield			
		Description	Part Number	Description	Part Number	Description	Part Number	Description	Part Number		
200A	25	X	PL18X-200-25	PL18X-200-25	PL28X-200-25	PL28X-200-25	PL48X-200-25	PL48X-200-25	PL58X-200-25	PL58X-200-25	
		Y	PL18Y-200-25	PL18Y-200-25	PL28Y-200-25	PL28Y-200-25	PL48Y-200-25	PL48Y-200-25	PL58Y-200-25	PL58Y-200-25	
		U	PL18U-200-25	PL18U-200-25	PL28U-200-25	PL28U-200-25	PL48U-200-25	PL48U-200-25	PL58U-200-25	PL58U-200-25	
		V	PL18V-200-25	PL18V-200-25	PL28V-200-25	PL28V-200-25	PL48V-200-25	PL48V-200-25	PL58V-200-25	PL58V-200-25	
		W	PL18W-200-25	PL18W-200-25	PL28W-200-25	PL28W-200-25	PL48W-200-25	PL48W-200-25	PL58W-200-25	PL58W-200-25	
		X	PL18X-200-35	PL18X-200-35	PL28X-200-35	PL28X-200-35	PL48X-200-35	PL48X-200-35	PL58X-200-35	PL58X-200-35	
	35	Y	PL18Y-200-35	PL18Y-200-35	PL28Y-200-35	PL28Y-200-35	PL48Y-200-35	PL48Y-200-35	PL58Y-200-35	PL58Y-200-35	
		U	PL18U-200-35	PL18U-200-35	PL28U-200-35	PL28U-200-35	PL48U-200-35	PL48U-200-35	PL58U-200-35	PL58U-200-35	
		V	PL18V-200-35	PL18V-200-35	PL28V-200-35	PL28V-200-35	PL48V-200-35	PL48V-200-35	PL58V-200-35	PL58V-200-35	
		W	PL18W-200-35	PL18W-200-35	PL28W-200-35	PL28W-200-35	PL48W-200-35	PL48W-200-35	PL58W-200-35	PL58W-200-35	
		X	PL18X-200-50	PL18X-200-50	PL28X-200-50	PL28X-200-50	PL48X-200-50	PL48X-200-50	PL58X-200-50	PL58X-200-50	
		Y	PL18Y-200-50	PL18Y-200-50	PL28Y-200-50	PL28Y-200-50	PL48Y-200-50	PL48Y-200-50	PL58Y-200-50	PL58Y-200-50	
300A	50	U	PL18U-200-50	PL18U-200-50	PL28U-200-50	PL28U-200-50	PL48U-200-50	PL48U-200-50	PL58U-200-50	PL58U-200-50	
		V	PL18V-200-50	PL18V-200-50	PL28V-200-50	PL28V-200-50	PL48V-200-50	PL48V-200-50	PL58V-200-50	PL58V-200-50	
		W	PL18W-200-50	PL18W-200-50	PL28W-200-50	PL28W-200-50	PL48W-200-50	PL48W-200-50	PL58W-200-50	PL58W-200-50	
		X	PL18X-300-25	AC-HA004356	-	-	-	-	-	-	-
		Y	PL18Y-300-25	AC-HA004357	-	-	-	-	-	-	-
		U	PL18U-300-25	AC-HA004358	-	-	-	-	-	-	-
	25	V	PL18V-300-25	AC-HA004359	-	-	-	-	-	-	-
		W	PL18W-300-25	AC-HA004360	-	-	-	-	-	-	-
		T	PL18T-300-25	AC-HA004361	-	-	-	-	-	-	-
		X	PL18X-300-35	AC-HA000830	PL28X-300-35	AC-HA000860	PL48X-300-35	AC-HA002608	PL58X-300-35	AC-HA004455	
		Y	PL18Y-300-35	AC-HA000831	PL28Y-300-35	AC-HA000861	PL48Y-300-35	AC-HA002609	PL58Y-300-35	AC-HA004456	
		U	PL18U-300-35	AC-HA000832	PL28U-300-35	AC-HA000862	PL48U-300-35	AC-HA002610	PL58U-300-35	AC-HA004457	
35	V	PL18V-300-35	AC-HA000833	PL28V-300-35	AC-HA000863	PL48V-300-35	AC-HA002611	PL58V-300-35	AC-HA004458		
	W	PL18W-300-35	AC-HA000834	PL28W-300-35	AC-HA000864	PL48W-300-35	AC-HA002612	PL58W-300-35	AC-HA004459		
	T	PL18T-300-35	AC-HA001286	PL28T-300-35	AC-HA001292	PL48T-300-35	AC-HA008507	PL58T-300-35	AC-HA008513		
	X	PL18X-300-50	AC-HA000835	PL28X-300-50	AC-HA000865	PL48X-300-50	AC-HA002618	PL58X-300-50	AC-HA003745		
	Y	PL18Y-300-50	AC-HA000836	PL28Y-300-50	AC-HA000866	PL48Y-300-50	AC-HA002619	PL58Y-300-50	AC-HA003746		
	U	PL18U-300-50	AC-HA000837	PL28U-300-50	AC-HA000867	PL48U-300-50	AC-HA002620	PL58U-300-50	AC-HA003747		
50	V	PL18V-300-50	AC-HA000838	PL28V-300-50	AC-HA000868	PL48V-300-50	AC-HA002621	PL58V-300-50	AC-HA003748		
	W	PL18W-300-50	AC-HA000839	PL28W-300-50	AC-HA000869	PL48W-300-50	AC-HA002622	PL58W-300-50	AC-HA003749		
	T	PL18T-300-50	AC-HA001287	PL28T-300-50	AC-HA003528	PL48T-300-50	AC-HA008508	PL58T-300-50	AC-HA008514		
	X	PL18X-300-70	AC-HA000840	PL28X-300-70	AC-HA000870	PL48X-300-70	AC-HA002628	PL58X-300-70	AC-HA004460		
	Y	PL18Y-300-70	AC-HA000841	PL28Y-300-70	AC-HA000871	PL48Y-300-70	AC-HA002629	PL58Y-300-70	AC-HA004461		
	U	PL18U-300-70	AC-HA000842	PL28U-300-70	AC-HA000872	PL48U-300-70	AC-HA002630	PL58U-300-70	AC-HA004462		
70	V	PL18V-300-70	AC-HA000843	PL28V-300-70	AC-HA000873	PL48V-300-70	AC-HA002631	PL58V-300-70	AC-HA004463		
	W	PL18W-300-70	AC-HA000844	PL28W-300-70	AC-HA000874	PL48W-300-70	AC-HA002632	PL58W-300-70	AC-HA004464		
	T	PL18T-300-70	AC-HA001288	PL28T-300-70	AC-HA003529	PL48T-300-70	AC-HA008509	PL58T-300-70	AC-HA008515		

Ordering Information-PowerLok™ 1POS Assembled Plug With HVIL

Product Type	Connector Type	Key (Touch Proof Cover Color)	Current & HVIL	Accepted Cable Size(mm ²)	Current Rating (A)
PowerLok™	18 Plug Connector, Straight, Shield	X Orange	201 200A With HVIL	25	120
	28 Plug Connector, Right Angle, Shield	Y Black		35	150
		U Yellow		50	200
	48 Plug Connector, Straight, Un-shield	V Green	301 300A With HVIL	35	150
	58 Plug Connector, Right Angle, Un-shield	W Red		50	200
		T Blue		70	250

With HVIL										
Series	Key	18: Plug Connector, Straight, Shield		28: Plug Connector, Right Angle, Shield		48: Plug Connector, Straight, Un-Shield		58: Plug Connector, Right Angle, Un-Shield		
		Description	Part Number	Description	Part Number	Description	Part Number	Description	Part Number	
200A	25	X	PL18X-201-25	AC-HA004290	PL28X-201-25	AC-HA004305	PL48X-201-25	PL48X-201-25	PL58X-201-25	PL58X-201-25
		Y	PL18Y-201-25	AC-HA004291	PL28Y-201-25	AC-HA004306	PL48Y-201-25	PL48Y-201-25	PL58Y-201-25	PL58Y-201-25
		U	PL18U-201-25	AC-HA004292	PL28U-201-25	AC-HA004307	PL48U-201-25	PL48U-201-25	PL58U-201-25	PL58U-201-25
		V	PL18V-201-25	AC-HA004293	PL28V-201-25	AC-HA004308	PL48V-201-25	PL48V-201-25	PL58V-201-25	PL58V-201-25
	35	W	PL18W-201-25	AC-HA004294	PL28W-201-25	AC-HA004309	PL48W-201-25	PL48W-201-25	PL58W-201-25	PL58W-201-25
		X	PL18X-201-35	AC-HA004295	PL28X-201-35	AC-HA004310	PL48X-201-35	PL48X-201-35	PL58X-201-35	PL58X-201-35
		Y	PL18Y-201-35	AC-HA004296	PL28Y-201-35	AC-HA004311	PL48Y-201-35	PL48Y-201-35	PL58Y-201-35	PL58Y-201-35
		U	PL18U-201-35	AC-HA004297	PL28U-201-35	AC-HA004312	PL48U-201-35	PL48U-201-35	PL58U-201-35	PL58U-201-35
	50	V	PL18V-201-35	AC-HA004298	PL28V-201-35	AC-HA004313	PL48V-201-35	PL48V-201-35	PL58V-201-35	PL58V-201-35
		W	PL18W-201-35	AC-HA004299	PL28W-201-35	AC-HA004314	PL48W-201-35	PL48W-201-35	PL58W-201-35	PL58W-201-35
		X	PL18X-201-50	AC-HA004300	PL28X-201-50	AC-HA004315	PL48X-201-50	PL48X-201-50	PL58X-201-50	PL58X-201-50
		Y	PL18Y-201-50	AC-HA004301	PL28Y-201-50	AC-HA004316	PL48Y-201-50	PL48Y-201-50	PL58Y-201-50	PL58Y-201-50
300A	35	U	PL18U-201-50	AC-HA004302	PL28U-201-50	AC-HA004317	PL48U-201-50	PL48U-201-50	PL58U-201-50	PL58U-201-50
		V	PL18V-201-50	AC-HA004303	PL28V-201-50	AC-HA004318	PL48V-201-50	PL48V-201-50	PL58V-201-50	PL58V-201-50
		W	PL18W-201-50	AC-HA004304	PL28W-201-50	AC-HA004319	PL48W-201-50	PL48W-201-50	PL58W-201-50	PL58W-201-50
		X	PL18X-301-35	AC-HA000815	PL28X-301-35	AC-HA000845	PL48X-301-35	AC-HA002603	PL58X-301-35	AC-HA004440
	50	Y	PL18Y-301-35	AC-HA000816	PL28Y-301-35	AC-HA000846	PL48Y-301-35	AC-HA002604	PL58Y-301-35	AC-HA004441
		U	PL18U-301-35	AC-HA000817	PL28U-301-35	AC-HA000847	PL48U-301-35	AC-HA002605	PL58U-301-35	AC-HA004442
		V	PL18V-301-35	AC-HA000818	PL28V-301-35	AC-HA000848	PL48V-301-35	AC-HA002606	PL58V-301-35	AC-HA004443
		W	PL18W-301-35	AC-HA000819	PL28W-301-35	AC-HA000849	PL48W-301-35	AC-HA002607	PL58W-301-35	AC-HA004444
	70	T	PL18T-301-35	AC-HA001283	PL28T-301-35	AC-HA001289	PL48T-301-35	AC-HA008504	PL58T-301-35	AC-HA008510
		X	PL18X-301-50	AC-HA000820	PL28X-301-50	AC-HA000850	PL48X-301-50	AC-HA002613	PL58X-301-50	AC-HA004445
		Y	PL18Y-301-50	AC-HA000821	PL28Y-301-50	AC-HA000851	PL48Y-301-50	AC-HA002614	PL58Y-301-50	AC-HA004446
		U	PL18U-301-50	AC-HA000822	PL28U-301-50	AC-HA000852	PL48U-301-50	AC-HA002615	PL58U-301-50	AC-HA004447
V		PL18V-301-50	AC-HA000823	PL28V-301-50	AC-HA000853	PL48V-301-50	AC-HA002616	PL58V-301-50	AC-HA004448	
W		PL18W-301-50	AC-HA000824	PL28W-301-50	AC-HA000854	PL48W-301-50	AC-HA002617	PL58W-301-50	AC-HA004449	
T		PL18T-301-50	AC-HA001284	PL28T-301-50	AC-HA001290	PL48T-301-50	AC-HA008505	PL58T-301-50	AC-HA008511	
X		PL18X-301-70	AC-HA000825	PL28X-301-70	AC-HA000855	PL48X-301-70	AC-HA002623	PL58X-301-70	AC-HA004450	
Y	PL18Y-301-70	AC-HA000826	PL28Y-301-70	AC-HA000856	PL48Y-301-70	AC-HA002624	PL58Y-301-70	AC-HA004451		
70	U	PL18U-301-70	AC-HA000827	PL28U-301-70	AC-HA000857	PL48U-301-70	AC-HA002625	PL58U-301-70	AC-HA004452	
	V	PL18V-301-70	AC-HA000828	PL28V-301-70	AC-HA000858	PL48V-301-70	AC-HA002626	PL58V-301-70	AC-HA004453	
	W	PL18W-301-70	AC-HA000829	PL28W-301-70	AC-HA000859	PL48W-301-70	AC-HA002627	PL58W-301-70	AC-HA004454	
	T	PL18T-301-70	AC-HA001285	PL28T-301-70	AC-HA001291	PL48T-301-70	AC-HA008506	PL58T-301-70	AC-HA008512	

Ordering Information-PowerLok™ 2POS Assembled Plug

Product Type	Connector Type	Key (Touch Proof Cover Color)	Current & HVIL	Accepted Cable Size(mm ²)	Current Rating (A)
PowerLok™	18 Plug Connector, Straight, Shield	2X Orange	300 300A W/O HVIL	35	150
	28 Plug Connector, Right Angle, Shield			50	200
	48 Plug Connector, Straight, Un-Shield	2Y Black	301 300A With HVIL	35	150
	58 Plug Connector, Right Angle, Un-Shield			50	200
				70	250

Series	Key	18: Plug Connector, Straight, Shield		28: Plug Connector, Right Angle, Shield		48: Plug Connector, Straight, Un-Shield		58: Plug Connector, Right Angle, Un-Shield		
		Description	Part Number	Description	Part Number	Description	Part Number	Description	Part Number	
W/O HVIL										
300A	35	2X	PL182X-300-35	AC-HA000787	PL282X-300-35	AC-HA000793	PL482X-300-35	AC-HA002635	PL582X-300-35	AC-HA004490
		2Y	PL182Y-300-35	AC-HA000788	PL282Y-300-35	AC-HA000794	PL482Y-300-35	AC-HA002636	PL582Y-300-35	AC-HA004491
	50	2X	PL182X-300-50	AC-HA000789	PL282X-300-50	AC-HA000795	PL482X-300-50	AC-HA002639	PL582X-300-50	AC-HA004492
		2Y	PL182Y-300-50	AC-HA000790	PL282Y-300-50	AC-HA000796	PL482Y-300-50	AC-HA002640	PL582Y-300-50	AC-HA004493
	70	2X	PL182X-300-70	AC-HA000791	PL282X-300-70	AC-HA000797	PL482X-300-70	AC-HA002643	PL582X-300-70	AC-HA004494
		2Y	PL182Y-300-70	AC-HA000792	PL282Y-300-70	AC-HA000798	PL482Y-300-70	AC-HA002644	PL582Y-300-70	AC-HA004495
With HVIL										
300A	35	2X	PL182X-301-35	AC-HA000775	PL282X-301-35	AC-HA000781	PL482X-301-35	AC-HA002446	PL582X-301-35	AC-HA002448
		2Y	PL182Y-301-35	AC-HA000776	PL282Y-301-35	AC-HA000782	PL482Y-301-35	AC-HA002634	PL582Y-301-35	AC-HA004485
	50	2X	PL182X-301-50	AC-HA000777	PL282X-301-50	AC-HA000783	PL482X-301-50	AC-HA002637	PL582X-301-50	AC-HA004486
		2Y	PL182Y-301-50	AC-HA000778	PL282Y-301-50	AC-HA000784	PL482Y-301-50	AC-HA002638	PL582Y-301-50	AC-HA004487
	70	2X	PL182X-301-70	AC-HA000779	PL282X-301-70	AC-HA000785	PL482X-301-70	AC-HA002641	PL582X-301-70	AC-HA004488
		2Y	PL182Y-301-70	AC-HA000780	PL282Y-301-70	AC-HA000786	PL482Y-301-70	AC-HA002642	PL582Y-301-70	AC-HA004489

Ordering Information-PowerLok™ 3POS Assembled Plug

Product Type	Connector Type	Key (Touch Proof Cover Color)	Current & HVIL	Accepted Cable Size(mm ²)	Current Rating (A)
PowerLok™	18 Plug Connector, Straight, Shield	3X Orange	300 300A W/O HVIL	35	150
	28 Plug Connector, Right Angle, Shield			50	200
	48 Plug Connector, Straight, Un-Shield	3Y Black	300 300A With HVIL	35	150
	58 Plug Connector, Right Angle, Un-Shield			50	200
				70	250

Series	Key	18: Plug Connector, Straight, Shield		28: Plug Connector, Right Angle, Shield		48: Plug Connector, Straight, Un-Shield		58: Plug Connector, Right Angle, Un-Shield		
		Description	Part Number	Description	Part Number	Description	Part Number	Description	Part Number	
W/O HVIL										
300A	35	3X	PL183X-300-35	AC-HA001114	PL283X-300-35	AC-HA001126	PL483X-300-35	-	PL583X-300-35	-
		3Y	PL183Y-300-35	AC-HA001115	PL283Y-300-35	AC-HA001127	PL483Y-300-35	-	PL583Y-300-35	-
	50	3X	PL183X-300-50	AC-HA001116	PL283X-300-50	AC-HA001128	PL483X-300-50	-	PL583X-300-50	-
		3Y	PL183Y-300-50	AC-HA001117	PL283Y-300-50	AC-HA001129	PL483Y-300-50	-	PL583Y-300-50	-
	70	3X	PL183X-300-70	AC-HA001118	PL283X-300-70	AC-HA001130	PL483X-300-70	-	PL583X-300-70	-
		3Y	PL183Y-300-70	AC-HA001119	PL283Y-300-70	AC-HA001131	PL483Y-300-70	-	PL583Y-300-70	-
With HVIL										
300A	35	3X	PL183X-301-35	AC-HA001108	PL283X-301-35	AC-HA001120	PL483X-301-35	-	PL583X-301-35	-
		3Y	PL183Y-301-35	AC-HA001109	PL283Y-301-35	AC-HA001121	PL483Y-301-35	-	PL583Y-301-35	-
	50	3X	PL183X-301-50	AC-HA001110	PL283X-301-50	AC-HA001122	PL483X-301-50	-	PL583X-301-50	-
		3Y	PL183Y-301-50	AC-HA001111	PL283Y-301-50	AC-HA001123	PL483Y-301-50	-	PL583Y-301-50	-
	70	3X	PL183X-301-70	AC-HA001112	PL283X-301-70	AC-HA001124	PL483X-301-70	-	PL583X-301-70	-
		3Y	PL183Y-301-70	AC-HA001113	PL283Y-301-70	AC-HA001125	PL483Y-301-70	-	PL583Y-301-70	-

Ordering Information-PowerLok™ 1POS Overmolded Plug

Product Type	Connector Type	Key (Touch Proof Cover Color)	Current & HVIL	Accepted Cable Size(mm)	Current Rating (A)	
PowerLok™	10 1POS Plug Straight	X Orange	120 120A W/O HVIL	16	90	
			121 120A With HVIL	25	120	
		Y Black	300 300A W/O HVIL	35	150	
			50 500A With HVIL	50	200	
		U Yellow	301 300A With HVIL	70	250	
	20 1POS Plug Right Angle			400 400A W/O HVIL	95	300
				70 400A With HVIL	70	250
		V Green	401 400A With HVIL	95	300	
				120 400A With HVIL	120	400
		W Red	500 500A W/O HVIL	135	450	
			95 500A With HVIL	95	300	
			120 500A With HVIL	120	400	
			135 500A With HVIL	135	450	
			150 500A With HVIL	150	500	

Ordering Information-PowerLok™ 2POS Overmolded Plug

Product Type	Connector Type	Key (Touch Proof Cover Color)	Current & HVIL	Accepted Cable Size(mm)	Current Rating (A)
PowerLok™	10 2POS Plug Straight	2X Orange	120 120A W/O HVIL	16	90
	20 2POS Plug Right Angle	2Y Black	121 120A With HVIL	25	120

▲ The information contained in this data sheet is for reference only

Amphenol Technical Products International provides the above product specifications for the standard PowerLok™ series of connectors to assist users in identifying the correct product for the system to which the connectors may be applied. Specifications are subject to change without notice. Contact your nearest Amphenol Corporation Sales Office for the latest specifications. All statements, information and data given herein are believed to be accurate and reliable but are presented without guarantee, warranty, or responsibility of any kind, expressed or implied. Statements of suggestions concerning possible use of our products are made without representation or warranty that any such use is free of patent infringement and are not recommendations to infringe any patent. Specifications are typical and may not apply to all connectors. Note that these specifications are derived from relevant global standards used in the automotive and industrial transportation markets, but they are not a substitute for system level design validation testing, which is the sole responsibility of the system designer and/or end user.

Amphenol Technical Products International

Asia Pacific

GuangZhou, China
Tel: +86-20-3210 6099
Add: No.5 JianTaShan Road,GuangZhou Science City
Zipe Code: 510663

North America

Winnipeg, Canada
Tel: +1 204 697 2222
Add: 2110 Notre Dame Avenue

Europe

Milano, Italy
Tel: +39 02 932541
Add: Via Barbaiana 5, 20020 Lainate (MI)

Email: info@amphenol-tpi.com