



TURBO INDIA

Interconnect Solutions
ISO 9001-2015 Company

www.turboindia-ics.com



QUALITY
YOU CAN **TRUST**

Military . Aerospace . Industrial . Telecom . Automotive . Oil & Gas

ISO 9001:2015
Certified



ABOUT US

Founded in the year 1996, Turbo India – ICS, specializes in manufacture and supply of interconnect products. Our product portfolio includes circular and rectangular backshells, shrink boot adapters, cable clamp adapters, protective covers and custom design solutions for harsh environment interconnect applications in Military, Aerospace and Industrial sectors. Our facility, headquartered in Bangalore, boasts of 24000sq.ft manufacturing space with modern CNC machines, sophisticated quality and testing instruments and effective assembly equipments.

At Turbo India, we strive to meet and exceed our customer's expectation through continuous improvement in Design, Production, Quality, Delivery and Pricing aspects of our products. Our manufacturing system conforms to the ISO 9001:2015 standard and we are currently working towards obtaining the AS9100 certification.



CIRCULAR BACKSHELLS

Backshells are electro mechanical devices threaded to the rear of the connector. These devices provide screening, environmental sealing, strain relief and EMI/RFI protection for cable terminations.

Turbo India provides circular backshells with various material and finishes which are compatible with some of the major military circular connector series. Mil-Spec connectors are generally used in Military, Aerospace and harsh environment Industrial applications. The most popular ones being MIL-DTL-38999 series I, II, III, IV. Turbo offers backshells in a wide range of styles and configurations for these connectors.





RECTANGULAR BACKSHELLS

Turbo India offers rectangular backsells for D-Sub, Micro D-Sub and Arinc 600 rack and panel connectors. The backsells are available in multiple styles and configurations including straight, 45°, 90°, split-type or one piece body.

We also offer support on any type of custom requirement for rectangular backsells. Our design team offers 3D models for any special requirement of our customers, to view, within hours of receiving enquiries



PROTECTIVE COVERS

Turbo India offers protective covers for circular threaded and bayonet connectors. The covers are used for environmental protection of plugs and receptacles against dust, water, moisture, EMI. The dust covers are available in wide range of lanyard and ring styles for many of the popular connector series.



CIRCULAR BACKSHELL - PRODUCT RANGE

PRODUCT SERIES CODE	DESCRIPTION
21	EMI/RFI Band/Spring Adapter
31	EMI/RFI Memory Ring Adapter
41	O-Ring Sealed Shrink Boot Adapter
51	Shield Sock Shrink Boot Adapter Environmental, Screened
61	EMI/RFI Lamp Base Thread Adapter
110-01	Submersible Cable Clamp Adapter Environmental, Non Screened
110-02	Cable Clamp Adapter Non Environmental, Non Screened
110-03	Submersible Cable Clamp Adapter Environmental, Screened
110-04	Cable Clamp Adapter Non Environmental, Screened
160-01	Band In A Can Adapter Environmental
160-02	Band In A Can Adapter Non Environmental

** For any special/custom backshell requirements, please reach out to us at sales@turboindia.co.in

THIS DRAWING IS COPYRIGHT AND THE PROPERTY OF TURBO INDIA. IT MUST NOT BE COPIED, USED FOR MANUFACTURE OR OTHERWISE DISCLOSED WITHOUT PRIOR WRITTEN CONSENT OF THE COMPANY.



TURBO INDIA

#114, P.C Industrial Estate Kamakshipalya,
Magadi Rd. Bangalore 560 079, Karnataka, India

DESCRIPTION :

CIRCULAR BACKSHELL - PRODUCT SERIES

PART NUMBER / SERIES:

COMMON DATA

PAGE:NO

A

CONNECTOR INTERFACE	DESCRIPTION
H	MIL-DTL-38999 SERIES III & IV
F	MIL-DTL-38999 SERIES I & II
A	MIL-DTL-26482 SERIES II
A	AS 50151 CRIMP
A	MIL-DTL-83723 SERIES I & III

THIS DRAWING IS COPYRIGHT AND THE PROPERTY OF TURBO INDIA. IT MUST NOT BE COPIED, USED FOR MANUFACTURE OR OTHERWISE DISCLOSED WITHOUT PRIOR WRITTEN CONSENT OF THE COMPANY.



TURBO INDIA

#114, P.C Industrial Estate Kamakshipalya,
Magadi Rd. Bangalore 560 079, Karnataka, India

DESCRIPTION :

CONNECTOR INTERFACE

PART NUMBER / SERIES:

COMMON DATA

PAGE:NO

B

COUPLING RING OPTION	
CODE	DESCRIPTION
1	DIRECT COUPLING
3	FREE SPINNING
3X	FREE SPINNING WITH SAFETY WIRE HOLE
5	SELF-LOCK
7	NON-DETENT SELF-LOCK

Direct Coupling (1) : The coupling nut is eliminated in this design, and the backshell directly threads to the connector.

Free Spinning (3) : Free Spinning Adapters makes the assembly of the backshell to the connector easy without turning the entire backshell body. The coupling nut is free to rotate in this design.

Free Spinning with Safety Wire Holes (3X) : In this design, 3 equally spaced holes are provided on the coupling nut to prevent accidental decoupling in high vibration environment.

Self Lock - Detent (5) : The movement of coupling nut is locked by means of a anti-decoupling device in this design. The Self Lock adapters are the most popular among the many backshell adapter variants.

Self Lock - Non Detent (7) : In this design, the coupling nuts are locked in a pre-tensioned condition to achieve the Self Lock feature.



TURBO INDIA

#114, P.C Industrial Estate Kamakshipalya,
Magadi Rd. Bangalore 560 079, Karnataka, India

DESCRIPTION :

COUPLING RING OPTION

PART NUMBER / SERIES:

COMMON DATA

PAGE:NO

C

THIS DRAWING IS COPYRIGHT
AND THE PROPERTY OF TURBO
INDIA. IT MUST NOT BE COPIED,
USED FOR MANUFACTURE OR
OTHERWISE DISCLOSED
WITHOUT PRIOR WRITTEN
CONSENT OF THE COMPANY.

MATERIAL & FINISH	
CODE	DESCRIPTION
W	Cadmium - Olive drab over suitable underplate, -65 to +175 °C
N	Electroless nickel - In accordance with AMS-C-26074 or AMS2404, -65 to +200 °C
Z	Zinc nickel in accordance with ASTM B841 or AMS2417 over suitable underplate. Color shall be black, conductive, and non-reflective. Final finish shall be electrically conductive, -65 to +175 °C
VB	Zinc-Cobalt, Black ,ASTM B 840 Grade 6 Type D over electroless nickel , Conductive -65 to +175°C.
VO	Zinc-Cobalt, Olive Drab ,ASTM B 840 Grade 6 Type D over electroless nickel, Conductive -65 to +175°C.
A	Black anodize - In accordance with Class 2 of MIL-A-8625, Type II, -65 to +175 °C.
AH	Anodize, Hardcoat, Black AMS-A-8625 Type III, Class 2, .001" thick, Non-Conductive -65 to +200°C

*** The backshell adapters, dust covers and accessories will be supplied in Aluminium. For other material and finish requirements, please reach out to us at sales@turboindia.co.in.

THIS DRAWING IS COPYRIGHT AND THE PROPERTY OF TURBO INDIA. IT MUST NOT BE COPIED, USED FOR MANUFACTURE OR OTHERWISE DISCLOSED WITHOUT PRIOR WRITTEN CONSENT OF THE COMPANY.



TURBO INDIA

#114, P.C Industrial Estate Kamakshipalya,
Magadi Rd. Bangalore 560 079, Karnataka, India

DESCRIPTION :

MATERIAL & FINISH

PART NUMBER / SERIES:

COMMON DATA

PAGE:NO

D

PRODUCT SERIES CODE	CONNECTOR FAMILY
12 & 13	MIL-DTL-38999 SERIES I
22 & 23	MIL-DTL-38999 SERIES II
32 & 33	MIL-DTL-38999 SERIES III
42 & 43	MIL-DTL-38999 SERIES IV
52 & 53	MIL-DTL-26482-SERIES I & II
62 & 63	AS 50151

THIS DRAWING IS COPYRIGHT AND THE PROPERTY OF TURBO INDIA. IT MUST NOT BE COPIED, USED FOR MANUFACTURE OR OTHERWISE DISCLOSED WITHOUT PRIOR WRITTEN CONSENT OF THE COMPANY.



TURBO INDIA

#114, P.C Industrial Estate Kamakshipalya,
Magadi Rd. Bangalore 560 079, Karnataka, India

DESCRIPTION :

PRODUCT SERIES - PROTECTIVE COVERS

PART NUMBER / SERIES:

COMMON DATA

PAGE:NO

E

LANYARD OPTIONS



SC- Stainless Steel Sash Chain

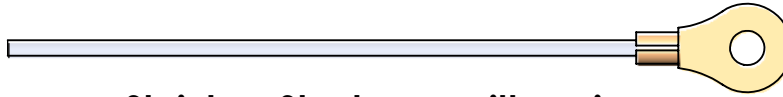

Stainless Steel rope with various Jacket Option**



NB- Nylon Rope - Black



CF - Crimp Ferrule Option



FERRULE
SUPPLIED LOOSE

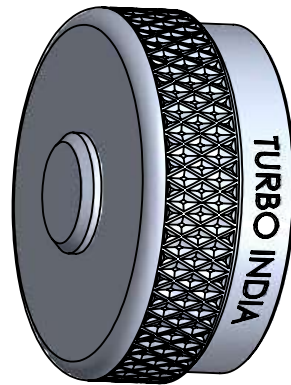

NA -No Accessory

CODE	JACKET OPTION **
Y	Stainless Steel Wire Rope, Nylon Jacket
T	Stainless Steel Wire Rope, Teflon Jacket
P	Stainless Steel Wire Rope, PVC Jacket



TURBO INDIA

#114, P.C Industrial Estate Kamakshipalya,
Magadi Rd. Bangalore 560 079, Karnataka, India

<p>DESCRIPTION : LANYARD OPTIONS (PROTECTIVE COVER)</p>	<p>PAGE:NO F</p>
<p>REVISION 0</p>	<p>PART NUMBER / SERIES: COMMON DATA</p>

THIS DRAWING IS COPYRIGHT AND THE PROPERTY OF TURBO INDIA. IT MUST NOT BE COPIED, USED FOR MANUFACTURE OR OTHERWISE DISCLOSED WITHOUT PRIOR WRITTEN CONSENT OF THE COMPANY.

UNLESS OTHERWISE SPECIFIED :
ALL DIMENSIONS IN MILLIMETRES
GENERAL TOL:
LINEAR : +/-0.10MM
ANGULAR : +/- 2°

DRAWN :	AD	DATE	24-01-2020
CHECKED :	AD	DATE	24-01-2020
APPROVED :	MR	DATE	25-01-2020
MATERIAL :	--	REVISION	0
WEIGHT :	--		

SOLID RINGS

STRAIGHT RING

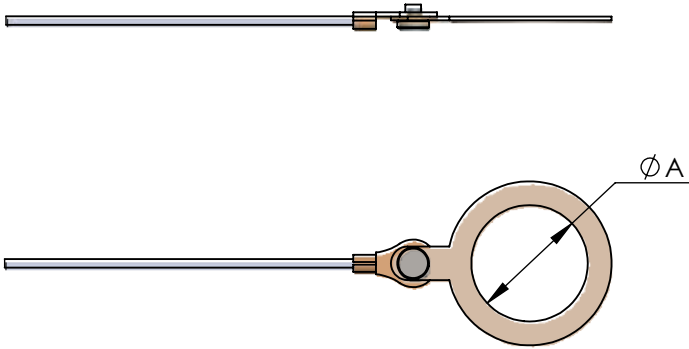

BEND RING

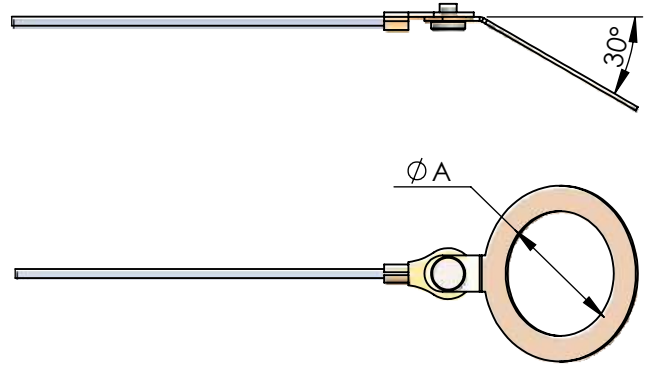

EYELET

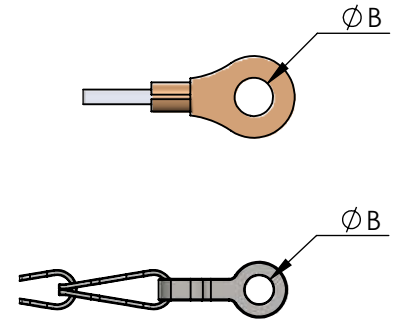

SOLID RING OPTION

STRAIGHT RING		BEND RING			
DASH NO	ϕA ± 0.40 (mm)	ϕA ± 0.015 (inch.)	DASH NO	ϕA ± 0.40 (mm)	ϕA ± 0.015 (inch.)
135	13.50	0.531	135B	13.50	0.531
180	18.00	0.709	180B	18.00	0.709
205	20.50	0.807	205B	20.50	0.807
220	22.00	0.866	220B	22.00	0.866
231	23.10	0.909	231B	23.10	0.909
261	26.10	1.028	261B	26.10	1.028
301	30.10	1.185	301B	30.10	1.185
326	32.65	1.285	326B	32.65	1.285
345	34.50	1.358	345B	34.50	1.358
365	36.50	1.437	365B	36.50	1.437
391	39.10	1.539	391B	39.10	1.539
430	43.00	1.693	430B	43.00	1.693
450	45.00	1.772	450B	45.00	1.772

* STANDARD SIZES ARE LISTED. CUSTOMIZATION IS POSSIBLE FOR RING & EYELET

EYELET OPTION

DASH NO	$\phi B \pm 0.25$ (mm)	$\phi B \pm 0.01$ (inch.)
01	3.60	0.140
02	4.60	0.182
03	4.90	0.191
04	5.00	0.197
05	4.20	0.167
06	3.20	0.125
07	5.50	0.218
08	4.00	0.156
00	NO EYELET	



TURBO INDIA

#114, P.C Industrial Estate Kamakshipalya,
Magadi Rd. Bangalore 560 079, Karnataka, India

DATE

24-01-2020

DRAWN : AD

CHECKED : AD

APPROVED : MR

MATERIAL : --

WEIGHT : --

REVISION

0

DESCRIPTION :

**SOLID RING / EYELET OPTION
(PROTECTIVE COVER)**

PART NUMBER / SERIES:

COMMON DATA

PAGE:NO

G

THIS DRAWING IS COPYRIGHT AND THE PROPERTY OF TURBO INDIA. IT MUST NOT BE COPIED, USED FOR MANUFACTURE OR OTHERWISE DISCLOSED WITHOUT PRIOR WRITTEN CONSENT OF THE COMPANY.

UNLESS OTHERWISE SPECIFIED :
ALL DIMENSIONS IN MILLIMETRES
GENERAL TOL:
LINEAR : +/-0.10MM
ANGULAR : +/-2°

A - INTERFACE

SHELL SIZE	A - THREAD	MAX ENTRY
08	1/2 - 20 UNEF	04
10	5/8 - 24 UNEF	06
12	3/4 - 20 UNEF	08
14	7/8 - 20 UNEF	09
16	1 - 20 UNEF	11
18	1 1/16 - 18 UNEF	12
20	1 3/16 - 18 UNEF	14
22	1 5/16 - 18 UNEF	16
24	1 7/16 - 18 UNEF	18
28	1 3/4 - 18 UNS	22
32	2 - 18 UNS	26
36	2 1/4 - 16 UN	27
40	2 1/2 - 16 UN	29
44	2 3/4 - 16 UN	20
48	3 - 16 UN	22
61	1 1/2 - 18 UNEF	18

H - INTERFACE

SHELL SIZE	A - THREAD	MAX ENTRY
09	M12 x 1.0	05
11	M15 x 1.0	07
13	M18 x 1.0	09
15	M22 x 1.0	11
17	M25 x 1.0	13
19	M28 x 1.0	14
21	M31 x 1.0	16
23	M34 x 1.0	18
25	M37 x 1.0	20

F - INTERFACE

SHELL SIZE	A - THREAD	MAX ENTRY
08	7/16 - 28 UNEF	04
10	9/16 - 24 UNEF	06
12	11/16 - 24 UNEF	08
14	13/16 - 20 UNEF	10
16	15/16 - 18 UNEF	12
18	1 1/16 - 18 UNEF	14
20	1 3/16 - 18 UNEF	16
22	1 5/16 - 18 UNEF	18
24	1 7/16 - 18 UNEF	20

THIS DRAWING IS COPYRIGHT AND THE PROPERTY OF TURBO INDIA. IT MUST NOT BE COPIED, USED FOR MANUFACTURE OR OTHERWISE DISCLOSED WITHOUT PRIOR WRITTEN CONSENT OF THE COMPANY.

**TURBO INDIA**

#114, P.C Industrial Estate Kamakshipalya,
Magadi Rd. Bangalore 560 079, Karnataka, India

DESCRIPTION :

INTERFACE TABLE

PART NUMBER / SERIES:

COMMON DATA

PAGE:NO

H

PART DESCRIPTION	MATERIAL
COUPLING RINGS	Aluminum 6061
BARRELS	Aluminum 6061
CABLE CLAMP BODY	Aluminum Alloy A380 , Aluminum 6061
CABLE CLAMP SADDLES	Aluminum Alloy A380 , Aluminum 6061
FERRULE	Aluminum 6061
FOLLOWERS	Aluminum 6061
RETAINER RINGS	300 Series Stainless Steel
FASTENERS AND WASHERS	300 Series Stainless Steel
BRAID	Tinned Copper per QQB-575
O-RINGS	Silicone Rubber
GROMMET & BUSHING	Neoprene , Silicone Rubber
SELF - LOCK CLIPS	Non Corrosive Material

THIS DRAWING IS COPYRIGHT AND THE PROPERTY OF TURBO INDIA. IT MUST NOT BE COPIED, USED FOR MANUFACTURE OR OTHERWISE DISCLOSED WITHOUT PRIOR WRITTEN CONSENT OF THE COMPANY.



TURBO INDIA

#114, P.C Industrial Estate Kamakshipalya,
Magadi Rd. Bangalore 560 079, Karnataka, India

DESCRIPTION :

MATERIAL

PART NUMBER / SERIES:
COMMON DATA

PAGE:NO
J

PART NUMBER BREAKDOWN FOR STANDARD CIRCULAR ADAPTERS

TB 21 A 3 N VB - 18 09 - 8

BRAND IDENTIFIER

PRODUCT SERIES CODE
(SEE PAGE - A)

CONNECTOR INTERFACE
(SEE PAGE - B)

COUPLING RING OPTION
(SEE PAGE - C)

ANGLE
S = STRAIGHT
F = 45°
N = 90°

LENGTH CODE

OMIT FOR STANDARD LENGTH.
REFER PRODUCT DATA SHEET FOR
DETAIL.

CABLE ENTRY CODE

SHELL SIZE

MATERIAL & FINISH
(SEE PAGE - D)

PART NUMBER BREAKDOWN FOR CABLE CLAMP ADAPTERS

TB 110-04 H 3 N VB - 15 05 - A - 8

BRAND IDENTIFIER

PRODUCT SERIES CODE
(SEE PAGE - A)

CONNECTOR INTERFACE
(SEE PAGE - B)

COUPLING RING OPTION
(SEE PAGE - C)

ANGLE
S = STRAIGHT
F = 45°
N = 90°

MATERIAL & FINISH
(SEE PAGE - D)

LENGTH CODE

OMIT FOR STANDARD
LENGTH. REFER PRODUCT
DATA SHEET FOR DETAIL.

CABLE CLAMP TYPE

A - MS3057A
E - ENVIRONMENTAL
SEALING NUT

CABLE CLAMP SIZE

SHELL SIZE

THIS DRAWING IS COPYRIGHT
AND THE PROPERTY OF TURBO
INDIA. IT MUST NOT BE COPIED,
USED FOR MANUFACTURE OR
OTHERWISE DISCLOSED
WITHOUT PRIOR WRITTEN
CONSENT OF THE COMPANY.



TURBO INDIA

#114, P.C Industrial Estate Kamakshipalya,
Magadi Rd. Bangalore 560 079, Karnataka, India

DESCRIPTION :

**PART NUMBER BREAKDOWN
CIRCULAR ADAPTERS**

PART NUMBER / SERIES:
COMMON DATA

PAGE:NO
1

PART NUMBER BREAK DOWN FOR PROTECTIVE COVERS

TB 33 - 19 W - Y 5 - 03

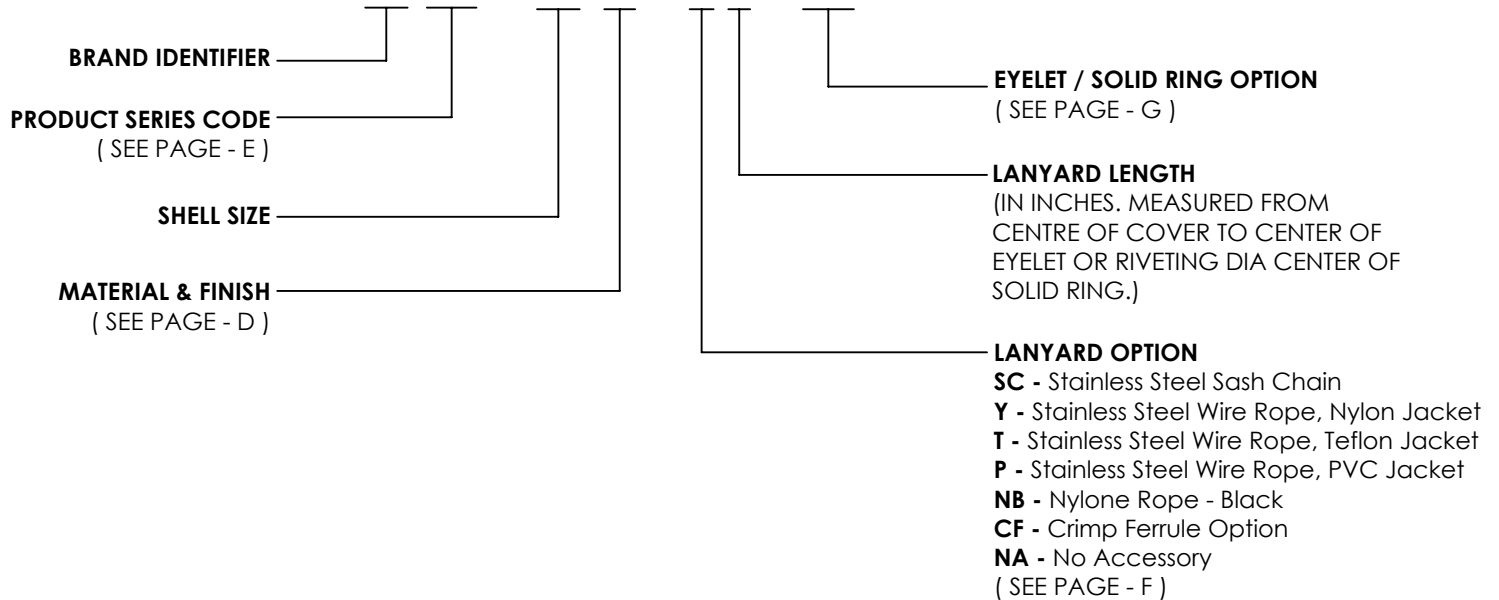

THIS DRAWING IS COPYRIGHT AND THE PROPERTY OF TURBO INDIA. IT MUST NOT BE COPIED, USED FOR MANUFACTURE OR OTHERWISE DISCLOSED WITHOUT PRIOR WRITTEN CONSENT OF THE COMPANY.



TURBO INDIA

#114, P.C Industrial Estate Kamakshipalya, Magadi Rd. Bangalore 560 079, Karnataka, India

DESCRIPTION :

**PART NUMBER BREAK DOWN
PROTECTIVE COVERS**

PART NUMBER / SERIES:

COMMON DATA

PAGE:NO

2

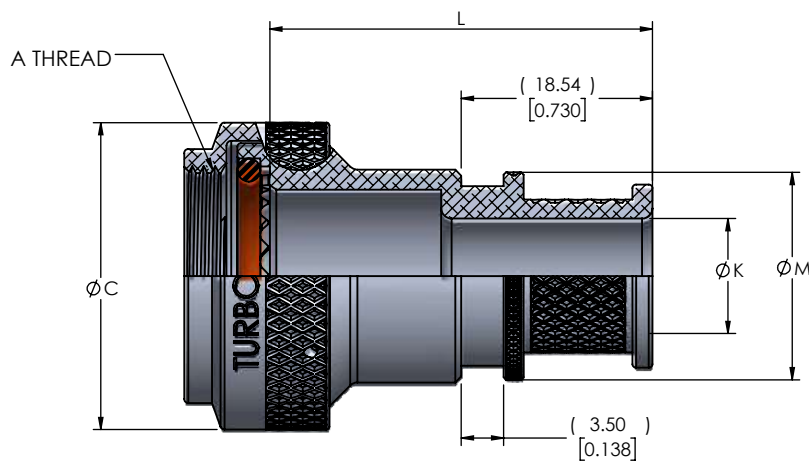

S = STRAIGHT

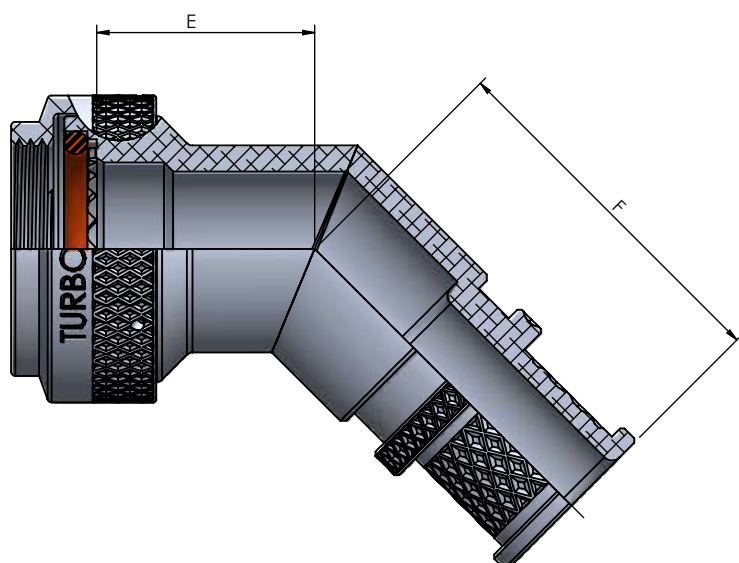

F = 45 DEGREE

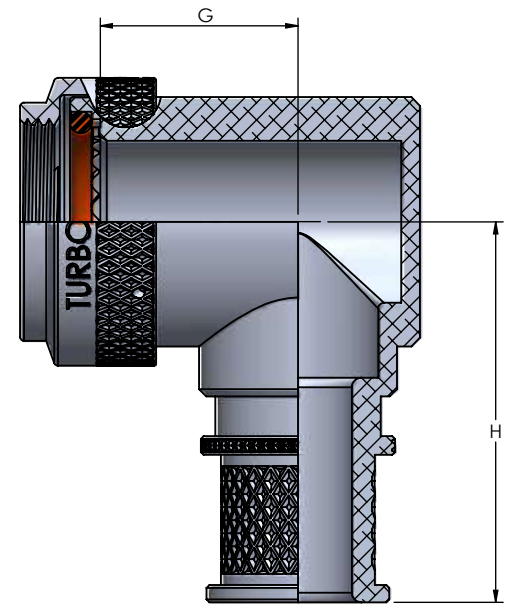

N = 90 DEGREE

ORDERING INFORMATION

TB 21 A 2 N VB - 18 07 - 8

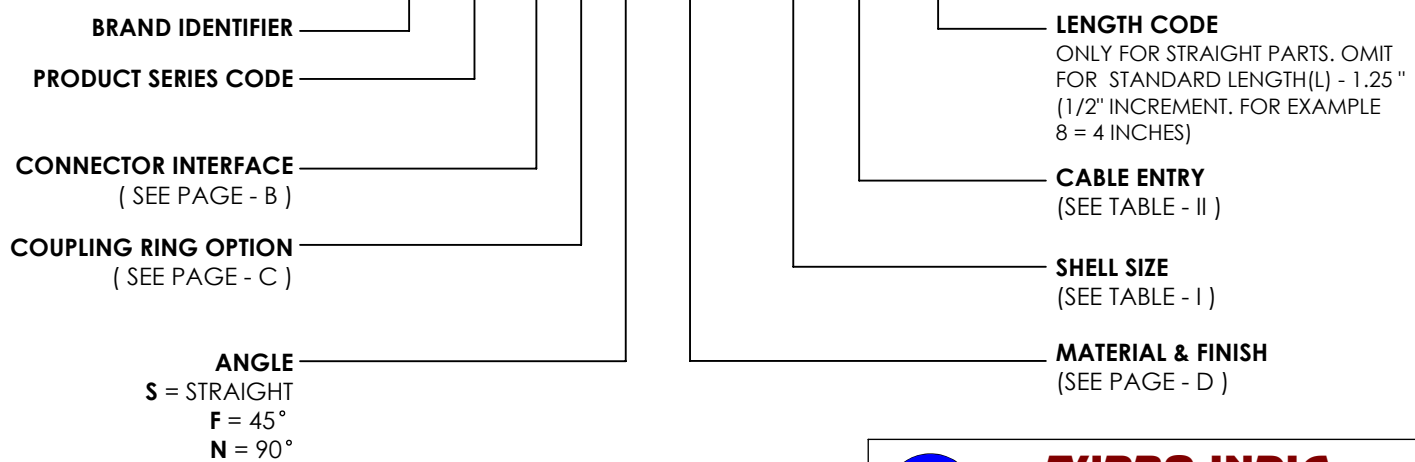

** CUSTOMISATION POSSIBLE

TURBO INDIA

#114, P.C Industrial Estate Kamakshipalya,
Magadi Rd. Bangalore 560 079, Karnataka, India

<p>THIS DRAWING IS COPYRIGHT AND THE PROPERTY OF TURBO INDIA. IT MUST NOT BE COPIED, USED FOR MANUFACTURE OR OTHERWISE DISCLOSED WITHOUT PRIOR WRITTEN CONSENT OF THE COMPANY.</p>	<p>UNLESS OTHERWISE SPECIFIED : ALL DIMENSIONS IN MILLIMETRES GENERAL TOL: LINEAR : +/-0.10MM ANGULAR : +/-2°</p>	DRAWN :	AD	DATE	30-01-2020	<p>DESCRIPTION :</p> <p style="text-align: center;">EMI/RFI - BANDING ADAPTER</p>	
		CHECKED :	AD		30-01-2020		
		APPROVED :	MR		30-01-2020		
		MATERIAL :	---	REVISION			<p>PART NUMBER / SERIES:</p> <p style="text-align: center;">SERIES 21</p>
		WEIGHT :	---		0		

TABLE - I SHELL SIZE

CONNECTOR DESIGNATOR		RING DIMENSION	ELBOW DIMENSIONS			
A & F	H	Ø C MAX	E MAX	F MAX	G MAX	H MAX
08	09	18.38	13.50	23.90	16.20	28.20
10	11	21.38	15.10	25.40	16.90	29.00
12	13	25.55	15.70	26.70	17.50	29.50
14	15	28.73	16.70	27.70	17.90	30.20
16	17	31.90	17.50	29.20	18.60	30.70
18	19	35.08	19.00	30.20	20.40	31.00
20	21	38.25	19.60	31.80	26.20	32.50
22	23	41.43	20.30	33.50	29.40	34.30
24	25	45.20	20.90	35.10	31.00	35.80
28		50.00	26.40	38.10	32.50	38.90
32		56.40	27.70	41.10	40.50	41.90
36		62.70	28.90	44.50	43.60	45.20

TABLE- II CABLE ENTRY

DASH NO	Ø K +0.10	Ø M +0.10
02	3.20	7.90
03	4.80	9.50
04	6.40	11.10
05	7.90	12.70
06	9.50	14.30
07	11.10	15.80
08	12.70	17.40
09	14.30	19.10
10	15.90	20.60
11	17.50	22.20
12	19.10	23.80
13	20.60	25.40
14	22.20	27.00
15	23.80	28.50
16	25.40	30.10
17	27.00	31.80
18	28.60	33.30
20	31.80	36.50
22	34.90	39.70
24	38.10	42.80
26	41.30	46.00
27	44.50	49.20
28	47.60	52.40
29	50.80	55.50

1. WHEN MAXIMUM CABLE ENTRY IS EXCEEDED , STYLE-2 WILL BE SUPPLIED . IN THAT CONDITION, DIMENSIONS E,F,G AND H WILL NOT APPLY.
2. FOR ANY KIND OF CUSTOMISATION ON THIS BACKSHELL, REACHOUT TO US ON sales@turboindia.co.in

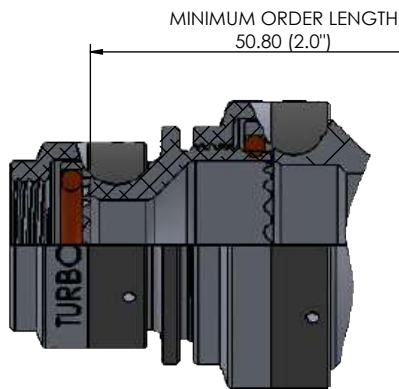

STYLE -2
STRAIGHT

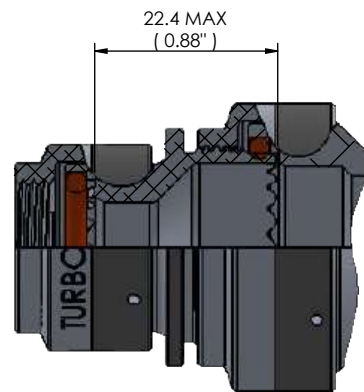

STYLE -2
45° & 90°



TURBO INDIA

#114, P.C Industrial Estate Kamakshipalya, Magadi Rd. Bangalore 560 079, Karnataka, India

THIS DRAWING IS COPYRIGHT AND THE PROPERTY OF TURBO INDIA. IT MUST NOT BE COPIED, USED FOR MANUFACTURE OR OTHERWISE DISCLOSED WITHOUT PRIOR WRITTEN CONSENT OF THE COMPANY.

UNLESS OTHERWISE SPECIFIED : ALL DIMENSIONS IN MILLIMETRES GENERAL TOL: LINEAR : +/-0.10MM ANGULAR : +/- 2°

DRAWN :	AD	DATE	30-01-2020
CHECKED :	AD		30-01-2020
APPROVED :	MR		30-01-2020
MATERIAL :	---	REVISION	0
WEIGHT :	---		

DESCRIPTION :	
EMI/RFI - BANDING ADAPTER	
PART NUMBER / SERIES:	PAGE:NO
SERIES 21	4

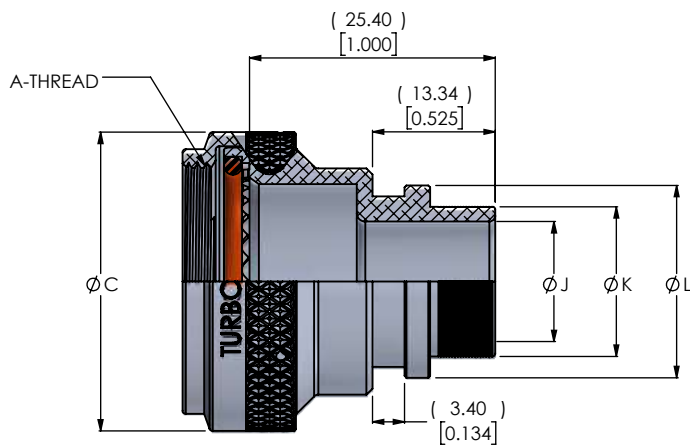

S = STRAIGHT

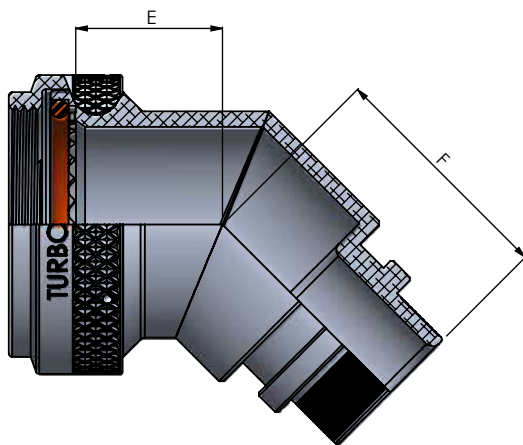

F = 45 DEGREE

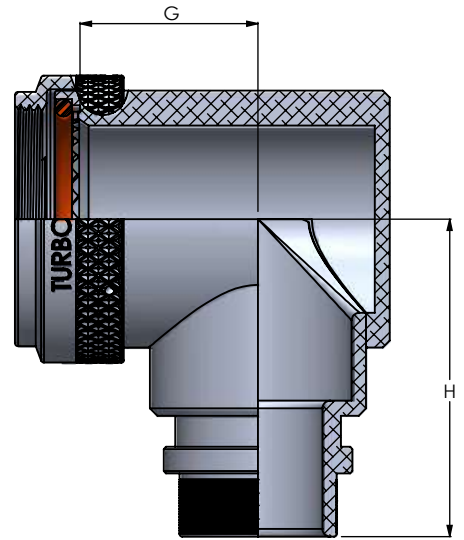

N = 90 DEGREE

ORDERING INFORMATION

TB 31 H 2 S VB - 15 10 - 8

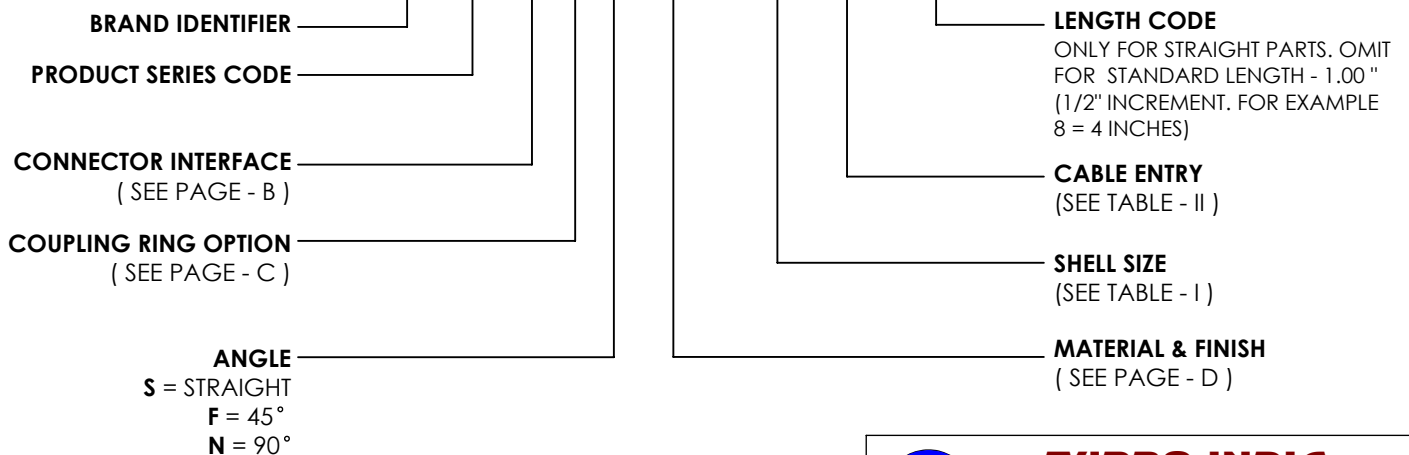

** CUSTOMIZATION POSSIBLE



TURBO INDIA

#114, P.C Industrial Estate Kamakshipalya, Magadi Rd. Bangalore 560 079, Karnataka, India

THIS DRAWING IS COPYRIGHT AND THE PROPERTY OF TURBO INDIA. IT MUST NOT BE COPIED, USED FOR MANUFACTURE OR OTHERWISE DISCLOSED WITHOUT PRIOR WRITTEN CONSENT OF THE COMPANY.

UNLESS OTHERWISE SPECIFIED : ALL DIMENSIONS IN MILLIMETRES GENERAL TOL: LINEAR : +/-0.10MM ANGULAR : +/-2°

		DATE	
DRAWN :	AD	30-01-2020	
CHECKED :	AD	30-01-2020	
APPROVED :	MR	30-01-2020	
MATERIAL :	---	REVISION	
WEIGHT :	---	0	

DESCRIPTION :	
EMI/RFI - MEMORY RING ADAPTER	
PART NUMBER / SERIES:	PAGE:NO
SERIES 31	5

TABLE - I SHELL SIZE

CONNECTOR DESIGNATOR		RING DIMENSION	ELBOW DIMENSIONS			
A & F	H	Ø C MAX	E MAX	F MAX	G MAX	H MAX
03		19.60	16.30	22.60	19.10	25.40
08	09	19.60	16.30	22.60	19.10	25.40
10	11	20.80	16.80	23.40	20.60	26.90
12	13	23.90	17.50	23.90	22.10	28.40
14	15	26.20	18.00	24.60	23.40	30.20
16	17	30.70	18.50	25.10	24.90	31.80
18	19	34.50	19.10	25.40	25.90	32.30
20	21	37.60	19.60	25.90	27.40	33.80
22	23	40.60	20.30	26.90	29.00	35.80
24	25	43.20	20.80	27.70	30.50	37.60
28		50.00	26.40	32.00	37.60	43.70
32		56.40	27.70	33.00	40.90	46.00
36		62.70	29.00	34.30	43.70	48.80
40		69.10	30.00	35.30	46.50	51.60
44		75.40	31.50	36.60	49.50	54.90
48		81.80	32.80	37.80	52.80	57.90
61		42.40	25.40	30.70	35.30	39.90

TABLE- II CABLE ENTRY

DASH NO	Ø J +0.10	Ø K MAX	Ø L MAX
04	6.40	9.50	14.50
05	7.90	11.10	16.10
06	9.50	12.70	17.70
07	11.10	14.30	19.20
08	12.70	15.90	20.80
10	15.90	19.10	24.00
12	19.10	22.20	27.20
14	22.20	25.40	30.40
16	25.40	28.60	33.50
18	28.60	31.80	36.70
20	31.80	34.90	39.90
22	34.90	38.10	43.10
24	38.10	41.20	46.20

1. WHEN MAXIMUM CABLE ENTRY IS EXCEEDED , STYLE-2 WILL BE SUPPLIED . IN THAT CONDITION, DIMENSIONS E,F,G AND H WILL NOT APPLY.
2. FOR ANY KIND OF CUSTOMISATION ON THIS BACKSHELL, FOR TERMINATION BANDS AND OTHER ACCESSORIES REACHOUT TO US ON sales@turboindia.co.in

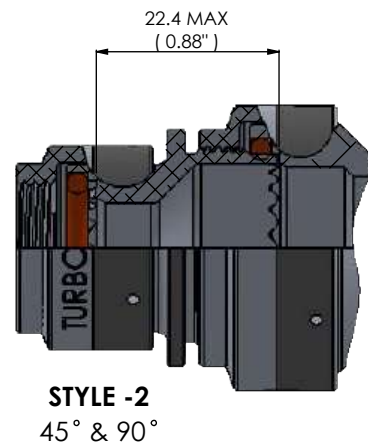
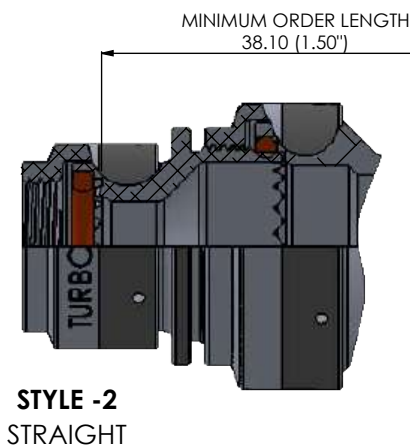

TURBO INDIA

#114, P.C Industrial Estate Kamakshipalya,
Magadi Rd. Bangalore 560 079, Karnataka, India

THIS DRAWING IS COPYRIGHT AND THE PROPERTY OF TURBO INDIA. IT MUST NOT BE COPIED, USED FOR MANUFACTURE OR OTHERWISE DISCLOSED WITHOUT PRIOR WRITTEN CONSENT OF THE COMPANY.

UNLESS OTHERWISE SPECIFIED :
ALL DIMENSIONS IN MILLIMETRES
GENERAL TOL:
LINEAR : +/-0.10MM
ANGULAR : +/- 2°

DRAWN :	AD	DATE	30-01-2020
CHECKED :	AD		30-01-2020
APPROVED :	MR		30-01-2020
MATERIAL :	---	REVISION	0
WEIGHT :	---		

DESCRIPTION :	
EMI/RFI - MEMORY RING ADAPTER	
PART NUMBER / SERIES:	PAGE:NO
SERIES 31	6

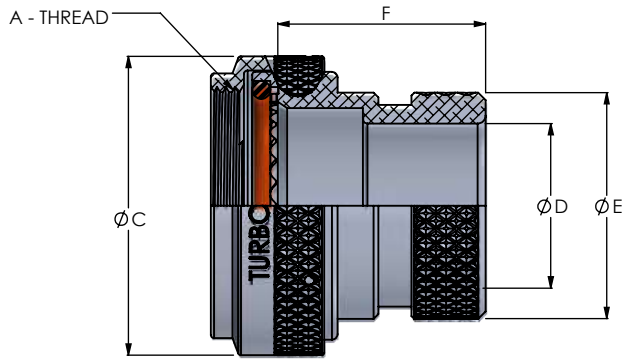

S = STRAIGHT

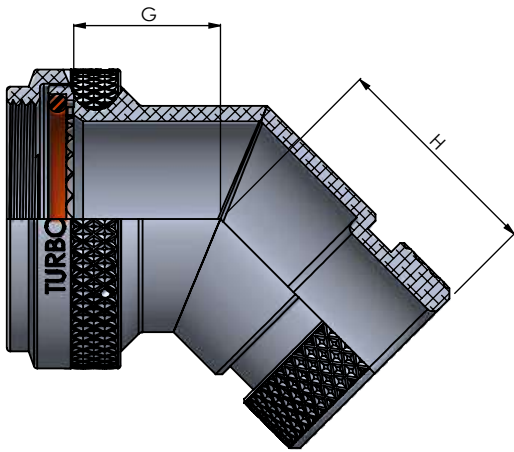

F = 45 DEGREE

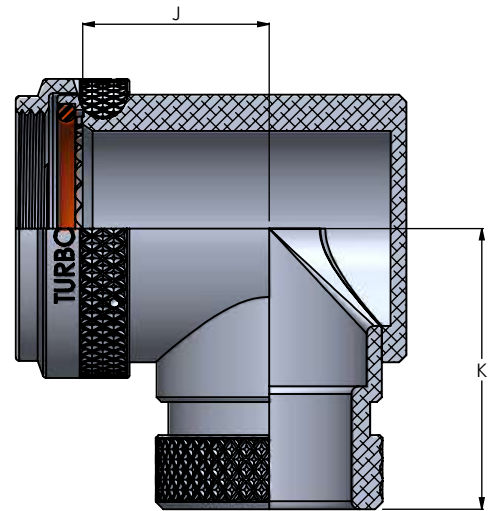

N = 90 DEGREE

ORDERING INFORMATION

TB 41 H 2 S VO - 11

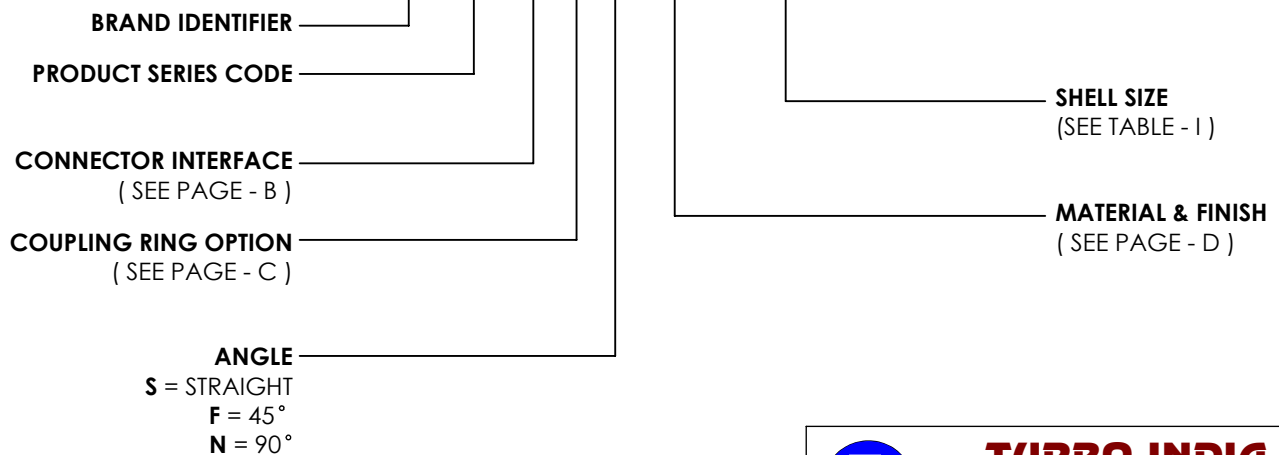

**** CUSTOMIZATION POSSIBLE**



TURBO INDIA

#114, P.C Industrial Estate Kamakshipalya,
Magadi Rd. Bangalore 560 079, Karnataka, India

THIS DRAWING IS COPYRIGHT AND THE PROPERTY OF TURBO INDIA. IT MUST NOT BE COPIED, USED FOR MANUFACTURE OR OTHERWISE DISCLOSED WITHOUT PRIOR WRITTEN CONSENT OF THE COMPANY.

UNLESS OTHERWISE SPECIFIED :
ALL DIMENSIONS IN MILLIMETRES
GENERAL TOL:
LINEAR : +/-0.10MM
ANGULAR : +/- 2°

		DATE
DRAWN :	AD	30-01-2020
CHECKED :	AD	30-01-2020
APPROVED :	MR	30-01-2020
MATERIAL :	---	REVISION
WEIGHT :	---	0

DESCRIPTION :

O-RING SEALED SHRINK BOOT ADAPTER

PART NUMBER / SERIES:
SERIES 41

PAGE:NO
7

TABLE - I SHELL SIZE										
CONNECTOR DESIGNATOR		RING DIMENSION	ENTRY DIMENSIONS				ELBOW DIMENSIONS			
A & F	H	Ø C MAX	Ø D MIN	Ø E MAX	F MAX	G MAX	H MAX	J MAX	K MAX	
08	09	19.60	6.40	13.50	23.90	16.20	20.60	19.10	23.40	
10	11	20.80	9.00	15.40	23.90	16.90	21.30	20.60	24.90	
12	13	23.90	12.50	19.70	23.90	17.50	21.80	22.10	26.40	
14	15	26.20	14.40	21.30	23.90	17.90	22.60	23.40	28.20	
16	17	30.70	17.50	24.50	23.90	18.60	23.10	24.90	29.70	
18	19	34.50	19.50	26.50	23.90	19.00	23.40	25.90	30.20	
20	21	37.60	22.70	30.90	23.90	19.60	23.90	27.40	31.80	
22	23	40.60	25.90	34.40	23.90	20.30	24.90	29.00	33.80	
24	25	43.20	28.80	36.70	23.90	20.90	25.70	30.50	35.60	
28		50.00	34.80	43.40	23.90	26.40	30.00	37.60	41.70	
32		56.40	41.00	48.70	25.50	27.70	34.80	40.90	47.80	

*** FOR ANY KIND OF CUSTOMISATION ON THIS BACKSHELL, FOR TERMINATION BANDS AND OTHER ACCESSORIES REACHOUT TO US ON sales@turboindia.co.in



TURBO INDIA

#114, P.C Industrial Estate Kamakshipalya,
Magadi Rd. Bangalore 560 079, Karnataka, India

DATE

30-01-2020

DRAWN : AD

CHECKED : AD

APPROVED : MR

MATERIAL : ---

WEIGHT : ---

REVISION

0

DESCRIPTION :

O - RING SEALED SHRINK BOOT ADAPTER

PART NUMBER / SERIES:

SERIES 41

PAGE:NO

8

THIS DRAWING IS COPYRIGHT AND THE PROPERTY OF TURBO INDIA. IT MUST NOT BE COPIED, USED FOR MANUFACTURE OR OTHERWISE DISCLOSED WITHOUT PRIOR WRITTEN CONSENT OF THE COMPANY.

UNLESS OTHERWISE SPECIFIED :
ALL DIMENSIONS IN MILLIMETRES
GENERAL TOL:
LINEAR : +/-0.10MM
ANGULAR : +/- 2 °

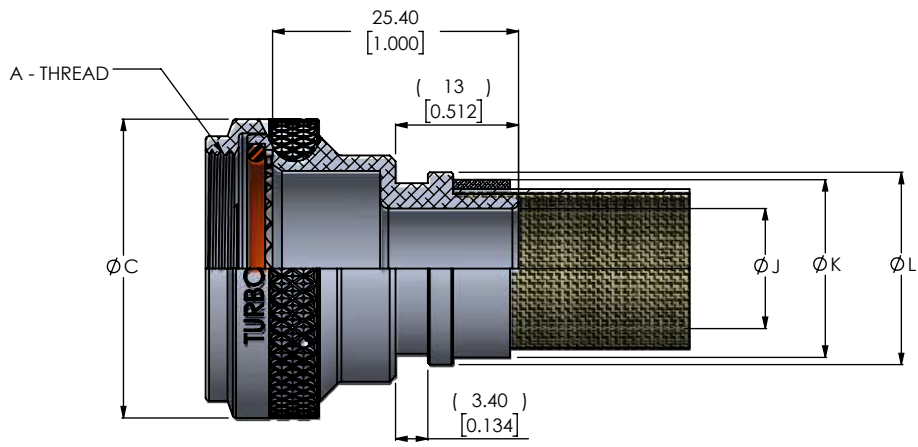

S = STRAIGHT

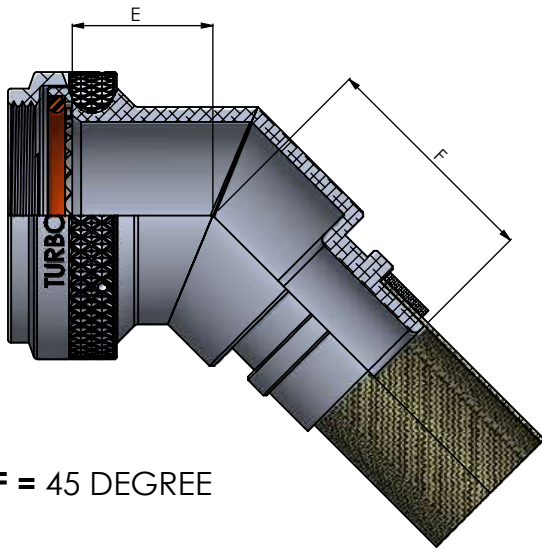

F = 45 DEGREE

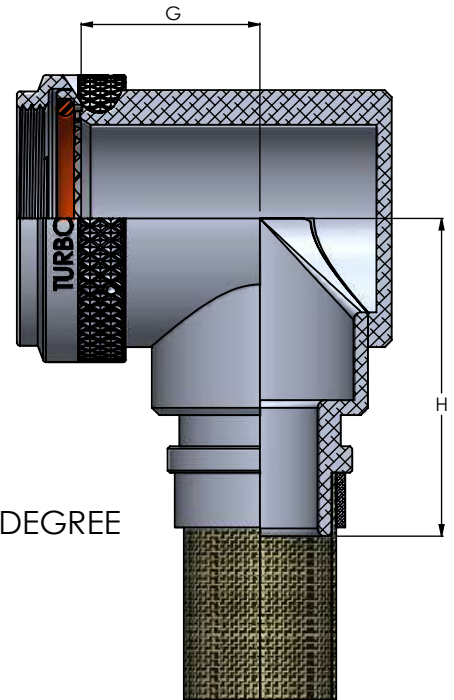

N = 90 DEGREE

ORDERING INFORMATION

TB 51 H 2 F VB - 17 08 - 8

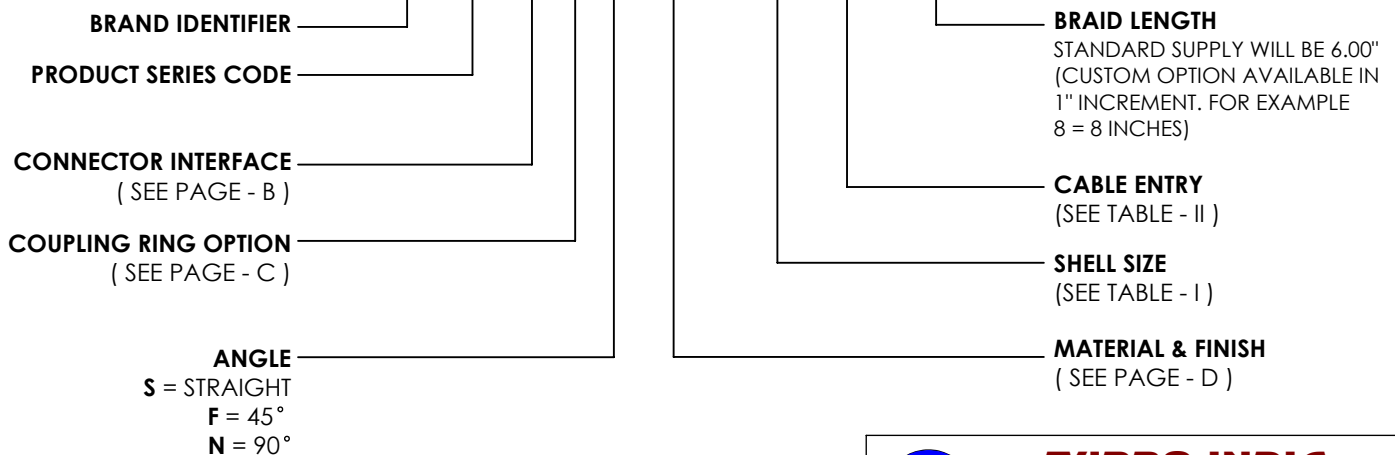

** CUSTOMIZATION POSSIBLE



TURBO INDIA

#114, P.C Industrial Estate Kamakshipalya,
Magadi Rd. Bangalore 560 079, Karnataka, India

THIS DRAWING IS COPYRIGHT AND THE PROPERTY OF TURBO INDIA. IT MUST NOT BE COPIED, USED FOR MANUFACTURE OR OTHERWISE DISCLOSED WITHOUT PRIOR WRITTEN CONSENT OF THE COMPANY.

UNLESS OTHERWISE SPECIFIED :
ALL DIMENSIONS IN MILLIMETRES
GENERAL TOL:
LINEAR : +/-0.10MM
ANGULAR : +/-2°

		DATE	
DRAWN :	AD	30-01-2020	
CHECKED :	AD	30-01-2020	
APPROVED :	MR	30-01-2020	
MATERIAL :	---	REVISION	
WEIGHT :	---	0	

DESCRIPTION :

SHIELD SOCK - SHRINK BOOT ADAPTER

PART NUMBER / SERIES:
SERIES 51

PAGE:NO
9

TABLE - I SHELL SIZE

CONNECTOR DESIGNATOR		RING DIMENSION	ELBOW DIMENSIONS			
A & F	H	Ø C MAX	E MAX	F MAX	G MAX	H MAX
08	09	19.60	11.60	43.40	12.70	43.90
10	11	20.80	13.20	45.00	15.10	47.00
12	13	23.90	14.80	46.50	15.50	47.50
14	15	26.20	16.40	48.80	17.80	49.30
16	17	30.70	18.70	51.60	22.50	51.60
18	19	34.50	23.50	56.40	24.80	55.90
20	21	37.60	23.50	56.40	24.80	55.90
22	23	40.60	25.90	60.20	28.60	58.70
24	25	43.20	25.90	60.20	28.60	58.70
28		50.00	29.10	61.50	31.10	63.0
32		56.40	30.70	64.0	40.00	69.30
36		62.70	31.40	66.30	45.10	69.30

TABLE- II CABLE ENTRY

DASH NO	Ø J +0.10	Ø K MAX	Ø L MAX
03	4.80	13.60	12.90
04	6.40	13.60	14.50
05	7.90	13.60	16.10
06	9.50	18.40	17.70
07	11.10	18.40	19.20
08	12.70	18.40	20.80
09	14.30	18.40	22.40
10	15.90	24.70	24.00
11	17.50	24.70	25.60
12	19.10	24.70	27.20
14	22.20	31.10	30.40
13	23.80	31.10	31.90
16	25.40	31.10	33.50
20	31.80	42.50	39.90
24	38.10	42.50	46.20

1. WHEN MAXIMUM CABLE ENTRY IS EXCEEDED , STYLE-2 WILL BE SUPPLIED . IN THAT CONDITION, DIMENSIONS E,F,G AND H WILL NOT APPLY.
2. FOR ANY KIND OF CUSTOMISATION ON THIS BACKSHELL, FOR TERMINATION BANDS AND OTHER ACCESSORIES REACHOUT TO US ON sales@turboindia.co.in

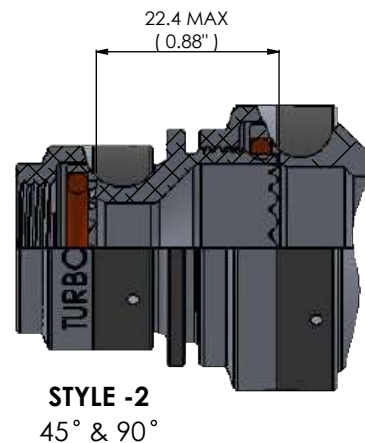
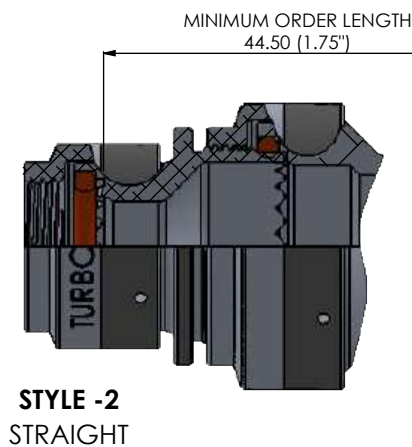

TURBO INDIA

#114, P.C Industrial Estate Kamakshipalya,
Magadi Rd. Bangalore 560 079, Karnataka, India

THIS DRAWING IS COPYRIGHT AND THE PROPERTY OF TURBO INDIA. IT MUST NOT BE COPIED, USED FOR MANUFACTURE OR OTHERWISE DISCLOSED WITHOUT PRIOR WRITTEN CONSENT OF THE COMPANY.

UNLESS OTHERWISE SPECIFIED :
ALL DIMENSIONS IN MILLIMETRES
GENERAL TOL:
LINEAR : +/-0.10MM
ANGULAR : +/- 2°

	DATE
DRAWN : AD	30-01-2020
CHECKED : AD	30-01-2020
APPROVED : MR	30-01-2020
MATERIAL : ---	REVISION
WEIGHT : ---	0

DESCRIPTION :

SHIELD SOCK - SHRINK BOOT ADAPTER

PART NUMBER / SERIES:
SERIES 51

PAGE:NO
10

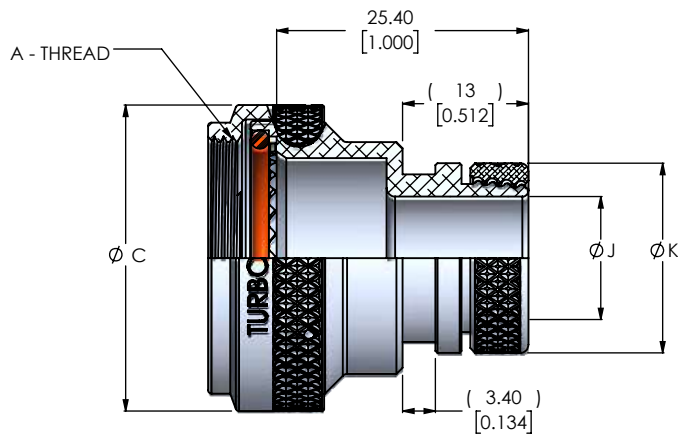

S = STRAIGHT

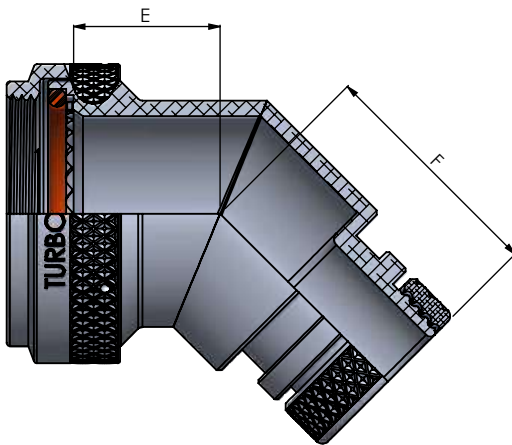

F = 45 DEGREE

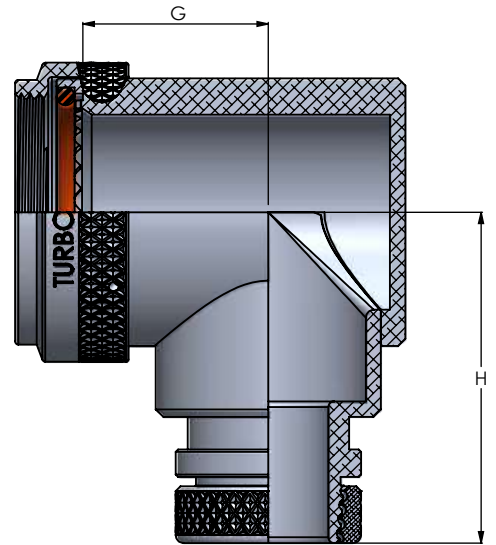

N = 90 DEGREE

ORDERING INFORMATION

TB 61 H 2 S VB - 17 08 - 8

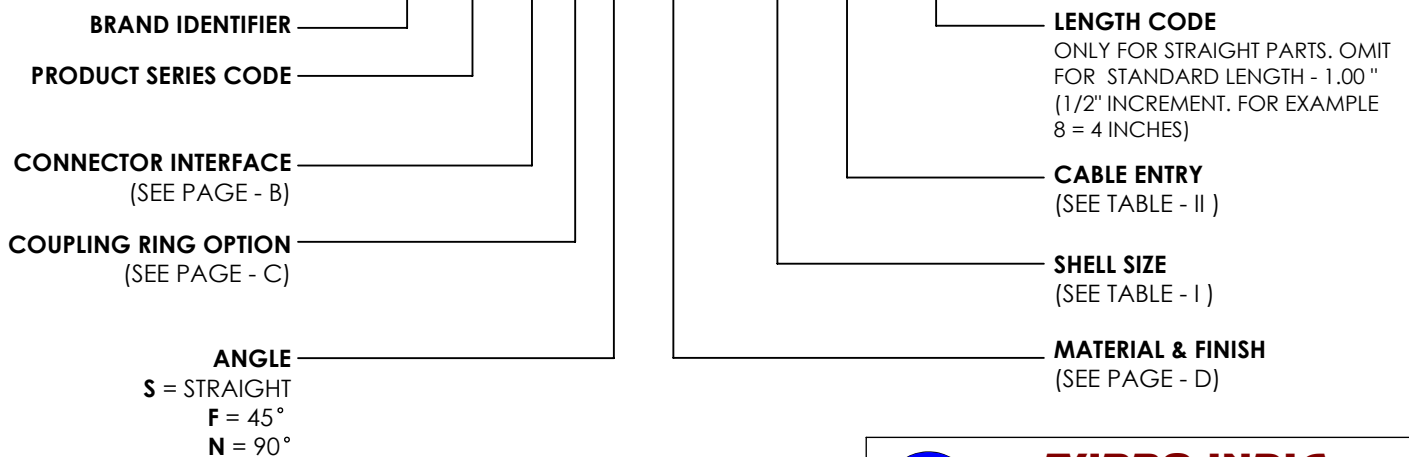

**** CUSTOMIZATION POSSIBLE**



TURBO INDIA

#114, P.C Industrial Estate Kamakshipalya, Magadi Rd. Bangalore 560 079, Karnataka, India

THIS DRAWING IS COPYRIGHT AND THE PROPERTY OF TURBO INDIA. IT MUST NOT BE COPIED, USED FOR MANUFACTURE OR OTHERWISE DISCLOSED WITHOUT PRIOR WRITTEN CONSENT OF THE COMPANY.

UNLESS OTHERWISE SPECIFIED : ALL DIMENSIONS IN MILLIMETRES GENERAL TOL: LINEAR : +/-0.10MM ANGULAR : +/- 2°

		DATE
DRAWN :	AD	30-01-2020
CHECKED :	AD	30-01-2020
APPROVED :	MR	30-01-2020
MATERIAL :	---	REVISION
WEIGHT :	---	0

DESCRIPTION :	
EMI /RFI - LAMP BASE THREAD ADAPTER	
PART NUMBER / SERIES:	PAGE:NO
SERIES 61	11

TABLE - I SHELL SIZE

CONNECTOR DESIGNATOR		RING DIMENSION	ELBOW DIMENSIONS			
A & F	H	Ø C MAX	E MAX	F MAX	G MAX	H MAX
08	09	19.60	11.60	41.40	12.70	41.70
10	11	20.80	13.20	42.90	15.10	44.70
12	13	23.90	14.80	44.50	15.50	45.20
14	15	26.20	16.40	46.70	17.80	47.00
16	17	30.70	18.70	49.50	22.50	49.30
18	19	34.50	23.50	54.40	24.80	53.60
20	21	37.60	23.50	54.40	24.80	53.60
22	23	40.60	25.90	58.20	28.60	56.40
24	25	43.20	25.90	58.20	28.60	56.40
28		50.00	29.10	59.40	31.10	60.70
32		56.40	30.70	62.00	40.00	67.10
36		62.70	31.40	64.30	45.10	67.10

TABLE- II CABLE ENTRY

DASH NO	Ø J MAX	Ø K MAX
03	3.20	11.40
04	6.40	13.10
06	9.50	16.30
08	12.70	19.40
10	15.90	23.40
12	19.10	25.80
14	22.20	29.00
16	25.40	32.10
18	28.60	36.40
20	31.80	38.50
22	34.90	41.70
24	38.10	44.80
27	44.50	51.20

1. WHEN MAXIMUM CABLE ENTRY IS EXCEEDED , STYLE-2 WILL BE SUPPLIED . IN THAT CONDITION, DIMENSIONS E,F,G AND H WILL NOT APPLY.
2. FOR ANY KIND OF CUSTOMISATION ON THIS BACKSHELL, FOR TERMINATION BANDS AND OTHER ACCESSORIES REACHOUT TO US ON sales@turboindia.co.in

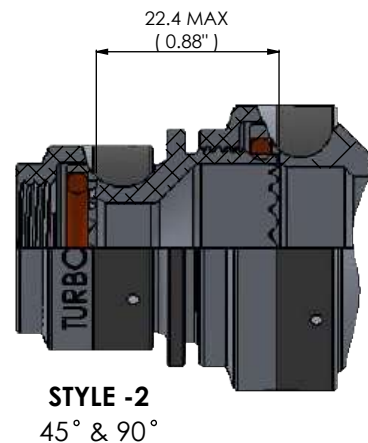
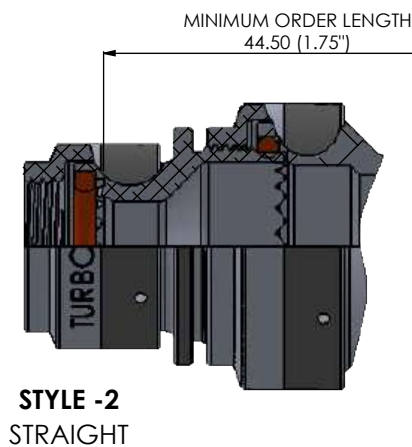

TURBO INDIA

#114, P.C Industrial Estate Kamakshipalya,
Magadi Rd. Bangalore 560 079, Karnataka, India

THIS DRAWING IS COPYRIGHT AND THE PROPERTY OF TURBO INDIA. IT MUST NOT BE COPIED, USED FOR MANUFACTURE OR OTHERWISE DISCLOSED WITHOUT PRIOR WRITTEN CONSENT OF THE COMPANY.

UNLESS OTHERWISE SPECIFIED :
ALL DIMENSIONS IN MILLIMETRES
GENERAL TOL:
LINEAR : +/-0.10MM
ANGULAR : +/- 2°

	DATE
DRAWN : AD	30-01-2020
CHECKED : AD	30-01-2020
APPROVED : MR	30-01-2020
MATERIAL : ---	REVISION
WEIGHT : ---	0

DESCRIPTION : EMI/RFI - LAMP BASE THREAD ADAPTER	
PART NUMBER / SERIES: SERIES 61	PAGE:NO 12

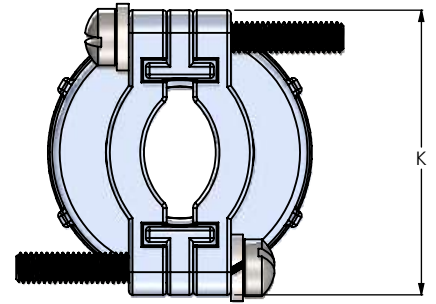
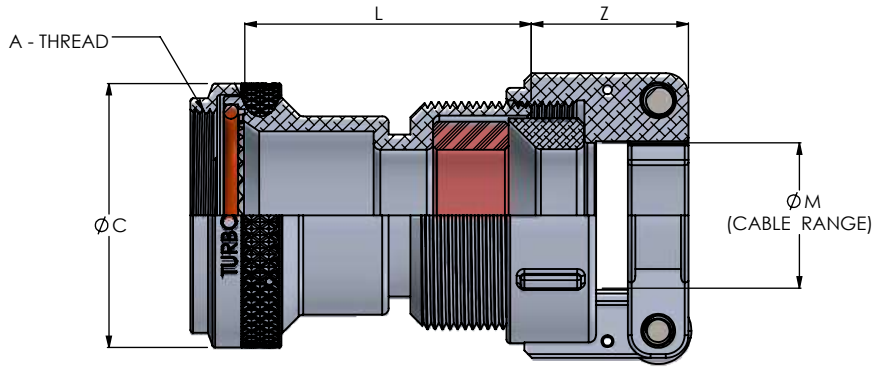

S = STRAIGHT

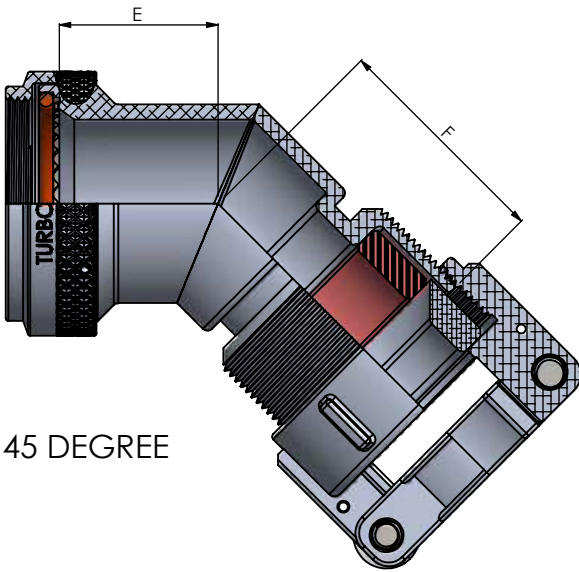

F = 45 DEGREE

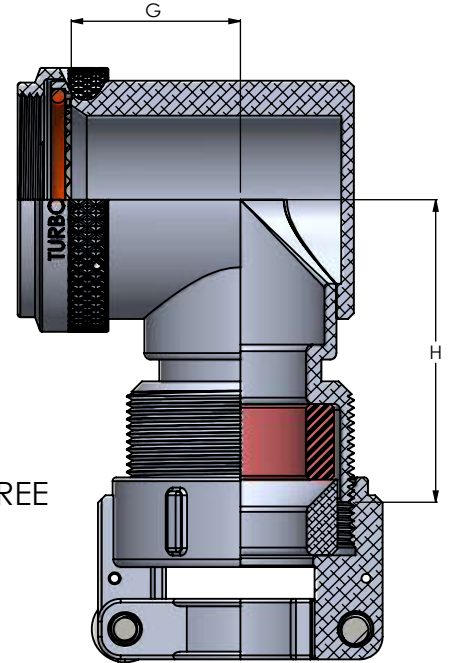

N = 90 DEGREE

ORDERING INFORMATION

TB 110-01 H 3 N VB - 15 08 - A - 6

- BRAND IDENTIFIER
- PRODUCT SERIES CODE
(SEE PAGE - A)
- CONNECTOR INTERFACE
(SEE PAGE - B)
- COUPLING RING OPTION
(SEE PAGE - C)
- ANGLE
S = STRAIGHT
F = 45°
N = 90°
- MATERIAL & FINISH
(SEE PAGE - D)

- LENGTH CODE
ONLY FOR STRAIGHT PARTS. OMIT FOR STANDARD LENGTH (L) - 1.50" (1/2" INCREMENT. FOR EXAMPLE 6 = 3 INCHES)
- CABLE CLAMP TYPE
A - MS3057A
- CABLE CLAMP SIZE
(SEE TABLE - II)
- SHELL SIZE
(SEE TABLE - I)

**** CUSTOMIZATION POSSIBLE**



TURBO INDIA

#114, P.C Industrial Estate Kamakshipalya, Magadi Rd. Bangalore 560 079, Karnataka, India

THIS DRAWING IS COPYRIGHT AND THE PROPERTY OF TURBO INDIA. IT MUST NOT BE COPIED, USED FOR MANUFACTURE OR OTHERWISE DISCLOSED WITHOUT PRIOR WRITTEN CONSENT OF THE COMPANY.

UNLESS OTHERWISE SPECIFIED : ALL DIMENSIONS IN MILLIMETRES GENERAL TOL: LINEAR : +/-0.10MM ANGULAR : +/-2°

DRAWN :	AD	DATE	30-01-2020
CHECKED :	AD		30-01-2020
APPROVED :	MR		30-01-2020
MATERIAL :	---	REVISION	
WEIGHT :	---		0

DESCRIPTION : SUBMERSIBLE CABLE CLAMP ADAPTER - ENVIRONMENTAL , NON SCREENED	
PART NUMBER / SERIES: SERIES 110 -01	PAGE:NO 13

TABLE - I SHELL SIZE						
CONNECTOR DESIGNATOR		RING DIMENSION	ELBOW DIMENSIONS			
A & F	H	Ø C MAX	E MAX	F MAX	G MAX	H MAX
08	09	19.60	11.60	27.40	12.70	34.30
10	11	20.80	13.20	28.20	15.10	36.10
12	13	23.90	14.80	28.70	15.50	37.60
14	15	26.20	16.40	29.50	17.80	39.10
16	17	30.70	18.70	30.20	22.50	40.60
18	19	34.50	23.50	30.50	24.80	41.40
20	21	37.60	23.50	31.00	24.80	43.20
22	23	40.60	25.90	31.80	28.60	44.70
24	25	43.20	25.90	32.50	28.60	46.20
28		50.00	29.10	33.00	31.10	47.80
32		56.40	30.70	34.30	40.00	51.10
36		62.70	31.40	35.30	45.10	53.30

TABLE- II CABLE CLAMP SIZE				
DASH NO	Ø M MIN	Ø M MAX	K MAX	Z MAX
04	4.80	7.90	23.00	20.20
06	7.10	11.10	27.80	21.80
08	9.80	14.30	30.10	23.40
10	9.50	15.90	32.50	23.40
12	11.10	19.10	38.10	23.40
16	15.90	23.80	43.70	25.80
20	22.20	31.80	52.40	25.80
24	25.40	34.90	58.70	25.80

1. WHEN MAXIMUM CABLE ENTRY IS EXCEEDED , STYLE-2 WILL BE SUPPLIED . IN THAT CONDITION, DIMENSIONS E,F,G AND H WILL NOT APPLY.
2. FOR ANY KIND OF CUSTOMISATION ON THIS BACKSHELL, FOR TERMINATION BANDS AND OTHER ACCESSORIES REACHOUT TO US ON sales@turboindia.co.in

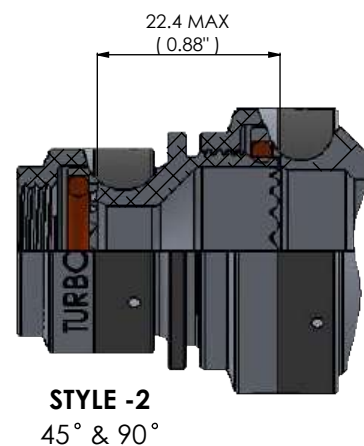
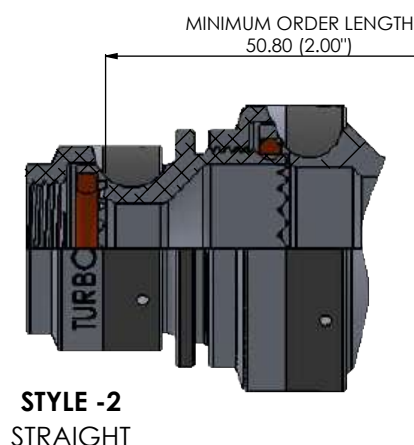

TURBO INDIA

#114, P.C Industrial Estate Kamakshipalya,
Magadi Rd. Bangalore 560 079, Karnataka, India

THIS DRAWING IS COPYRIGHT AND THE PROPERTY OF TURBO INDIA. IT MUST NOT BE COPIED, USED FOR MANUFACTURE OR OTHERWISE DISCLOSED WITHOUT PRIOR WRITTEN CONSENT OF THE COMPANY.

UNLESS OTHERWISE SPECIFIED :
ALL DIMENSIONS IN MILLIMETRES
GENERAL TOL:
LINEAR : +/-0.10MM
ANGULAR : +/- 2°

	DATE
DRAWN : AD	30-01-2020
CHECKED : AD	30-01-2020
APPROVED : MR	30-01-2020
MATERIAL : ---	REVISION
WEIGHT : ---	0

DESCRIPTION : SUBMERSIBLE CABLE CLAMP ADAPTER - ENVIRONMENTAL , NON SCREENED	
PART NUMBER / SERIES: SERIES 110-01	PAGE:NO 14

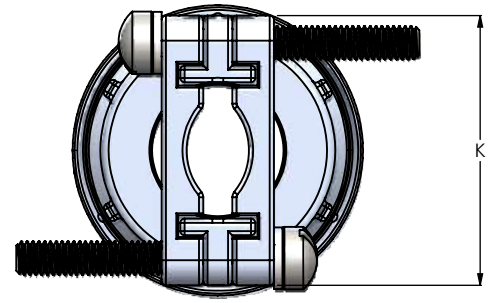
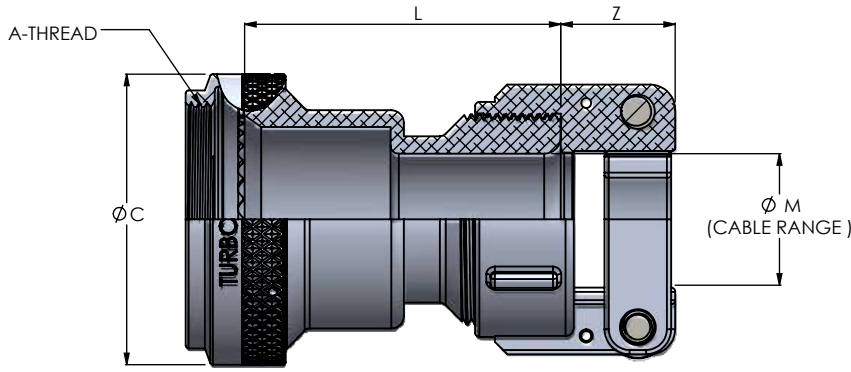

S = STRAIGHT

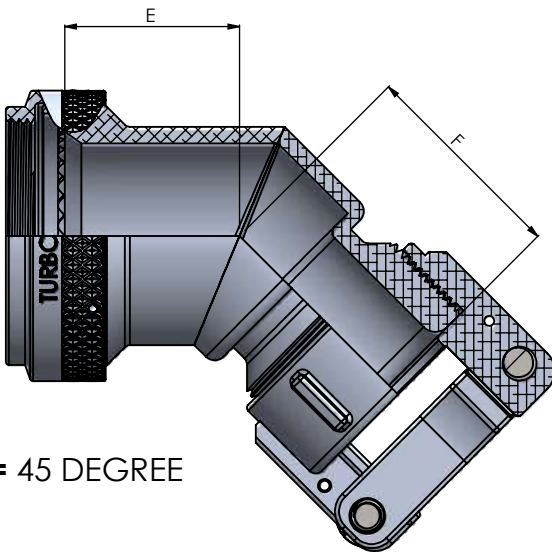

F = 45 DEGREE

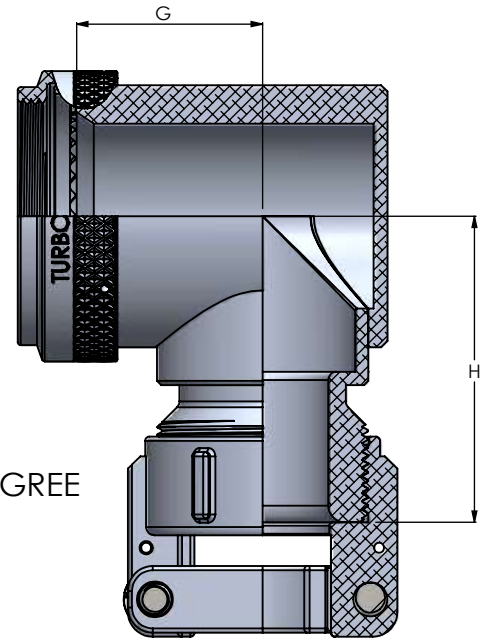

N = 90 DEGREE

ORDERING INFORMATION

TB 110-02 A 3 N VO - 19 09 - A - 6

BRAND IDENTIFIER

PRODUCT SERIES CODE
(SEE PAGE - A)

CONNECTOR INTERFACE
(SEE PAGE - B)

COUPLING RING OPTION
(SEE PAGE - C)

ANGLE
S = STRAIGHT
F = 45°
N = 90°

MATERIAL & FINISH
(SEE PAGE - D)

LENGTH CODE
ONLY FOR STRAIGHT PARTS. OMIT FOR STANDARD LENGTH (L) - 1.50" (1/2" INCREMENT. FOR EXAMPLE 6 = 3 INCHES)

CABLE CLAMP TYPE
A - MS3057A

CABLE CLAMP SIZE
(SEE TABLE - II)

SHELL SIZE
(SEE TABLE - I)

**** CUSTOMIZATION POSSIBLE**



TURBO INDIA

#114, P.C Industrial Estate Kamakshipalya, Magadi Rd. Bangalore 560 079, Karnataka, India

THIS DRAWING IS COPYRIGHT AND THE PROPERTY OF TURBO INDIA. IT MUST NOT BE COPIED, USED FOR MANUFACTURE OR OTHERWISE DISCLOSED WITHOUT PRIOR WRITTEN CONSENT OF THE COMPANY.

UNLESS OTHERWISE SPECIFIED :
ALL DIMENSIONS IN MILLIMETRES
GENERAL TOL:
LINEAR : +/-0.10MM
ANGULAR : +/- 2°

DRAWN :	AD	DATE	30-01-2020
CHECKED :	AD		30-01-2020
APPROVED :	MR		30-01-2020
MATERIAL :	---	REVISION	
WEIGHT :	---		0

DESCRIPTION :	
CABLE CLAMP ADAPTER - NON ENVIRONMENTAL , NON SCREENED	
PART NUMBER / SERIES:	PAGE:NO
SERIES 110-02	15

TABLE - I SHELL SIZE						
CONNECTOR DESIGNATOR		RING DIMENSION	ELBOW DIMENSIONS			
A & F	H	Ø C MAX	E MAX	F MAX	G MAX	H MAX
08	09	19.60	11.60	22.40	12.70	29.70
10	11	20.80	13.20	23.10	15.10	31.20
12	13	23.90	14.80	23.60	15.50	32.80
14	15	26.20	16.40	24.40	17.80	34.30
16	17	30.70	18.70	24.90	22.50	36.10
18	19	34.50	23.50	25.40	24.80	36.80
20	21	37.60	23.50	25.90	24.80	38.40
22	23	40.60	25.90	26.70	28.60	39.90
24	25	43.20	25.90	27.20	28.60	41.40
28		50.00	29.10	27.90	31.10	43.20
32		56.40	30.70	29.20	40.00	46.20
36		62.70	31.40	30.20	45.10	48.80

TABLE- II CABLE CLAMP SIZE				
DASH NO	Ø M MIN	Ø M MAX	K MAX	Z MAX
04	4.80	7.90	23.00	11.50
06	7.10	11.10	27.80	13.10
08	9.80	14.30	30.10	14.70
10	9.50	15.90	32.50	14.70
12	11.10	19.10	38.10	14.70
16	15.90	23.80	43.70	17.10
20	22.20	31.80	52.40	17.10
24	25.40	34.90	58.70	17.10

1. WHEN MAXIMUM CABLE ENTRY IS EXCEEDED , STYLE-2 WILL BE SUPPLIED . IN THAT CONDITION, DIMENSIONS E,F,G AND H WILL NOT APPLY.
2. FOR ANY KIND OF CUSTOMISATION ON THIS BACKSHELL, FOR TERMINATION BANDS AND OTHER ACCESSORIES REACHOUT TO US ON sales@turboindia.co.in

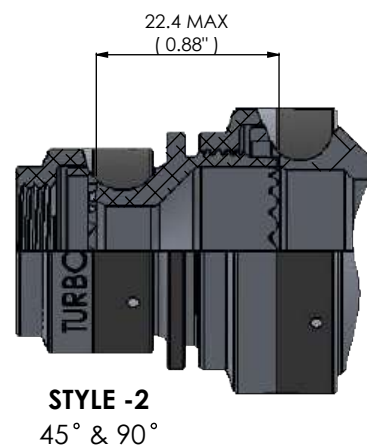
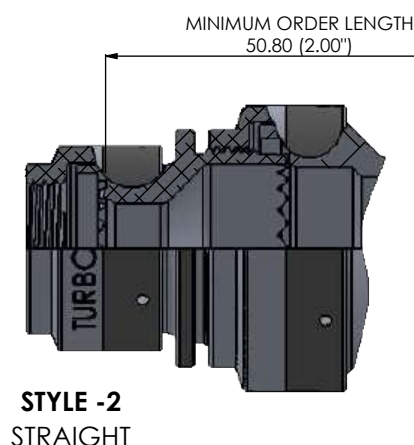

 TURBO INDIA #114, P.C Industrial Estate Kamakshipalya, Magadi Rd. Bangalore 560 079, Karnataka, India	DATE	30-01-2020	DESCRIPTION :	PART NUMBER / SERIES:	PAGE:NO	
	DRAWN :	AD				CABLE CLAMP ADAPTER -
	CHECKED :	AD				NON ENVIRONMENTAL , NON SCREENED
	APPROVED :	MR	30-01-2020	REVISION	SERIES 110-02	16
	MATERIAL :	---	0			
	WEIGHT :	---				

THIS DRAWING IS COPYRIGHT AND THE PROPERTY OF TURBO INDIA. IT MUST NOT BE COPIED, USED FOR MANUFACTURE OR OTHERWISE DISCLOSED WITHOUT PRIOR WRITTEN CONSENT OF THE COMPANY.

UNLESS OTHERWISE SPECIFIED :
 ALL DIMENSIONS IN MILLIMETRES
 GENERAL TOL:
 LINEAR : +/-0.10MM
 ANGULAR : +/- 2°

DRAWN :	AD	30-01-2020
CHECKED :	AD	30-01-2020
APPROVED :	MR	30-01-2020
MATERIAL :	---	REVISION
WEIGHT :	---	0

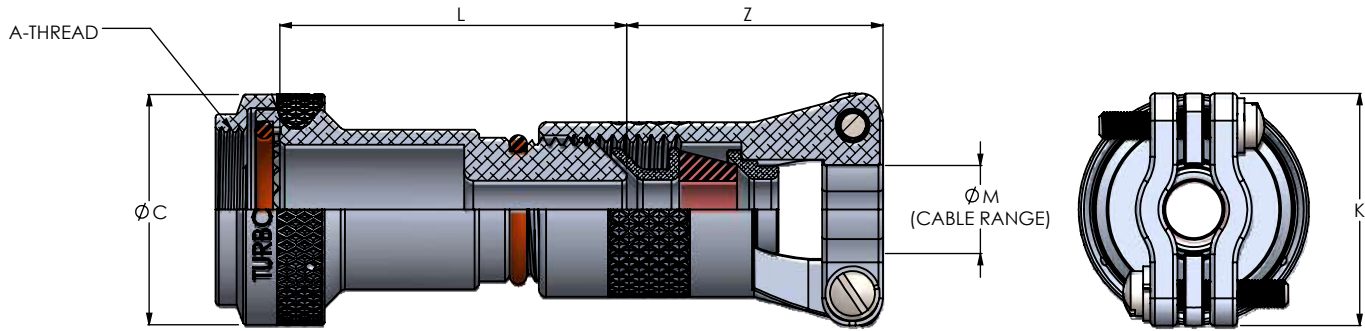

S = STRAIGHT

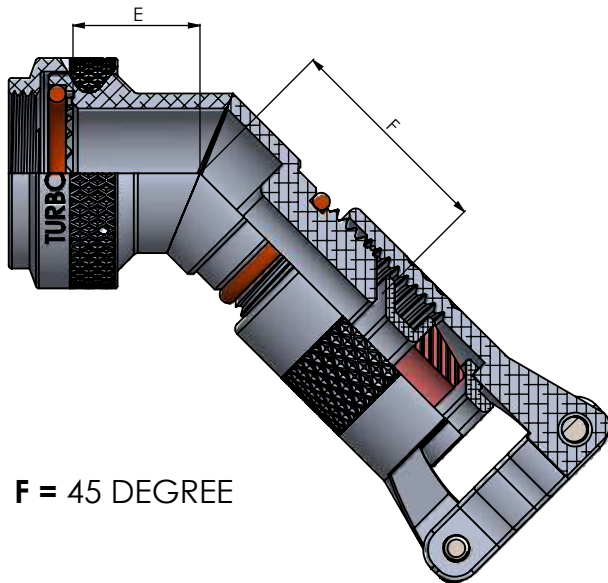

F = 45 DEGREE

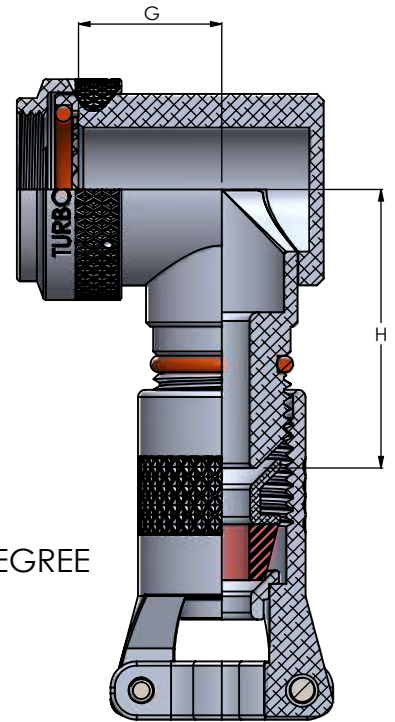

N = 90 DEGREE

ORDERING INFORMATION

TB 110-03 H 3 F VO - 13 04 - L - 6

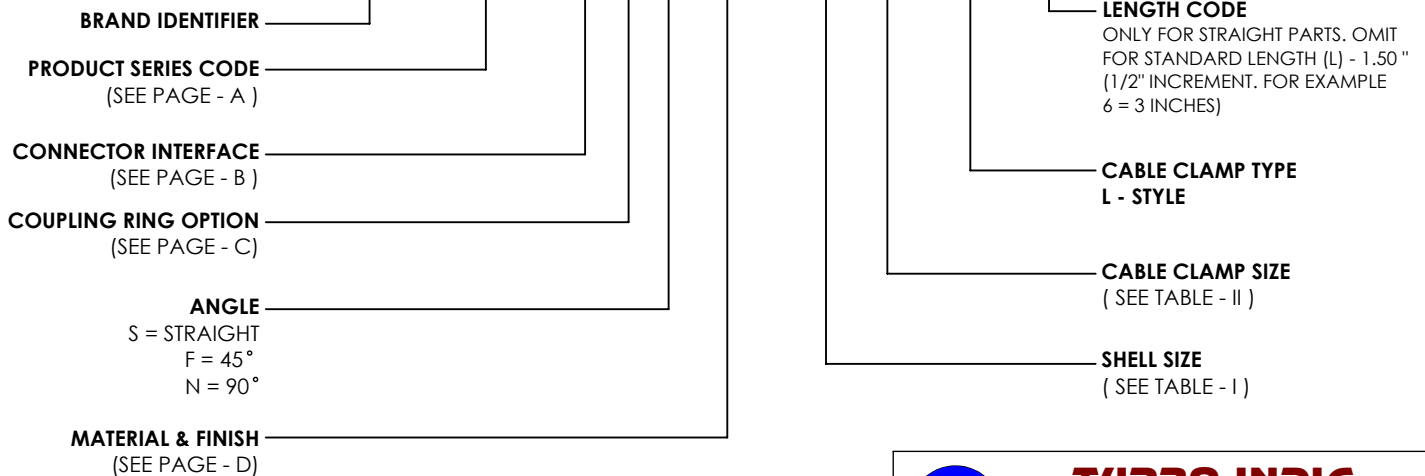

**** CUSTOMIZATION POSSIBLE**



TURBO INDIA

#114, P.C Industrial Estate Kamakshipalya, Magadi Rd. Bangalore 560 079, Karnataka, India

THIS DRAWING IS COPYRIGHT AND THE PROPERTY OF TURBO INDIA. IT MUST NOT BE COPIED, USED FOR MANUFACTURE OR OTHERWISE DISCLOSED WITHOUT PRIOR WRITTEN CONSENT OF THE COMPANY.

UNLESS OTHERWISE SPECIFIED : ALL DIMENSIONS IN MILLIMETRES GENERAL TOL: LINEAR : +/-0.10MM ANGULAR : +/- 2°

		DATE	
DRAWN :	AD	30-01-2020	
CHECKED :	AD	30-01-2020	
APPROVED :	MR	30-01-2020	
MATERIAL :	---	REVISION	
WEIGHT :	---	0	

DESCRIPTION : SUBMERSIBLE CABLE CLAMP ADAPTER - ENVIRONMENTAL , SCREENED	
PART NUMBER / SERIES: SERIES 110 -03	PAGE:NO 17

TABLE - I SHELL SIZE						
CONNECTOR DESIGNATOR		RING DIMENSION	ELBOW DIMENSIONS			
A & F	H	Ø C MAX	E MAX	F MAX	G MAX	H MAX
08	09	19.60	11.60	22.40	12.70	29.70
10	11	22.30	13.20	23.10	15.10	31.20
12	13	25.40	14.80	23.60	15.50	32.80
14	15	30.00	16.40	24.40	17.80	34.30
16	17	31.75	18.70	24.90	22.50	36.10
18	19	35.56	23.50	25.40	24.80	36.80
20	21	39.37	23.50	25.90	24.80	38.40
22	23	41.91	25.90	26.70	28.60	39.90
24	25	46.99	25.90	27.20	28.60	41.40
28		50.00	29.10	27.90	31.10	43.20
32		56.40	30.70	29.20	40.00	46.20
36		62.70	31.40	30.20	45.10	48.80

TABLE- II CABLE CLAMP SIZE				
DASH NO	Ø M MIN	Ø M MAX	K MAX	Z MAX
01	1.57	3.18	20.32	31.75
02	3.18	6.35	25.40	31.75
03	6.35	9.53	27.94	31.75
04	9.53	12.70	30.48	31.75
05	12.70	15.88	31.75	33.27
06	15.88	19.05	35.56	35.05
07	19.05	22.23	38.10	38.10
08	22.23	25.40	41.91	41.40
09	25.40	28.58	44.45	41.40
10	28.58	31.75	48.26	41.40

1. WHEN MAXIMUM CABLE ENTRY IS EXCEEDED , STYLE-2 WILL BE SUPPLIED . IN THAT CONDITION, DIMENSIONS E,F,G AND H WILL NOT APPLY.
2. FOR ANY KIND OF CUSTOMISATION ON THIS BACKSHELL, FOR TERMINATION BANDS AND OTHER ACCESSORIES REACHOUT TO US ON sales@turboindia.co.in

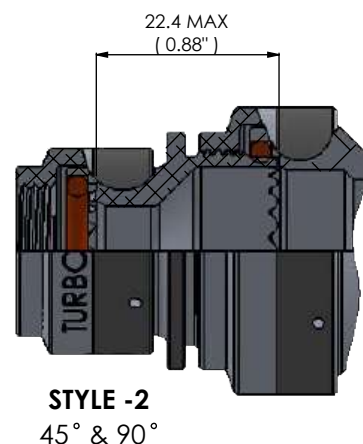
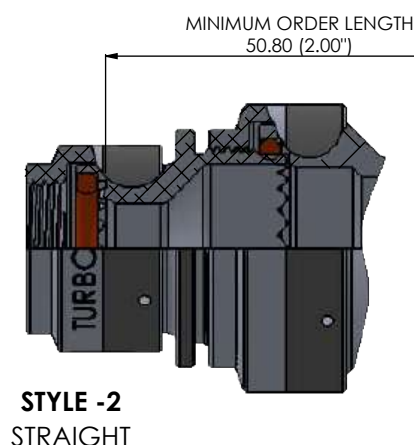

TURBO INDIA

#114, P.C Industrial Estate Kamakshipalya,
Magadi Rd. Bangalore 560 079, Karnataka, India

THIS DRAWING IS COPYRIGHT AND THE PROPERTY OF TURBO INDIA. IT MUST NOT BE COPIED, USED FOR MANUFACTURE OR OTHERWISE DISCLOSED WITHOUT PRIOR WRITTEN CONSENT OF THE COMPANY.

UNLESS OTHERWISE SPECIFIED :
ALL DIMENSIONS IN MILLIMETRES
GENERAL TOL:
LINEAR : +/-0.10MM
ANGULAR : +/-2°

	DATE
DRAWN :	AD 30-01-2020
CHECKED :	AD 30-01-2020
APPROVED :	MR 30-01-2020
MATERIAL :	---
WEIGHT :	---
REVISION	0

DESCRIPTION : SUBMERSIBLE CABLE CLAMP ADAPTER - ENVIRONMENTAL , SCREENED	
PART NUMBER / SERIES: SERIES 110-03	PAGE:NO 18

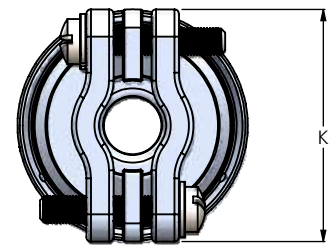
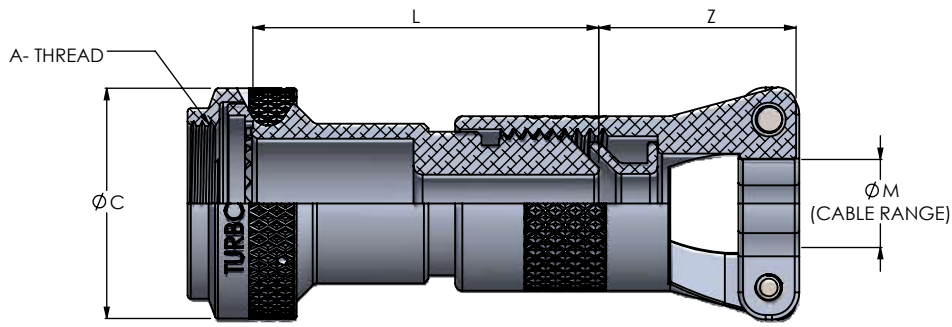

S = STRAIGHT

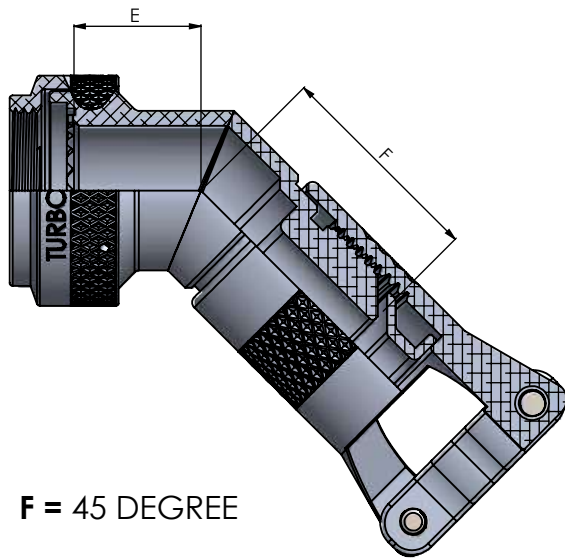

F = 45 DEGREE

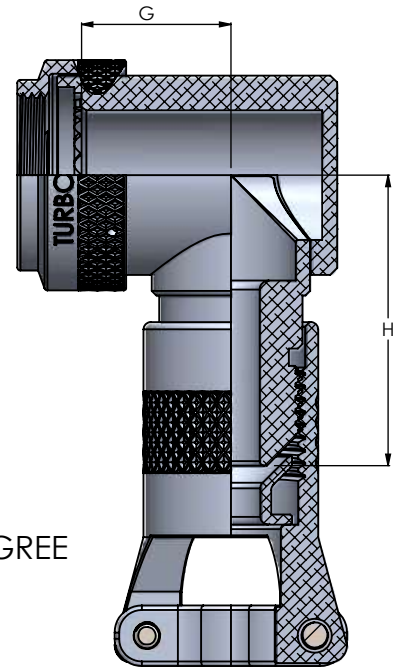

N = 90 DEGREE

ORDERING INFORMATION

TB 110-04 H 3 F VO - 13 04 - L - 6

- BRAND IDENTIFIER
- PRODUCT SERIES CODE
(SEE PAGE - A)
- CONNECTOR INTERFACE
(SEE PAGE - B)
- COUPLING RING OPTION
(SEE PAGE - C)
- ANGLE
S = STRAIGHT
F = 45°
N = 90°
- MATERIAL & FINISH
(SEE PAGE - D)

- LENGTH CODE
ONLY FOR STRAIGHT PARTS. OMIT FOR STANDARD LENGTH (L) - 1.50" (1/2" INCREMENT. FOR EXAMPLE 6 = 3 INCHES)
- CABLE CLAMP TYPE
L - STYLE
- CABLE CLAMP SIZE
(SEE TABLE - II)
- SHELL SIZE
(SEE TABLE - I)

**** CUSTOMIZATION POSSIBLE**



TURBO INDIA

#114, P.C Industrial Estate Kamakshipalya, Magadi Rd. Bangalore 560 079, Karnataka, India

THIS DRAWING IS COPYRIGHT AND THE PROPERTY OF TURBO INDIA. IT MUST NOT BE COPIED, USED FOR MANUFACTURE OR OTHERWISE DISCLOSED WITHOUT PRIOR WRITTEN CONSENT OF THE COMPANY.

UNLESS OTHERWISE SPECIFIED : ALL DIMENSIONS IN MILLIMETRES GENERAL TOL: LINEAR : +/-0.10MM ANGULAR : +/-2°

DRAWN :	AD	DATE	30-01-2020
CHECKED :	AD		30-01-2020
APPROVED :	MR		30-01-2020
MATERIAL :	---	REVISION	
WEIGHT :	---		0

DESCRIPTION : CABLE CLAMP ADAPTER - NON ENVIRONMENTAL , SCREENED	
PART NUMBER / SERIES: SERIES 110 -04	PAGE:NO 19

TABLE - I SHELL SIZE						
CONNECTOR DESIGNATOR		RING DIMENSION	ELBOW DIMENSIONS			
A & F	H	Ø C MAX	E MAX	F MAX	G MAX	H MAX
08	09	19.60	11.60	22.40	12.70	29.70
10	11	22.30	13.20	23.10	15.10	31.20
12	13	25.40	14.80	23.60	15.50	32.80
14	15	30.00	16.40	24.40	17.80	34.30
16	17	31.75	18.70	24.90	22.50	36.10
18	19	35.56	23.50	25.40	24.80	36.80
20	21	39.37	23.50	25.90	24.80	38.40
22	23	41.91	25.90	26.70	28.60	39.90
24	25	46.99	25.90	27.20	28.60	41.40
28		50.00	29.10	27.90	31.10	43.20
32		56.40	30.70	29.20	40.00	46.20
36		62.70	31.40	30.20	45.10	48.80

TABLE- II CABLE CLAMP SIZE				
DASH NO	Ø M MIN	Ø M MAX	K MAX	Z MAX
01	1.57	3.18	20.32	31.75
02	3.18	6.35	25.40	31.75
03	6.35	9.53	27.94	31.75
04	9.53	12.70	30.48	31.75
05	12.70	15.88	31.75	33.27
06	15.88	19.05	35.56	35.05
07	19.05	22.23	38.10	38.10
08	22.23	25.40	41.91	41.40
09	25.40	28.58	44.45	41.40
10	28.58	31.75	48.26	41.40

1. WHEN MAXIMUM CABLE ENTRY IS EXCEEDED , STYLE-2 WILL BE SUPPLIED . IN THAT CONDITION, DIMENSIONS E,F,G AND H WILL NOT APPLY.
2. FOR ANY KIND OF CUSTOMISATION ON THIS BACKSHELL, FOR TERMINATION BANDS AND OTHER ACCESSORIES REACHOUT TO US ON sales@turboindia.co.in

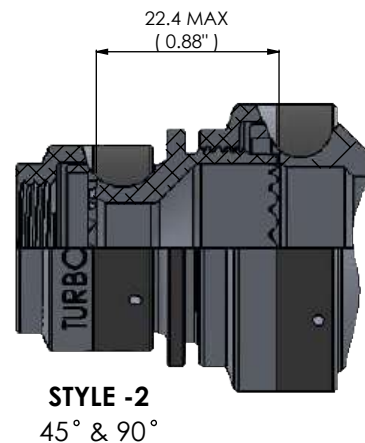
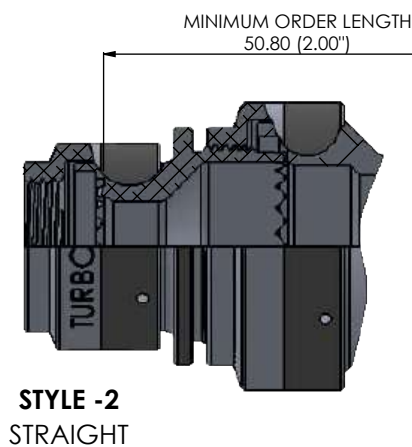

TURBO INDIA

#114, P.C Industrial Estate Kamakshipalya,
Magadi Rd. Bangalore 560 079, Karnataka, India

THIS DRAWING IS COPYRIGHT AND THE PROPERTY OF TURBO INDIA. IT MUST NOT BE COPIED, USED FOR MANUFACTURE OR OTHERWISE DISCLOSED WITHOUT PRIOR WRITTEN CONSENT OF THE COMPANY.

UNLESS OTHERWISE SPECIFIED :
ALL DIMENSIONS IN MILLIMETRES
GENERAL TOL:
LINEAR : +/-0.10MM
ANGULAR : +/-2°

	DATE
DRAWN : AD	30-01-2020
CHECKED : AD	30-01-2020
APPROVED : MR	30-01-2020
MATERIAL : ---	REVISION
WEIGHT : ---	0

DESCRIPTION :	
CABLE CLAMP ADAPTER - NON ENVIRONMENTAL , SCREENED	
PART NUMBER / SERIES:	PAGE:NO
SERIES 110-04	20

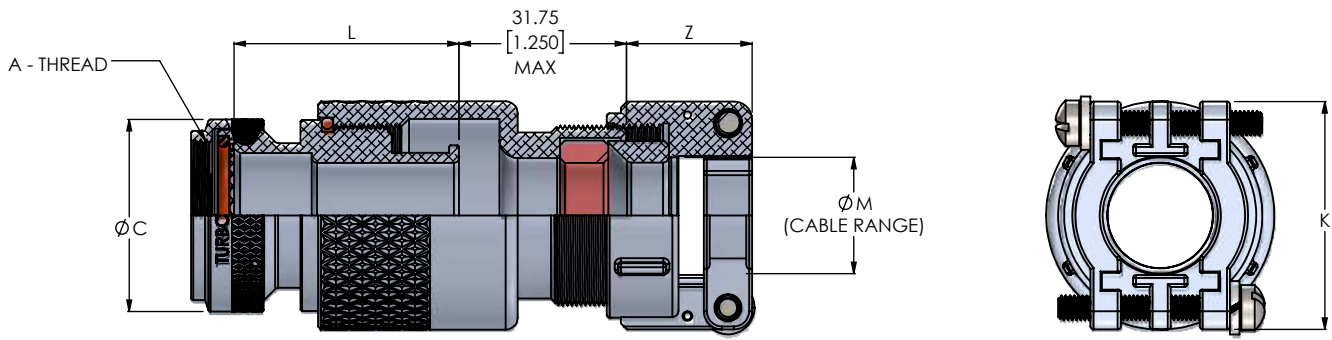

S = STRAIGHT

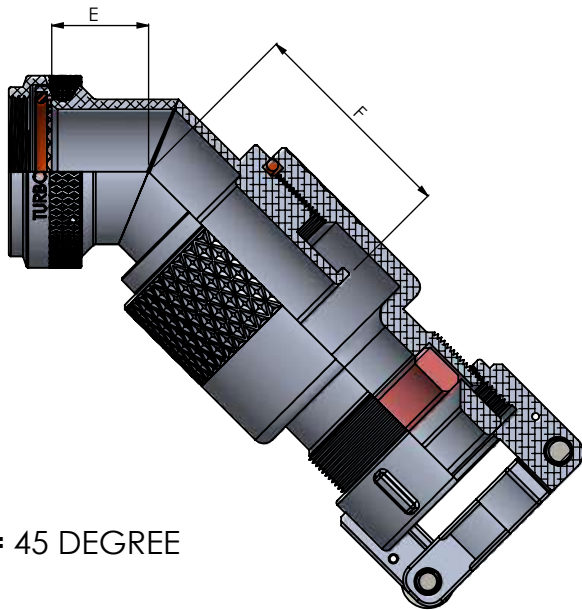

F = 45 DEGREE

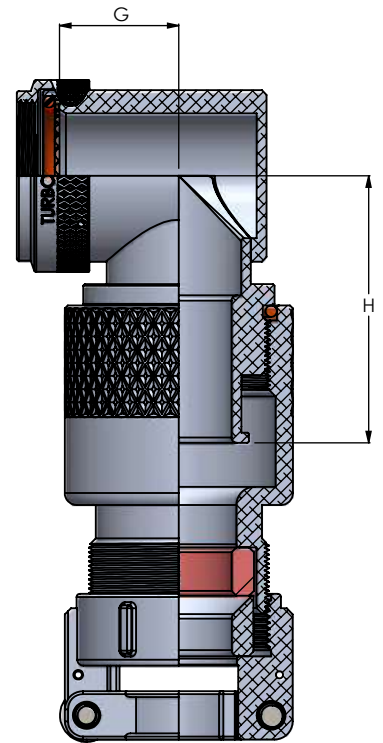

N = 90 DEGREE

ORDERING INFORMATION

TB 160-01 H 3 F VO - 17 12 - A - 6

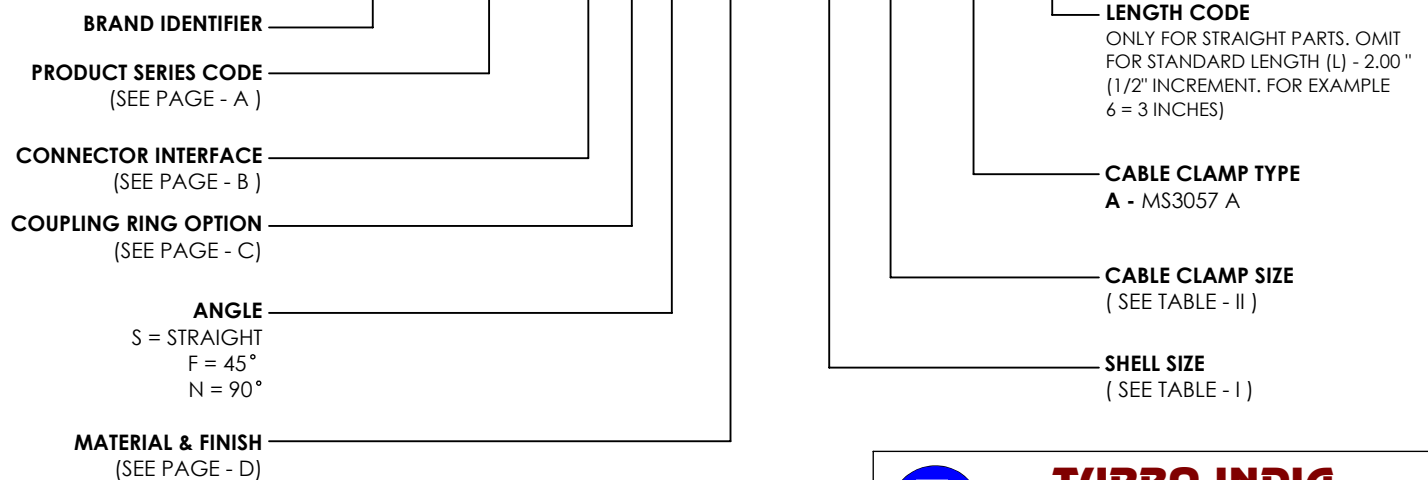

**** CUSTOMIZATION POSSIBLE**



TURBO INDIA

#114, P.C Industrial Estate Kamakshipalya, Magadi Rd. Bangalore 560 079, Karnataka, India

THIS DRAWING IS COPYRIGHT AND THE PROPERTY OF TURBO INDIA. IT MUST NOT BE COPIED, USED FOR MANUFACTURE OR OTHERWISE DISCLOSED WITHOUT PRIOR WRITTEN CONSENT OF THE COMPANY.

UNLESS OTHERWISE SPECIFIED : ALL DIMENSIONS IN MILLIMETRES GENERAL TOL: LINEAR : +/-0.10MM ANGULAR : +/- 2°

		DATE	
DRAWN :	AD	30-01-2020	
CHECKED :	AD	30-01-2020	
APPROVED :	MR	30-01-2020	
MATERIAL :	---	REVISION	
WEIGHT :	---	0	

DESCRIPTION :	
BAND - IN - A - CAN, ENVIRONMENTAL	
PART NUMBER / SERIES:	PAGE:NO
SERIES 160 -01	21

TABLE - I SHELL SIZE						
CONNECTOR DESIGNATOR		RING DIMENSION	ELBOW DIMENSIONS			
A & F	H	Ø C MAX	E MAX	F MAX	G MAX	H MAX
08	09	19.60	16.20	35.10	19.10	38.10
10	11	22.30	16.90	35.80	20.60	39.40
12	13	25.40	17.50	36.30	22.10	40.90
14	15	30.00	17.90	37.10	23.40	42.70
16	17	31.75	18.60	37.60	24.90	44.20
18	19	35.56	19.00	37.80	25.90	44.70
20	21	39.37	19.60	38.40	27.40	46.20
22	23	41.91	20.30	39.40	29.00	48.30
24	25	46.99	20.90	40.10	30.50	50.00

TABLE- II CABLE CLAMP SIZE				
DASH NO	Ø M MIN	Ø M MAX	K MAX	Z MAX
04	4.80	7.90	23.00	11.50
06	7.10	11.10	27.80	13.10
08	9.80	14.30	30.10	14.70
10	9.50	15.90	32.50	14.70
12	11.10	19.10	38.10	14.70
16	15.90	23.80	43.70	17.10
20	22.20	31.80	52.40	17.10
24	25.40	34.90	58.70	17.10

1. WHEN MAXIMUM CABLE ENTRY IS EXCEEDED , STYLE-2 WILL BE SUPPLIED . IN THAT CONDITION, DIMENSIONS E,F,G AND H WILL NOT APPLY.
2. FOR ANY KIND OF CUSTOMISATION ON THIS BACKSHELL, FOR TERMINATION BANDS AND OTHER ACCESSORIES REACHOUT TO US ON sales@turboindia.co.in

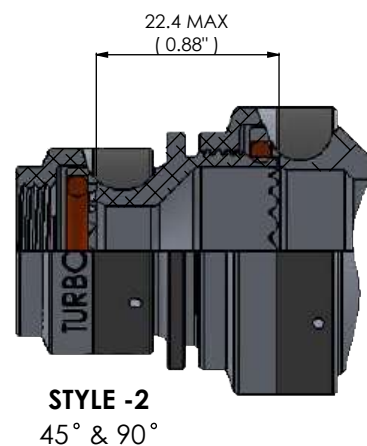
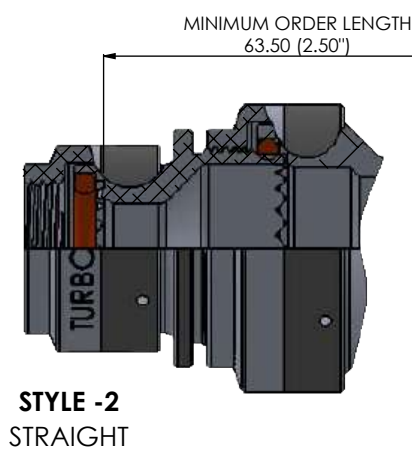

TURBO INDIA

#114, P.C Industrial Estate Kamakshipalya,
Magadi Rd. Bangalore 560 079, Karnataka, India

THIS DRAWING IS COPYRIGHT AND THE PROPERTY OF TURBO INDIA. IT MUST NOT BE COPIED, USED FOR MANUFACTURE OR OTHERWISE DISCLOSED WITHOUT PRIOR WRITTEN CONSENT OF THE COMPANY.

UNLESS OTHERWISE SPECIFIED :
ALL DIMENSIONS IN MILLIMETRES
GENERAL TOL:
LINEAR : +/-0.10MM
ANGULAR : +/- 2°

	DATE
DRAWN : AD	30-01-2020
CHECKED : AD	30-01-2020
APPROVED : MR	30-01-2020
MATERIAL : ---	REVISION
WEIGHT : ---	0

DESCRIPTION :	
BAND - IN - A - CAN, ENVIRONMENTAL	
PART NUMBER / SERIES:	PAGE:NO
SERIES 160-01	22

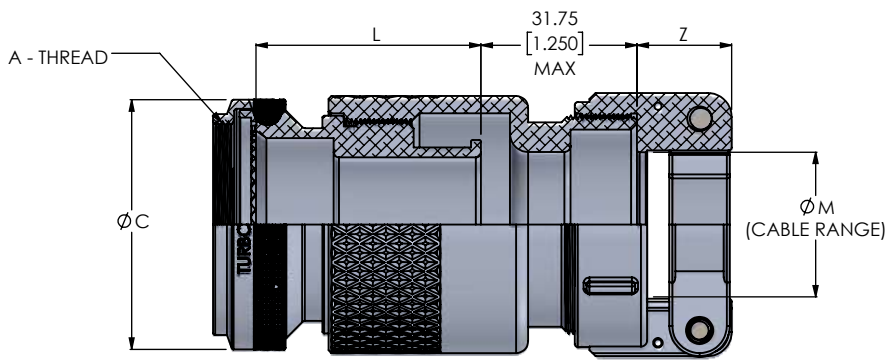

S = STRAIGHT

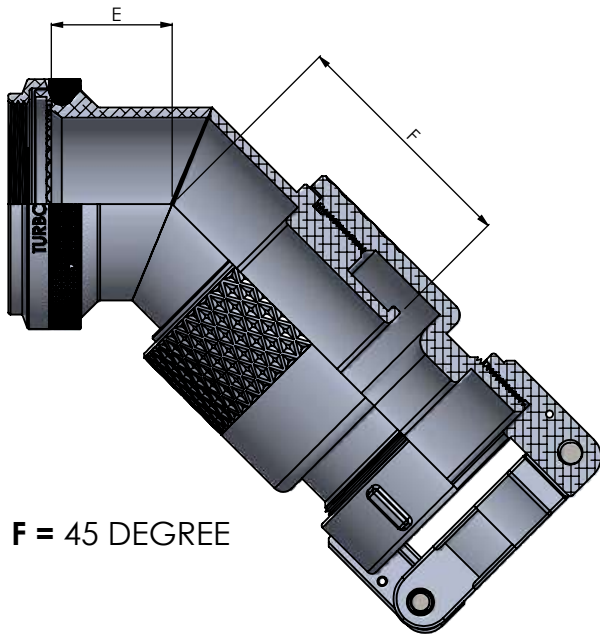

F = 45 DEGREE

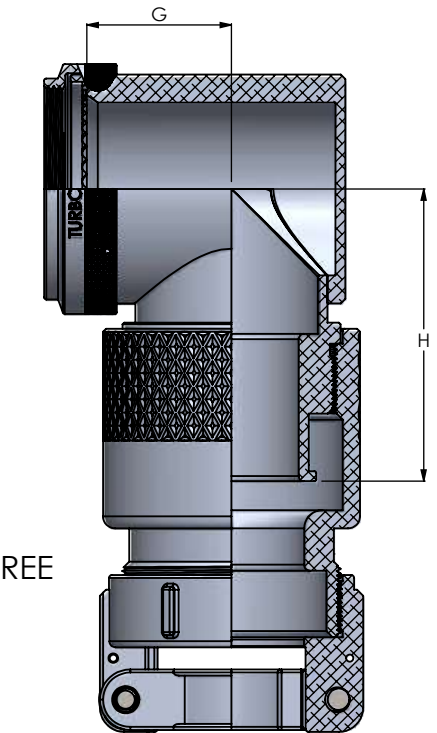

N = 90 DEGREE

ORDERING INFORMATION

TB 160-02 H 3 F VB - 23 16 - A - 6

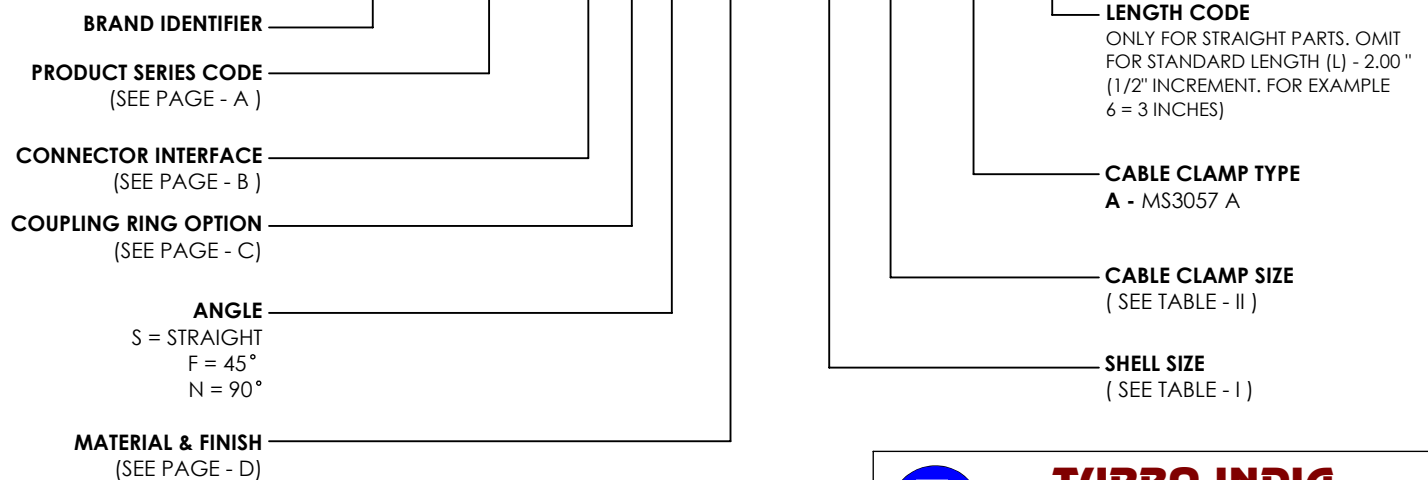

**** CUSTOMIZATION POSSIBLE**



TURBO INDIA

#114, P.C Industrial Estate Kamakshipalya, Magadi Rd. Bangalore 560 079, Karnataka, India

THIS DRAWING IS COPYRIGHT AND THE PROPERTY OF TURBO INDIA. IT MUST NOT BE COPIED, USED FOR MANUFACTURE OR OTHERWISE DISCLOSED WITHOUT PRIOR WRITTEN CONSENT OF THE COMPANY.

UNLESS OTHERWISE SPECIFIED : ALL DIMENSIONS IN MILLIMETRES GENERAL TOL: LINEAR : +/-0.10MM ANGULAR : +/- 2°

		DATE	
DRAWN :	AD	30-01-2020	
CHECKED :	AD	30-01-2020	
APPROVED :	MR	30-01-2020	
MATERIAL :	---	REVISION	
WEIGHT :	---	0	

DESCRIPTION :	
BAND - IN - A - CAN, NON - ENVIRONMENTAL	
PART NUMBER / SERIES:	PAGE:NO
SERIES 160-02	23

TABLE - I SHELL SIZE						
CONNECTOR DESIGNATOR		RING DIMENSION	ELBOW DIMENSIONS			
A & F	H	Ø C MAX	E MAX	F MAX	G MAX	H MAX
08	09	19.60	16.20	35.10	19.10	38.10
10	11	22.30	16.90	35.80	20.60	39.40
12	13	25.40	17.50	36.30	22.10	40.90
14	15	30.00	17.90	37.10	23.40	42.70
16	17	31.75	18.60	37.60	24.90	44.20
18	19	35.56	19.00	37.80	25.90	44.70
20	21	39.37	19.60	38.40	27.40	46.20
22	23	41.91	20.30	39.40	29.00	48.30
24	25	46.99	20.90	40.10	30.50	50.00

TABLE- II CABLE CLAMP SIZE				
DASH NO	Ø M MIN	Ø M MAX	K MAX	Z MAX
04	4.80	7.90	23.00	11.50
06	7.10	11.10	27.80	13.10
08	9.80	14.30	30.10	14.70
10	9.50	15.90	32.50	14.70
12	11.10	19.10	38.10	14.70
16	15.90	23.80	43.70	17.10
20	22.20	31.80	52.40	17.10
24	25.40	34.90	58.70	17.10

1. WHEN MAXIMUM CABLE ENTRY IS EXCEEDED , STYLE-2 WILL BE SUPPLIED . IN THAT CONDITION, DIMENSIONS E,F,G AND H WILL NOT APPLY.
2. FOR ANY KIND OF CUSTOMISATION ON THIS BACKSHELL, FOR TERMINATION BANDS AND OTHER ACCESSORIES REACHOUT TO US ON sales@turboindia.co.in

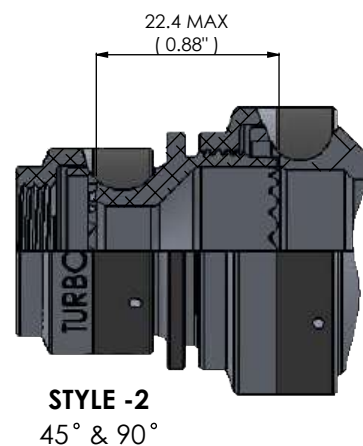
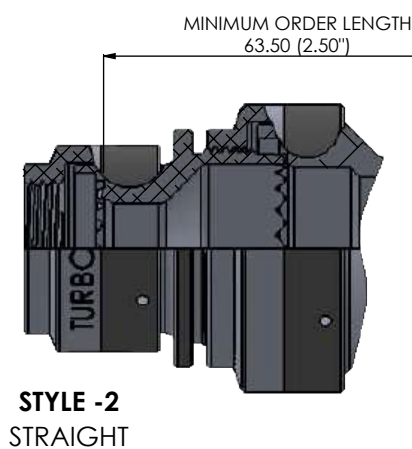

TURBO INDIA

#114, P.C Industrial Estate Kamakshipalya,
Magadi Rd. Bangalore 560 079, Karnataka, India

THIS DRAWING IS COPYRIGHT AND THE PROPERTY OF TURBO INDIA. IT MUST NOT BE COPIED, USED FOR MANUFACTURE OR OTHERWISE DISCLOSED WITHOUT PRIOR WRITTEN CONSENT OF THE COMPANY.

UNLESS OTHERWISE SPECIFIED :
ALL DIMENSIONS IN MILLIMETRES
GENERAL TOL:
LINEAR : +/-0.10MM
ANGULAR : +/- 2°

	DATE
DRAWN :	AD 30-01-2020
CHECKED :	AD 30-01-2020
APPROVED :	MR 30-01-2020
MATERIAL :	---
WEIGHT :	---
REVISION	0

DESCRIPTION :

BAND - IN - A - CAN, NON - ENVIRONMENTAL

PART NUMBER / SERIES:
SERIES 160-02

PAGE:NO
24

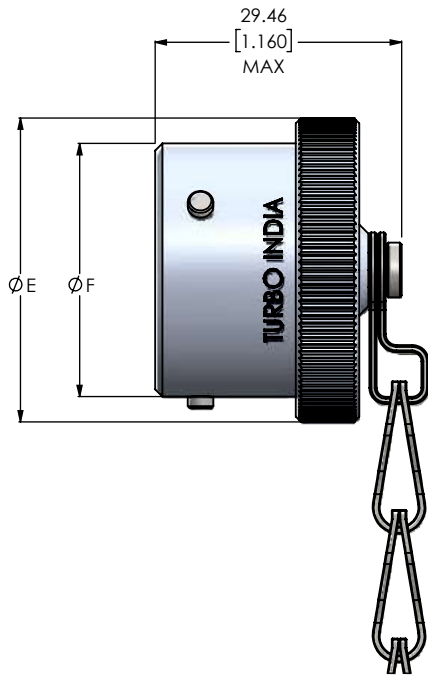

12 - PLUG COVER

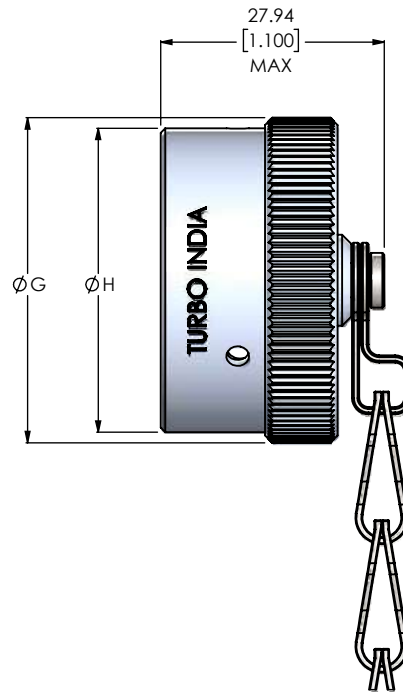

13 - RECEPTACLE COVER

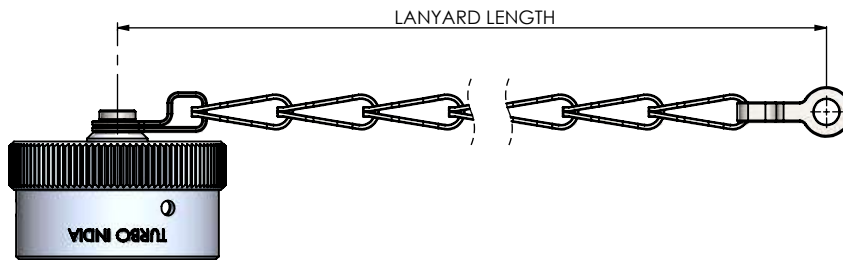

ORDERING INFORMATION

TB 12 - 19 W - Y 5 - 03

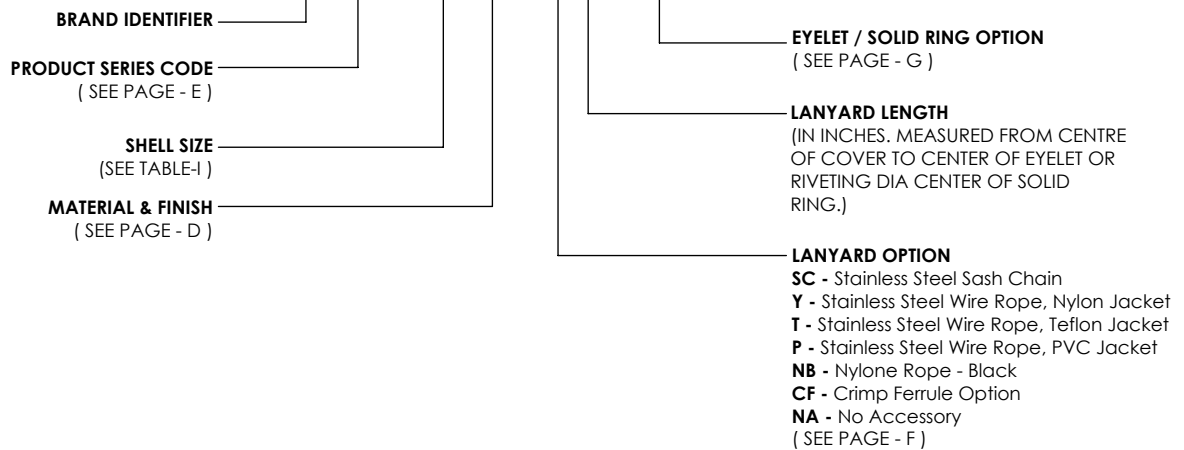

**** CUSTOMIZATION POSSIBLE**



TURBO INDIA

#114, P.C Industrial Estate Kamakshipalya,
Magadi Rd. Bangalore 560 079, Karnataka, India

THIS DRAWING IS COPYRIGHT AND THE PROPERTY OF TURBO INDIA. IT MUST NOT BE COPIED, USED FOR MANUFACTURE OR OTHERWISE DISCLOSED WITHOUT PRIOR WRITTEN CONSENT OF THE COMPANY.	UNLESS OTHERWISE SPECIFIED : ALL DIMENSIONS IN MILLIMETRES GENERAL TOL: LINEAR : +/-0.10MM ANGULAR : +/-2°	DRAWN :	AD	DATE	30-01-2020	DESCRIPTION : PROTECTIVE COVER MIL-DTL-38999 SERIES I
		CHECKED :	AD		30-01-2020	
		APPROVED :	MR		30-01-2020	
		MATERIAL :	---	REVISION	0	PART NUMBER / SERIES: SERIES 12 & 13
		WEIGHT :	---			

TABLE - I SHELL SIZE DIMENSIONS

SHELL SIZE	E MAX	F MAX	G MAX	H MAX	STANDARD LANYARD LENGTH
09	20.80 (0.820)	14.53 (0.572)	21.80 (0.860)	20.80 (0.820)	76.20 (3.00)
11	23.90 (0.940)	17.78 (0.700)	24.90 (0.980)	23.90 (0.940)	76.20 (3.00)
13	27.20 (1.075)	21.59 (0.850)	29.50 (1.160)	27.90 (1.100)	88.90 (3.50)
15	30.20 (1.190)	24.76 (0.975)	32.50 (1.280)	31.00 (1.220)	88.90 (3.50)
17	33.50 (1.320)	27.94 (1.100)	35.80 (1.410)	34.00 (1.340)	88.90 (3.50)
19	36.60 (1.440)	30.66 (1.207)	38.60 (1.520)	37.10 (1.460)	88.90 (3.50)
21	39.90 (1.570)	33.83 (1.332)	41.90 (1.650)	40.10 (1.580)	101.60 (4.00)
23	42.90 (1.690)	37.01 (1.457)	45.00 (1.770)	43.20 (1.700)	101.60 (4.00)
25	46.20 (1.820)	40.18 (1.582)	48.00 (1.890)	46.50 (1.830)	101.60 (4.00)

- DIMENSIONS IN PARENTHESIS ARE IN INCHES.
- FOR ANY KIND OF LANYARD AND OTHER ATTACHMENTS, REACHOUT TO US ON sales@turboindia.co.in



TURBO INDIA

#114, P.C Industrial Estate Kamakshipalya,
Magadi Rd. Bangalore 560 079, Karnataka, India

DATE

THIS DRAWING IS COPYRIGHT AND THE PROPERTY OF TURBO INDIA. IT MUST NOT BE COPIED, USED FOR MANUFACTURE OR OTHERWISE DISCLOSED WITHOUT PRIOR WRITTEN CONSENT OF THE COMPANY.

UNLESS OTHERWISE SPECIFIED :
ALL DIMENSIONS IN MILLIMETRES
GENERAL TOL:
LINEAR : +/-0.10MM
ANGULAR : +/- 2°

DRAWN :	AD	30-01-2020
CHECKED :	AD	30-01-2020
APPROVED :	MR	30-01-2020
MATERIAL :	---	REVISION
WEIGHT :	---	0

DESCRIPTION :

**PROTECTIVE COVER
MIL-DTL-38999 SERIES I**

PART NUMBER / SERIES:
SERIES 12 & 13

PAGE:NO
26

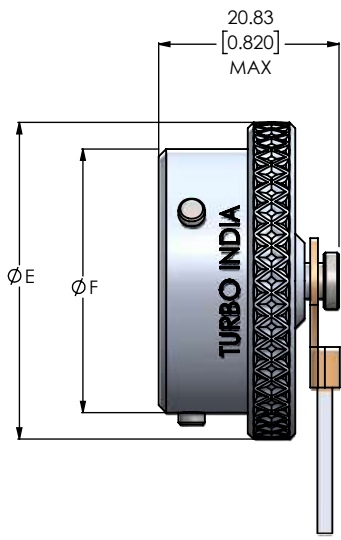

22 - PLUG COVER

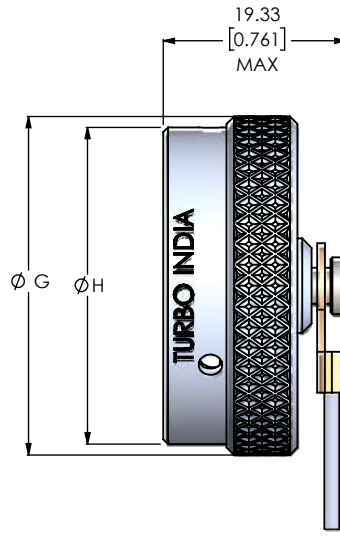

23 - RECEPTACLE COVER

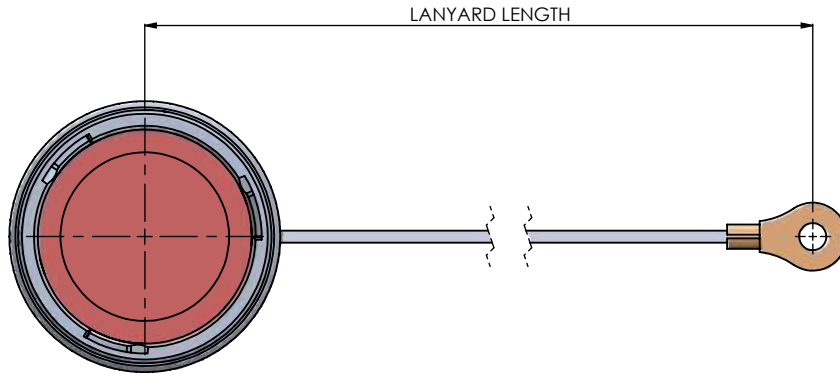

ORDERING INFORMATION

TB 23 - 18 W - Y 5 - 365B

BRAND IDENTIFIER
PRODUCT SERIES CODE
 (SEE PAGE - E)
SHELL SIZE
 (SEE TABLE-I)
MATERIAL & FINISH
 (SEE PAGE - D)

EYELET / SOLID RING OPTION
 (SEE PAGE - G)

LANYARD LENGTH
 (IN INCHES. MEASURED FROM CENTRE OF COVER TO CENTER OF EYELET OR RIVETING DIA CENTER OF SOLID RING.)

LANYARD OPTION
SC - Stainless Steel Sash Chain
Y - Stainless Steel Wire Rope, Nylon Jacket
T - Stainless Steel Wire Rope, Teflon Jacket
P - Stainless Steel Wire Rope, PVC Jacket
NB - Nylone Rope - Black
CF - Crimp Ferrule Option
NA - No Accessory
 (SEE PAGE - F)

**** CUSTOMIZATION POSSIBLE**



TURBO INDIA

#114, P.C Industrial Estate Kamakshipalya, Magadi Rd. Bangalore 560 079, Karnataka, India

THIS DRAWING IS COPYRIGHT AND THE PROPERTY OF TURBO INDIA. IT MUST NOT BE COPIED, USED FOR MANUFACTURE OR OTHERWISE DISCLOSED WITHOUT PRIOR WRITTEN CONSENT OF THE COMPANY.	UNLESS OTHERWISE SPECIFIED : ALL DIMENSIONS IN MILLIMETRES GENERAL TOL: LINEAR : +/-0.10MM ANGULAR : +/- 2°	DRAWN :	AD	DATE	30-01-2020	DESCRIPTION : PROTECTIVE COVER MIL-DTL-38999 SERIES II	PART NUMBER / SERIES: SERIES 22 & 23	PAGE:NO 27
		CHECKED :	AD		30-01-2020			
		APPROVED :	MR		30-01-2020			
		MATERIAL :	---	REVISION				
		WEIGHT :	---		0			

TABLE - I SHELL SIZE DIMENSIONS

SHELL SIZE	E MAX	F MAX	G MAX	H MAX	STANDARD LANYARD LENGTH
08	18.30 (0.720)	12.00 (0.473)	19.05 (0.750)	16.00 (0.630)	76.20 (3.00)
10	21.60 (0.850)	15.00 (0.590)	21.82 (0.859)	19.33 (0.761)	76.20 (3.00)
12	25.40 (1.000)	19.10 (0.750)	26.19 (1.031)	23.77 (0.936)	88.90 (3.50)
14	28.70 (1.130)	22.20 (0.875)	29.36 (1.156)	27.28 (1.074)	88.90 (3.50)
16	31.80 (1.250)	25.40 (1.000)	32.54 (1.281)	29.77 (1.172)	88.90 (3.50)
18	35.10 (1.380)	28.60 (1.125)	35.71 (1.406)	33.12 (1.304)	88.90 (3.50)
20	38.10 (1.500)	31.80 (1.250)	38.89 (1.531)	36.45 (1.435)	101.60 (4.00)
22	41.40 (1.630)	34.90 (1.375)	41.68 (1.640)	39.62 (1.560)	101.60 (4.00)
24	44.50 (1.750)	38.10 (1.500)	44.86 (1.766)	42.88 (1.688)	101.60 (4.00)

1. DIMENSIONS IN PARENTHESIS ARE IN INCHES.
2. FOR ANY KIND OF LANYARD AND OTHER ATTACHMENTS, REACHOUT TO US ON sales@turboindia.co.in



TURBO INDIA

#114, P.C Industrial Estate Kamakshipalya,
Magadi Rd. Bangalore 560 079, Karnataka, India

DATE

THIS DRAWING IS COPYRIGHT AND THE PROPERTY OF TURBO INDIA. IT MUST NOT BE COPIED, USED FOR MANUFACTURE OR OTHERWISE DISCLOSED WITHOUT PRIOR WRITTEN CONSENT OF THE COMPANY.

UNLESS OTHERWISE SPECIFIED :
ALL DIMENSIONS IN MILLIMETRES
GENERAL TOL:
LINEAR : +/-0.10MM
ANGULAR : +/- 2 °

DRAWN :	AD	30-01-2020
CHECKED :	AD	30-01-2020
APPROVED :	MR	30-01-2020
MATERIAL :	---	REVISION
WEIGHT :	---	0

DESCRIPTION :	
PROTECTIVE COVER MIL-DTL-38999 SERIES II	
PART NUMBER / SERIES:	PAGE:NO
SERIES 22 & 23	28

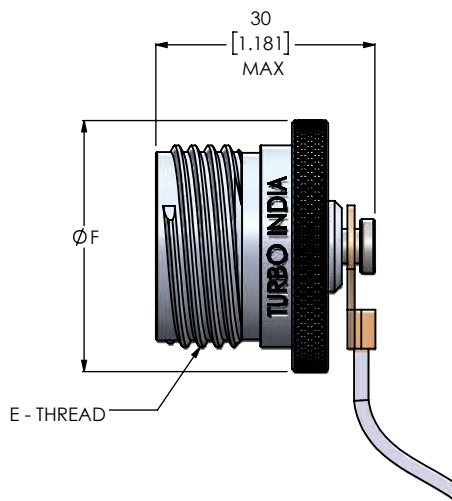

32 - PLUG COVER

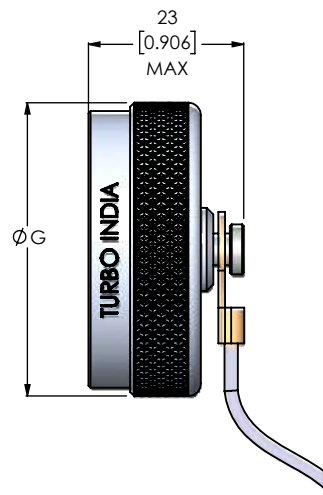

33 - RECEPTACLE COVER

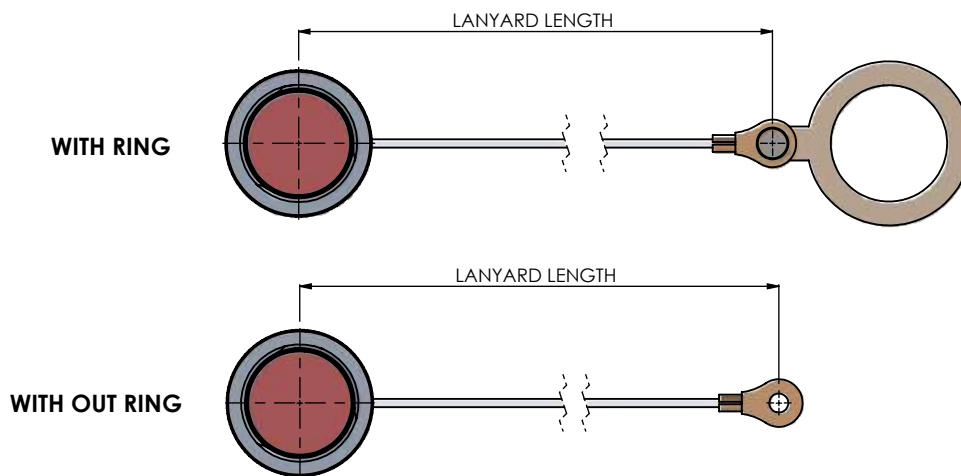

ORDERING INFORMATION

TB 33 - 19 W - Y 5 - 03

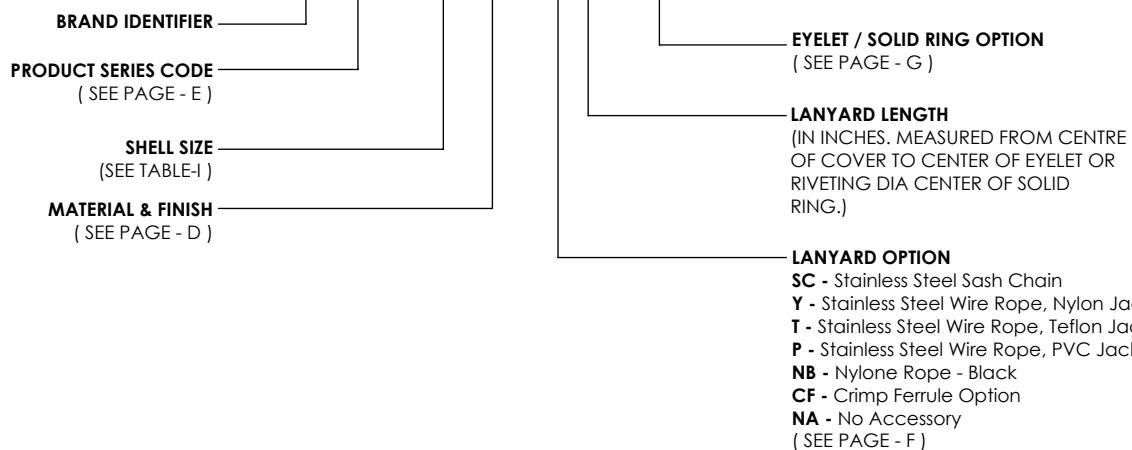

**** CUSTOMIZATION POSSIBLE**



TURBO INDIA

#114, P.C Industrial Estate Kamakshipalya,
Magadi Rd. Bangalore 560 079, Karnataka, India

THIS DRAWING IS COPYRIGHT AND THE PROPERTY OF TURBO INDIA. IT MUST NOT BE COPIED, USED FOR MANUFACTURE OR OTHERWISE DISCLOSED WITHOUT PRIOR WRITTEN CONSENT OF THE COMPANY.	UNLESS OTHERWISE SPECIFIED : ALL DIMENSIONS IN MILLIMETRES GENERAL TOL: LINEAR : +/-0.10MM ANGULAR : +/- 2°	DRAWN :	AD	DATE	30-01-2020	DESCRIPTION : PROTECTIVE COVER MIL-DTL-38999 SERIES III	PART NUMBER / SERIES: SERIES 32 & 33	PAGE:NO 29
		CHECKED :	AD	30-01-2020				
		APPROVED :	MR	30-01-2020				
		MATERIAL :	---	REVISION	0			
		WEIGHT :	---					

TABLE - I SHELL SIZE DIMENSIONS

SHELL SIZE	E -THREAD	F MAX	G MAX	STANDARD LANYARD LENGTH
09	0.6250-0.1P-0.3L-TS	23.0 (0.906)	23.0 (0.906)	127 (5.0)
11	0.7500-0.1P-0.3L-TS	26.0 (1.024)	28.0 (1.102)	127 (5.0)
13	0.8750-0.1P-0.3L-TS	31.0 (1.220)	31.0 (1.220)	127 (5.0)
15	1.0000-0.1P-0.3L-TS	33.0 (1.300)	32.0 (1.260)	127 (5.0)
17	1.1875-0.1P-0.3L-TS	37.0 (1.457)	37.0 (1.457)	127 (5.0)
19	1.2500-0.1P-0.3L-TS	40.0 (1.575)	39.0 (1.535)	127 (5.0)
21	1.3750-0.1P-0.3L-TS	44.0 (1.732)	42.0 (1.654)	127 (5.0)
23	1.5000-0.1P-0.3L-TS	46.0 (1.811)	45.0 (1.772)	127 (5.0)
25	1.6250-0.1P-0.3L-TS	50.0 (1.969)	49.0 (1.929)	127 (5.0)

1. THREAD DIMENSIONS & DIMENSIONS IN PARENTHESIS ARE IN INCHES.
2. THREAD DIMENSION COMMON FOR PLUG & RECEPTACLE.
3. FOR ANY KIND OF LANYARD AND OTHER ATTACHMENTS, REACHOUT TO US ON sales@turboindia.co.in



TURBO INDIA

#114, P.C Industrial Estate Kamakshipalya,
Magadi Rd. Bangalore 560 079, Karnataka, India

DATE

THIS DRAWING IS COPYRIGHT AND THE PROPERTY OF TURBO INDIA. IT MUST NOT BE COPIED, USED FOR MANUFACTURE OR OTHERWISE DISCLOSED WITHOUT PRIOR WRITTEN CONSENT OF THE COMPANY.

UNLESS OTHERWISE SPECIFIED :
ALL DIMENSIONS IN MILLIMETRES
GENERAL TOL:
LINEAR : +/-0.10MM
ANGULAR : +/- 2 °

DRAWN :	AD	30-01-2020
CHECKED :	AD	30-01-2020
APPROVED :	MR	30-01-2020
MATERIAL :	---	REVISION
WEIGHT :	---	0

DESCRIPTION :

**PROTECTIVE COVER
MIL-DTL-38999 SERIES III**

PART NUMBER / SERIES:
SERIES 32 & 33

PAGE:NO
30

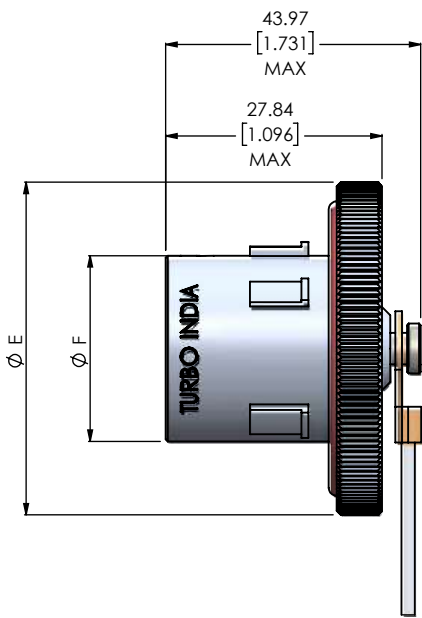

42 - PLUG COVER

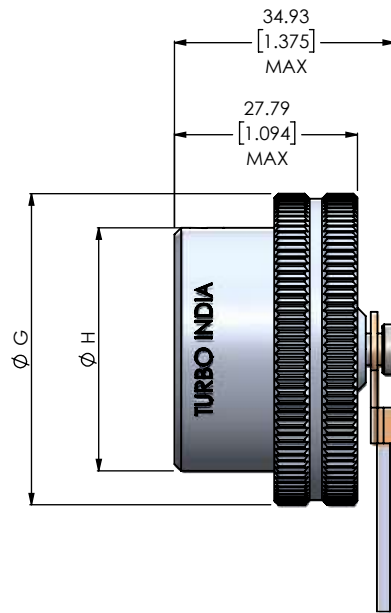

43 - RECEPTACLE COVER

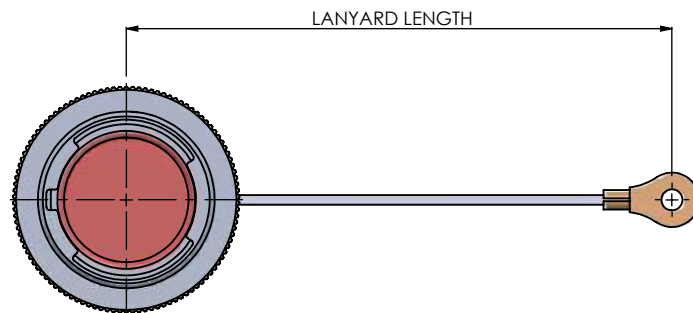

ORDERING INFORMATION

TB 43 - 17 W - Y 5 - 365B

BRAND IDENTIFIER
 PRODUCT SERIES CODE
 (SEE PAGE - E)
 SHELL SIZE
 (SEE TABLE-I)
 MATERIAL & FINISH
 (SEE PAGE - D)

EYELET / SOLID RING OPTION
 (SEE PAGE - G)

LANYARD LENGTH
 (IN INCHES. MEASURED FROM CENTRE OF COVER TO CENTER OF EYELET OR RIVETING DIA CENTER OF SOLID RING.)

LANYARD OPTION
 SC - Stainless Steel Sash Chain
 Y - Stainless Steel Wire Rope, Nylon Jacket
 T - Stainless Steel Wire Rope, Teflon Jacket
 P - Stainless Steel Wire Rope, PVC Jacket
 NB - Nylon Rope - Black
 CF - Crimp Ferrule Option
 NA - No Accessory
 (SEE PAGE - F)

** CUSTOMIZATION POSSIBLE

TURBO INDIA
 #114, P.C Industrial Estate Kamakshipalya,
 Magadi Rd. Bangalore 560 079, Karnataka, India

THIS DRAWING IS COPYRIGHT AND THE PROPERTY OF TURBO INDIA. IT MUST NOT BE COPIED, USED FOR MANUFACTURE OR OTHERWISE DISCLOSED WITHOUT PRIOR WRITTEN CONSENT OF THE COMPANY.	UNLESS OTHERWISE SPECIFIED : ALL DIMENSIONS IN MILLIMETRES GENERAL TOL: LINEAR : +/-0.10MM ANGULAR : +/- 2°	DRAWN :	AD	DATE	30-01-2020	DESCRIPTION : PROTECTIVE COVER MIL-DTL-38999 SERIES IV	PART NUMBER / SERIES: SERIES 42 & 43	PAGE:NO 31
		CHECKED :	AD		30-01-2020			
		APPROVED :	MR		30-01-2020			
		MATERIAL :	---	REVISION	0			
		WEIGHT :	---					

TABLE - I SHELL SIZE DIMENSIONS

SHELL SIZE	E MAX	F MAX	G MAX	H MAX	STANDARD LANYARD LENGTH
11	35.05 (1.380)	12.92 (0.509)	26.59 (1.047)	19.18 (0.775)	127.00 (5.00)
13	39.88 (1.570)	16.10 (0.634)	30.99 (1.220)	22.86 (0.900)	127.00 (5.00)
15	42.17 (1.660)	19.28 (0.759)	34.19 (1.346)	26.42 (1.040)	127.00 (5.00)
17	49.47 (1.790)	22.48 (0.885)	37.39 (1.472)	29.21 (1.150)	127.00 (5.00)
19	48.77 (1.920)	25.63 (1.009)	40.21 (1.583)	32.39 (1.275)	127.00 (5.00)
21	52.33 (2.060)	28.80 (1.134)	43.31 (1.705)	35.56 (1.400)	127.00 (5.00)
23	57.15 (2.250)	31.98 (1.259)	46.50 (1.831)	38.74 (1.525)	127.00 (5.00)
25	60.45 (2.380)	35.15 (1.384)	49.71 (1.957)	41.91 (1.650)	127.00 (5.00)

1. DIMENSIONS IN PARENTHESIS ARE IN INCHES.
2. FOR ANY KIND OF LANYARD AND OTHER ATTACHMENTS, REACHOUT TO US ON sales@turboindia.co.in



TURBO INDIA

#114, P.C Industrial Estate Kamakshipalya,
Magadi Rd. Bangalore 560 079, Karnataka, India

DATE

THIS DRAWING IS COPYRIGHT AND THE PROPERTY OF TURBO INDIA. IT MUST NOT BE COPIED, USED FOR MANUFACTURE OR OTHERWISE DISCLOSED WITHOUT PRIOR WRITTEN CONSENT OF THE COMPANY.

UNLESS OTHERWISE SPECIFIED :
ALL DIMENSIONS IN MILLIMETRES
GENERAL TOL:
LINEAR : +/-0.10MM
ANGULAR : +/- 2 °

DRAWN :	AD	30-01-2020
CHECKED :	AD	30-01-2020
APPROVED :	MR	30-01-2020
MATERIAL :	---	REVISION
WEIGHT :	---	0

DESCRIPTION :

**PROTECTIVE COVER
MIL-DTL-38999 SERIES IV**

PART NUMBER / SERIES:
SERIES 42 & 43

PAGE:NO
32

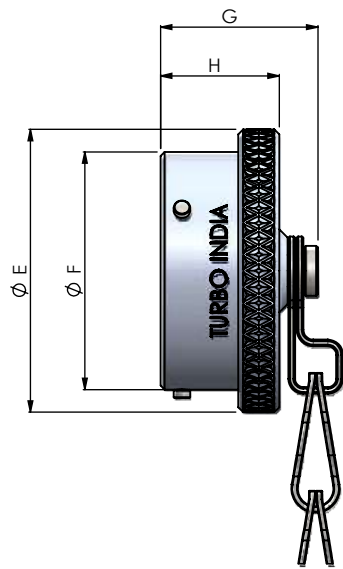

52 - PLUG COVER

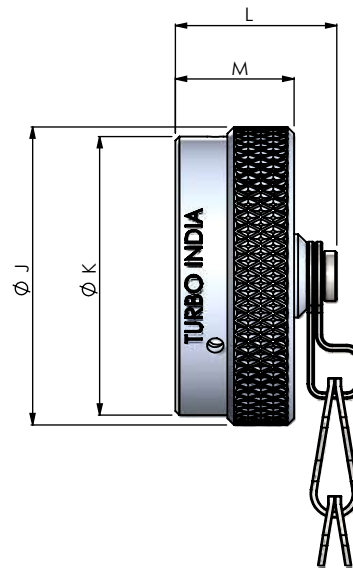

53 - RECEPTACLE COVER

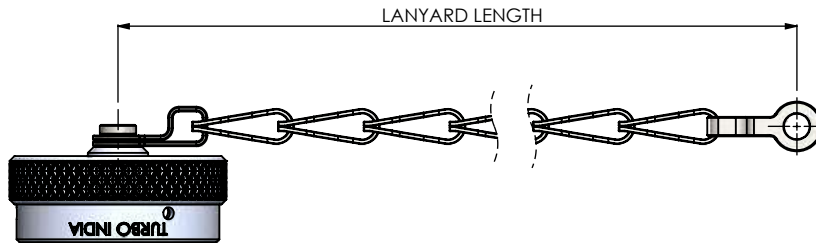

ORDERING INFORMATION

TB 52 - 18 W - SC 3.5 - 03

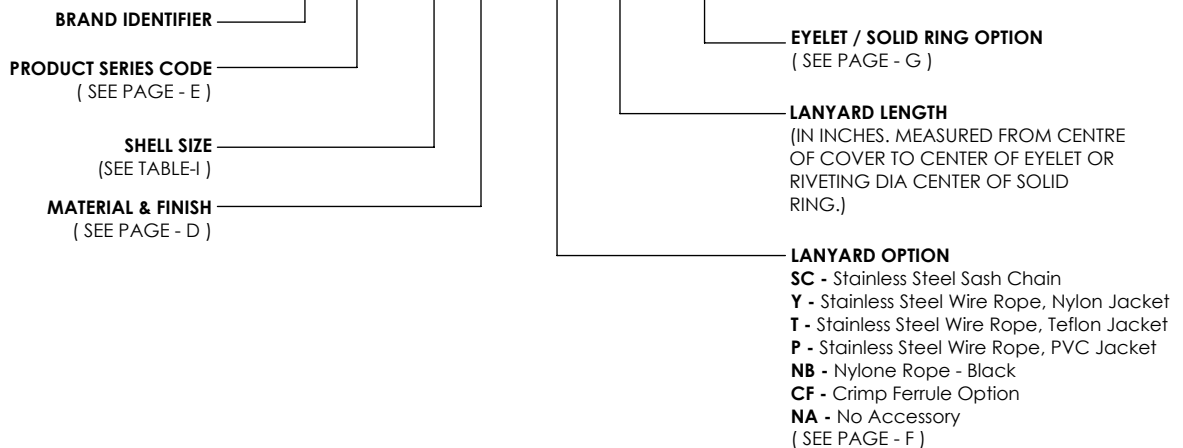

** CUSTOMIZATION POSSIBLE



TURBO INDIA

#114, P.C Industrial Estate Kamakshipalya,
Magadi Rd. Bangalore 560 079, Karnataka, India

THIS DRAWING IS COPYRIGHT AND THE PROPERTY OF TURBO INDIA. IT MUST NOT BE COPIED, USED FOR MANUFACTURE OR OTHERWISE DISCLOSED WITHOUT PRIOR WRITTEN CONSENT OF THE COMPANY.	UNLESS OTHERWISE SPECIFIED : ALL DIMENSIONS IN MILLIMETRES GENERAL TOL: LINEAR : +/-0.10MM ANGULAR : +/- 2°	DRAWN :	AD	DATE	30-01-2020	DESCRIPTION : PROTECTIVE COVER MIL-DTL-26482 SERIES I & II	PART NUMBER / SERIES: SERIES 52 & 53	PAGE:NO 33
		CHECKED :	AD	30-01-2020				
		APPROVED :	MR	30-01-2020				
		MATERIAL :	---	REVISION	0			
		WEIGHT :	---					

TABLE - I SHELL SIZE DIMENSIONS

SHELL SIZE	Ø E MAX	Ø F MAX	G MAX	H MAX	Ø J MAX	Ø K MAX	L MAX	M MAX	STANDARD LANYARD LENGTH
08	18.26 (0.719)	12.01 (0.473)	19.84 (0.781)	14.27 (0.562)	18.64 (0.734)	16.14 (0.635)	21.44 (0.844)	14.27 (0.562)	76.20 (3.00)
10	21.44 (0.844)	14.99 (0.590)	19.84 (0.781)	14.27 (0.562)	21.82 (0.859)	19.32 (0.761)	21.44 (0.844)	14.27 (0.562)	76.20 (3.00)
12	25.40 (1.000)	19.05 (0.750)	19.84 (0.781)	14.27 (0.562)	25.40 (1.000)	22.90 (0.902)	21.44 (0.844)	14.27 (0.562)	88.90 (3.50)
14	28.58 (1.125)	22.22 (0.875)	19.84 (0.781)	14.27 (0.562)	28.58 (1.125)	26.08 (1.027)	21.44 (0.844)	14.27 (0.562)	88.90 (3.50)
16	31.75 (1.250)	25.40 (1.000)	19.84 (0.781)	14.27 (0.562)	31.75 (1.250)	29.25 (1.152)	21.44 (0.844)	14.27 (0.562)	88.90 (3.50)
18	34.92 (1.375)	28.58 (1.125)	19.84 (0.781)	14.27 (0.562)	34.92 (1.375)	32.42 (1.276)	21.44 (0.844)	14.27 (0.562)	88.90 (3.50)
20	38.10 (1.500)	31.75 (1.250)	21.44 (0.844)	15.88 (0.625)	38.10 (1.500)	35.60 (1.402)	21.44 (0.844)	14.27 (0.562)	101.60 (4.00)
22	41.28 (1.625)	34.92 (1.375)	21.44 (0.844)	15.88 (0.625)	41.28 (1.625)	38.78 (1.527)	21.44 (0.844)	14.27 (0.562)	101.60 (4.00)
24	44.45 (1.750)	38.10 (1.500)	22.22 (0.875)	16.71 (0.658)	44.45 (1.750)	41.95 (1.652)	22.22 (0.875)	15.29 (0.602)	101.60 (4.00)

- DIMENSIONS IN PARENTHESIS ARE IN INCHES.
- FOR ANY KIND OF LANYARD AND OTHER ATTACHMENTS, REACHOUT TO US ON sales@turboindia.co.in



TURBO INDIA

#114, P.C Industrial Estate Kamakshipalya,
Magadi Rd. Bangalore 560 079, Karnataka, India

DATE

THIS DRAWING IS COPYRIGHT AND THE PROPERTY OF TURBO INDIA. IT MUST NOT BE COPIED, USED FOR MANUFACTURE OR OTHERWISE DISCLOSED WITHOUT PRIOR WRITTEN CONSENT OF THE COMPANY.

UNLESS OTHERWISE SPECIFIED :
ALL DIMENSIONS IN MILLIMETRES
GENERAL TOL:
LINEAR : +/-0.10MM
ANGULAR : +/- 2°

DRAWN :	AD	30-01-2020
CHECKED :	AD	30-01-2020
APPROVED :	MR	30-01-2020
MATERIAL :	---	REVISION
WEIGHT :	---	0

DESCRIPTION :

**PROTECTIVE COVER
MIL-DTL-26482 SERIES I & II**

PART NUMBER / SERIES:
SERIES 52 & 53

PAGE:NO
34

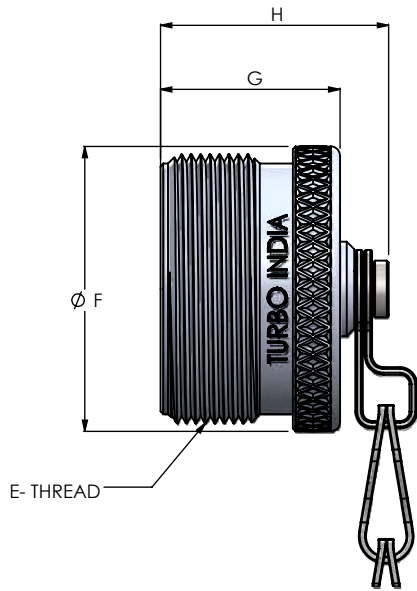

62 - PLUG COVER

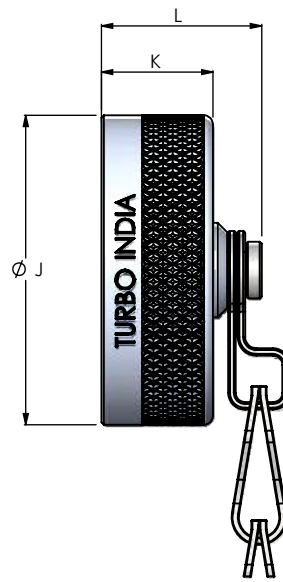

63 - RECEPTACLE COVER

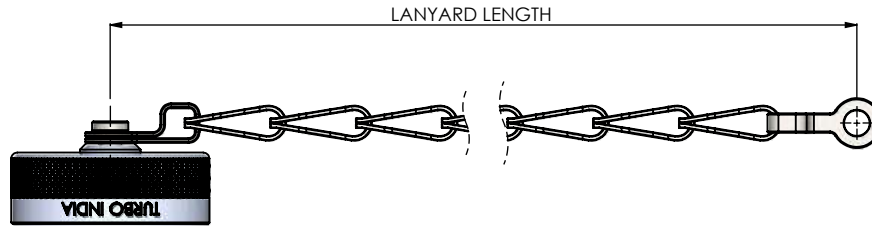

ORDERING INFORMATION

TB 63 - 18 W - Y 4.5 - 03

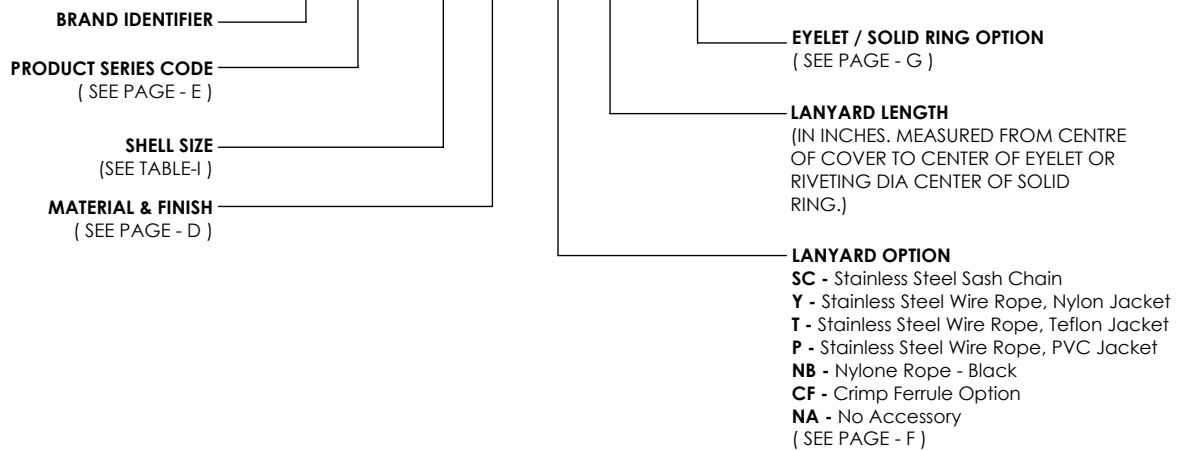

**** CUSTOMIZATION POSSIBLE**



TURBO INDIA

#114, P.C Industrial Estate Kamakshipalya, Magadi Rd. Bangalore 560 079, Karnataka, India

THIS DRAWING IS COPYRIGHT AND THE PROPERTY OF TURBO INDIA. IT MUST NOT BE COPIED, USED FOR MANUFACTURE OR OTHERWISE DISCLOSED WITHOUT PRIOR WRITTEN CONSENT OF THE COMPANY.	UNLESS OTHERWISE SPECIFIED : ALL DIMENSIONS IN MILLIMETRES GENERAL TOL: LINEAR : +/-0.10MM ANGULAR : +/- 2°	DRAWN :	AD	DATE	30-01-2020	DESCRIPTION : PROTECTIVE COVER AS50151 - CRIMP	PART NUMBER / SERIES: SERIES 62 & 63	PAGE:NO 35
		CHECKED :	AD	30-01-2020				
		APPROVED :	MR	30-01-2020				
		MATERIAL :	---	REVISION	0			
		WEIGHT :	---					

TABLE - I SHELL SIZE DIMENSIONS

SHELL SIZE	E -THREAD	F MAX	G MAX	H MAX	J MAX	K MAX	L MAX	STANDARD LANYARD LENGTH
08	1/2 - 28 UNEF	14.30 (0.562)	16.70 (0.656)	24.61 (0.969)	17.50 (0.688)	11.80 (0.465)	19.05 (0.750)	101.60 (4.00)
10	5/8 - 24 UNEF	17.40 (0.687)	16.70 (0.656)	24.61 (0.969)	20.70 (0.815)	11.80 (0.465)	19.05 (0.750)	101.60 (4.00)
12	3/4 - 20 UNEF	20.60 (0.812)	21.40 (0.844)	29.36 (1.156)	25.40 (1.000)	11.80 (0.465)	19.05 (0.750)	114.30 (4.50)
14	7/8 - 20 UNEF	23.80 (0.937)	21.40 (0.844)	29.36 (1.156)	28.60 (1.125)	11.80 (0.465)	19.05 (0.750)	114.30 (4.50)
16	1 - 20 UNEF	27.00 (1.062)	21.40 (0.844)	29.36 (1.156)	30.20 (1.188)	11.80 (0.465)	19.05 (0.750)	114.30 (4.50)
18	1 1/8 - 18 UNEF	30.10 (1.187)	21.40 (0.844)	29.36 (1.156)	34.10 (1.344)	11.80 (0.465)	19.05 (0.750)	114.30 (4.50)
20	1 1/4 - 18 UNEF	33.30 (1.312)	21.40 (0.844)	29.36 (1.156)	37.30 (1.469)	11.80 (0.465)	19.05 (0.750)	127.00 (5.00)
22	1 3/8 - 18 UNEF	36.50 (1.437)	21.40 (0.844)	29.36 (1.156)	40.50 (1.594)	11.80 (0.465)	19.05 (0.750)	127.00 (5.00)
24	1 1/2 - 18 UNEF	39.70 (1.562)	21.40 (0.844)	29.36 (1.156)	43.70 (1.719)	11.80 (0.465)	19.05 (0.750)	139.70 (5.50)
28	1 3/4 - 18 UNS	46.00 (1.812)	21.40 (0.844)	29.36 (1.156)	50.00 (1.969)	13.50 (0.531)	20.62 (0.812)	196.85 (7.75)
32	2 - 18 UNS	52.40 (2.062)	21.40 (0.844)	29.36 (1.156)	56.40 (2.219)	13.50 (0.531)	20.62 (0.812)	196.85 (7.75)
36	2 1/4 - 16 UN	58.70 (2.312)	21.40 (0.844)	29.36 (1.156)	62.70 (2.469)	13.50 (0.531)	20.62 (0.812)	196.85 (7.75)
40	2 1/2 - 16 UN	65.10 (2.562)	21.40 (0.844)	29.36 (1.156)	69.10 (2.719)	13.50 (0.531)	20.62 (0.812)	196.85 (7.75)
44	2 3/4 - 16 UN	71.40 (2.812)	21.40 (0.844)	29.36 (1.156)	75.40 (2.969)	13.50 (0.531)	20.62 (0.812)	196.85 (7.75)
48	3 - 16 UN	77.80 (3.062)	21.40 (0.844)	29.36 (1.156)	81.00 (3.188)	13.50 (0.531)	20.62 (0.812)	196.85 (7.75)

1. THREAD DIMENSIONS & DIMENSIONS IN PARENTHESIS ARE IN INCHES.
2. THREAD DIMENSION COMMON FOR PLUG & RECEPTACLE.
3. FOR ANY KIND OF LANYARD AND OTHER ATTACHMENTS, REACHOUT TO US ON sales@turboindia.co.in

	TURBO INDIA #114, P.C Industrial Estate Kamakshipalya, Magadi Rd. Bangalore 560 079, Karnataka, India
--	--

THIS DRAWING IS COPYRIGHT AND THE PROPERTY OF TURBO INDIA. IT MUST NOT BE COPIED, USED FOR MANUFACTURE OR OTHERWISE DISCLOSED WITHOUT PRIOR WRITTEN CONSENT OF THE COMPANY.	UNLESS OTHERWISE SPECIFIED : ALL DIMENSIONS IN MILLIMETRES GENERAL TOL: LINEAR : +/-0.10MM ANGULAR : +/- 2°	DRAWN :	AD	DATE	30-01-2020	DESCRIPTION : PROTECTIVE COVER AS50151 - CRIMP	PART NUMBER / SERIES: SERIES 62 & 63	PAGE:NO 36
		CHECKED :	AD		30-01-2020			
		APPROVED :	MR		30-01-2020			
		MATERIAL :	---	REVISION		0		
		WEIGHT :	---					



Contact Us

sales@turboindia.co.in

📍 No: 114, PC Industrial Estate
Bangalore - 560079.
Karnataka, India.

☎ +91 - 80 - 23483447

🌐 www.turboindia-ics.com

Scan For website

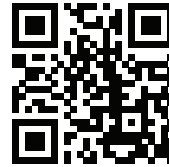

TURBO INDIA
“ YOUR PARTNER FOR ALL
INTERCONNECTION NEEDS ”